

NOTES

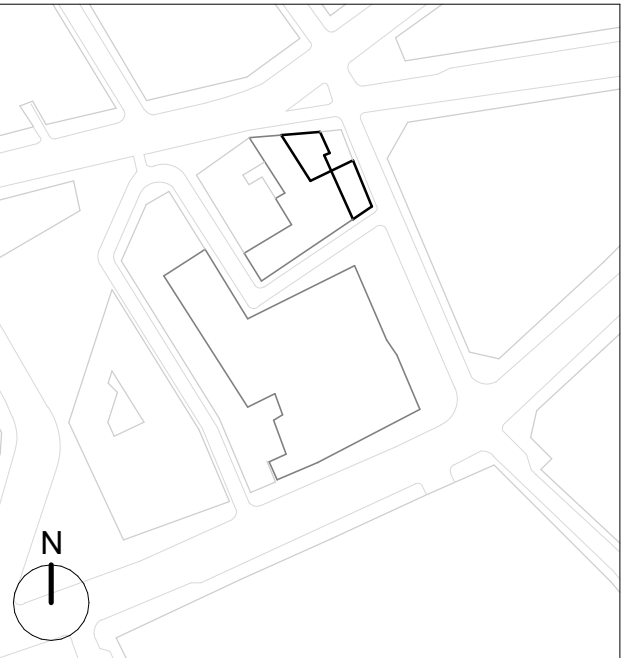

GENERAL NOTES:
Existing drawings are for reference only - not for approval.

- KEY:**
- Application Boundary
 - Extent of Walls Demolition
 - Extent of Demolition
 - Extent of Existing Strip-out
 - Modern fixtures and fittings are to be removed
 - Modern floor finishes as part of strip-out, however existing slab structure to be retained except where noted.
 - Historic details to be retained
 - Extent of Existing Strip-Out
 - Extent of demolition/strip-out is unclear; further site investigations are required
 - Existing structure removed and replaced
 - Existing structure to be retained and repaired subject to further investigations
 - Existing structural opening closed
 - Existing window/door frame removed and replaced
 - Existing windows to be deglazed, repaired and fitted with vacuum glazing; glazing bars to be added to match 33 New Oxford Street
 - Existing windows to be deglazed, repaired and fitted with vacuum glazing; Existing secondary glazing to the removed and replaced/upgraded

- 24.05.23 IM Issued for Listed Building Consent

PLANNING

rev	date	author / check	comments
DSDHA 357 Kennington Lane London SE11 5QY T 020 7703 3555 F 020 7703 3890 E info@dsdha.co.uk W www.dsdha.co.uk			
project 10-12 Museum Street and 35-37 New Oxford Street			
London, WC1A 1JR			
drawing title WCS - Demolition Plan - Third Floor			
drawn	size	date	scale
JM	A1	24/05/23	1 : 100
drawing number			revision
295B_P10.314			-
REPORT DISCREPANCIES DO NOT SCALE FROM THIS DRAWING COPYRIGHT DSDHA		USE LATEST REVISION CHECK DIMENSIONS ON SITE	