

NOTES

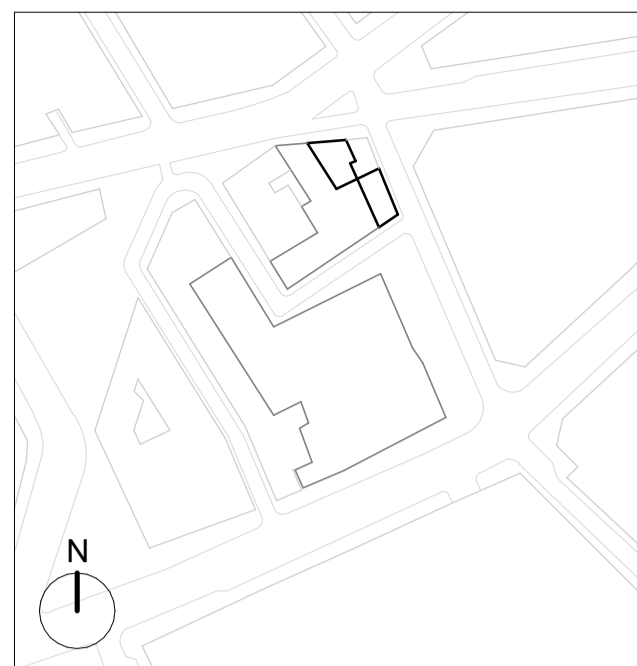

GENERAL NOTES:

Existing drawings are for reference only - not for approval.

KEY:

- Application Boundary
- Extent of Walls Demolition
- Extent of Demolition
- Extent of Existing Strip-out
* Modern fixtures and fittings are to be removed
** Modern floor finishes as part of strip-out, however existing slab structure to be retained except where noted.
*** Historic details to be retained
- Extent of Existing Strip-Out
- Extent of demolition/strip-out is unclear, further site investigations are required
- Existing structure removed and replaced
- Existing structure to be retained and repaired subject to further investigations
- Existing structural opening closed
- Existing window/door frame removed and replaced
- Existing windows to be deglazed, repaired and fitted with vacuum glazing, glazing bars to be added to match 33 New Oxford Street
- Existing windows to be deglazed, repaired and fitted with vacuum glazing, Existing secondary glazing to be removed and replaced/upgraded

37 New Oxford Street
 General Note: All modern fittings & finishes within 37 New Oxford Street, including floor, wall and ceiling finishes, to be sensitively removed. Historic details to be retained where extant.
 Modern boarding to internal face of windows to be removed
 Modern platform, stair, and associated railings to be removed
 Modern joinery to be removed
 Modern partitions and door to be removed to reinstate the buildings historic floorplan. Historic details & joinery to be retained where extant
 Modern kitchen & bathroom fittings to be removed
 Modern doors to be removed and replaced with appropriate restoration style. Original door architraves to be retained, repaired and redecorated

37 New Oxford Street
 General Note: All modern finishes within 35 New Oxford Street, including floor, wall and ceiling finishes, to be sensitively removed. Historic details to be retained where extant.
 Modern boarding to internal face of windows to be removed
 Modern partitions & doors to be removed to reinstate the buildings historic floorplan. Historic details & joinery to be retained where extant
 Modern cupboards to be removed
 Modern kitchen & bathroom fittings to be removed
 Modern doors to be removed and replaced with appropriate restoration style. Original door architraves to be retained, repaired and redecorated
 Modern boarding to kitchenettes to be removed

11-12 Museum Street
 General Note: All modern finishes within 11-12 Museum Street, including floor, wall and ceiling finishes, to be sensitively removed.
 Modern partitions & doors to be removed. Historic details & joinery to be retained where extant
 Modern kitchen & bathroom fittings to be removed
 Existing opening to the rear of 11 Museum Street stairs landing to be blocked up; New opening proposed at FFL to allow access from shared courtyard
 Existing stair to be demolished
 Existing walls and door to be demolished
 New opening in existing wall to form access between 11 & 12 Museum Street
 1990's extension to the rear of 11-12 Museum Street to be demolished

10 Museum Street
 General Note: All modern finishes within 10 Museum Street, including floor, wall and ceiling finishes, to be sensitively removed. Historic details to be retained where extant.
 Modern partition to be removed
 Modern bathroom fittings to be removed
 Modern doors to be removed and replaced with appropriate restoration style. Original door architraves to be retained, repaired and redecorated

WEST CENTRAL STREET

NEW OXFORD STREET

MUSEUM STREET

WEST CENTRAL STREET

24.05.23 IM Issued for Listed Building Consent

PLANNING

DSDHA
 357 Kennington Lane London SE11 5QY
 T 020 7703 3555
 F 020 7703 3890
 E info@dshda.co.uk
 W www.dshda.co.uk

project
10-12 Museum Street and 35-37 New Oxford Street

London, WC1A 1JR
 drawing title

WCS - Demolition Plan - Second Floor

drawn	size	date	scale
JM	A1	24/05/23	1 : 100
drawing number	revision		

295B_P10.313	-
--------------	---

REPORT DISCREPANCIES DO NOT SCALE FROM THIS DRAWING COPYRIGHT DSDHA
 USE LATEST REVISION CHECK DIMENSIONS ON SITE