

NOTES

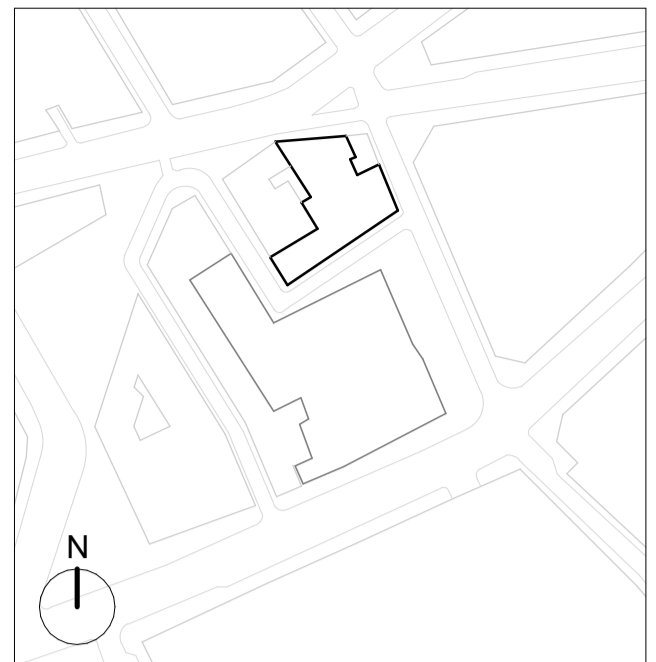

GENERAL NOTES:

Existing drawings are for reference only - not for approval.
 Planning Boundary shown is intended to align with proposed West End Project kerb extents along High Holborn, and is based on available information as submitted.

KEY:

- Planning Boundary
- Extent of Walls Demolition
- Extent of Demolition
- Extent of Existing Strip-out
 * Modern fixtures and fittings are to be removed
 ** Modern floor finishes as part of strip-out, however existing slab structure to be retained except where noted
 *** Historic details to be retained
- Extent of Existing Strip-Out
- Extent of demolition/strip-out is unclear; further site investigations are required
- Existing structure removed and replaced
- Existing structure to be retained and repaired subject to further investigations
- Existing structural opening closed
- Existing window/door frame removed and replaced
- Existing windows to be deglazed, repaired and fitted with vacuum glazing; glazing bars to be added to match 33 New Oxford Street
- Existing windows to be deglazed, repaired and fitted with vacuum glazing; Existing secondary glazing to be removed and replaced/upgraded

B	24.05.23	IM	Issued for Planning
A	01.06.22	IM	Issued for Planning Addendum
-	22.03.21	IM	Issued for Planning

PLANNING

DSDHA
 357 Kennington Lane London SE11 5QY
 T 020 7703 3555
 F 020 7703 3890
 E info@dsha.co.uk
 W www.dsha.co.uk

project
Museum Street and West Central Street

London, WC1A 1JR
 drawing title

WCS - Demolition Plan - Basement Floor

drawn	size	date	scale
Author	A1	22/03/21	1 : 100
drawing number	revision		
295B_P10.300	B		

REPORT DISCREPANCIES DO NOT SCALE FROM THIS DRAWING COPYRIGHT DSDHA

USE LATEST REVISION CHECK DIMENSIONS ON SITE