

NOTES

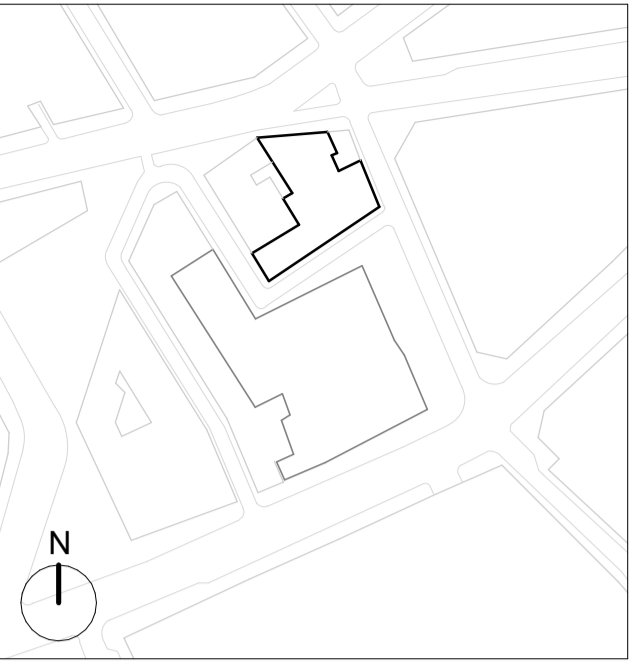

GENERAL NOTES:

Existing drawings are for reference only - not for approval.  
Planning Boundary shown is intended to align with proposed West End  
Project Park extents along High Holborn, and is based on available  
information as submitted.

KEY

Planning Boundary

B	24.05.23	IM	Issued for Planning
A	01.06.22	IM	Issued for Planning Addendum
-	22.03.21	IM	Issued for Planning

PLANNING

rev	date	author / check	comments
<b>DSDHA</b> 357 Kennington Lane London SE11 5QY T 020 7703 3555 F 020 7703 3890 E info@dsdha.co.uk W www.dsdha.co.uk			
project <b>Museum Street and West Central Street</b>			
London, WC1A 1JR			
drawing title <b>WCS - Existing Fourth Floor Plan</b>			
drawn	size	date	scale
Author	A1	22/03/21	1 : 100
drawing number			revision
295B_P10.184			B
REPORT DISCREPANCIES DO NOT SCALE FROM THIS DRAWING COPYRIGHT DSDHA		USE LATEST REVISION CHECK DIMENSIONS ON SITE	