

**NOTES**

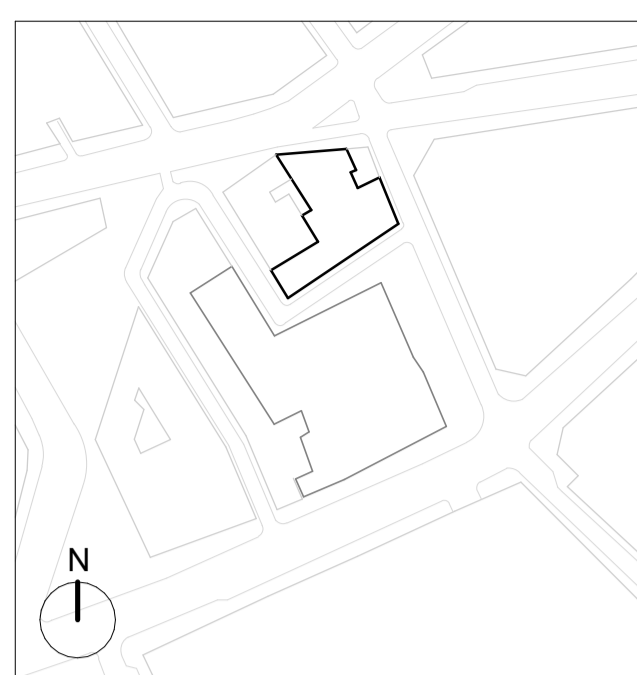

**GENERAL NOTES:**  
 Existing drawings are for reference only - not for approval.  
 Planning Boundary shown is intended to align with proposed West End Project front setbacks along High Holborn, and is based on available information as submitted.

**KEY**  
 — Planning Boundary

B 24.05.23 IM Issued for Planning  
 A 01.06.22 IM Issued for Planning Addendum  
 - 22.03.21 IM Issued for Planning

# PLANNING

**DSDHA**  
 357 Kennington Lane London SE11 5QY  
 T 020 7703 3555  
 F 020 7703 3890  
 E info@dsdha.co.uk  
 W www.dsdha.co.uk

project  
**Museum Street and West Central Street**

London, WC1A 1JR  
 drawing title

WCS - Existing Third Floor Plan

drawn	size	date	scale
Author	A1	22/03/21	1:100
drawing number	revision		
295B_P10.183	B		

REPORT DISCREPANCIES DO NOT SCALE FROM THIS DRAWING COPYRIGHT DSDHA USE LATEST REVISION CHECK DIMENSIONS ON SITE

