

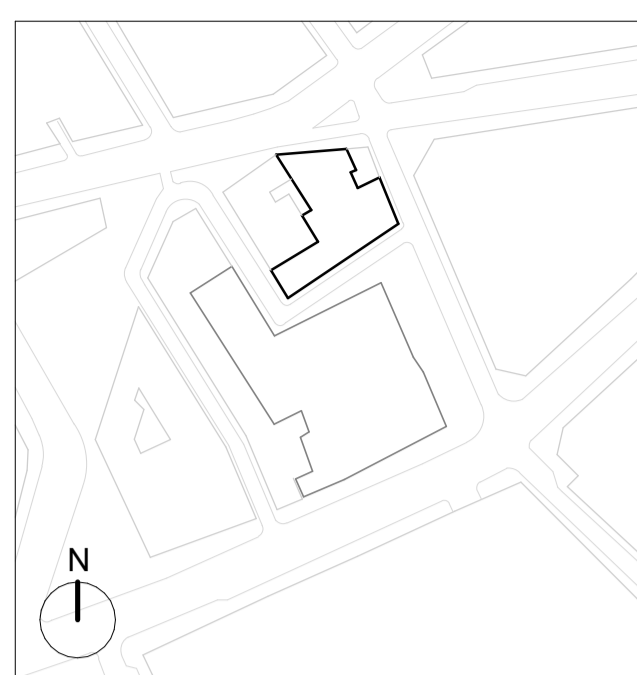

NOTES



GENERAL NOTES:
 Existing drawings are for reference only - not for approval.
 Planning Boundary shown is intended to align with proposed West End Project front setbacks along High Holborn, and is based on available information as submitted.

KEY
 — Planning Boundary

B	24.05.23	IM	Issued for Planning
A	01.06.22	IM	Issued for Planning Addendum
-	22.03.21	IM	Issued for Planning

PLANNING

DSDHA
 357 Kennington Lane London SE11 5QY
 T 020 7703 3555
 F 020 7703 3890
 E info@dshda.co.uk
 W www.dshda.co.uk

project
Museum Street and West Central Street

London, WC1A 1JR
 drawing title

WCS - Existing Ground Floor Plan

drawn	size	date	scale
JM	A1	22/03/21	1:100
drawing number	revision		
295B_P10.180	B		

REPORT DISCREPANCIES DO NOT SCALE FROM THIS DRAWING COPYRIGHT DSDHA
 USE LATEST REVISION CHECK DIMENSIONS ON SITE

