

PROPOSED GROUND FLOOR SCALE 1:50 @ A1

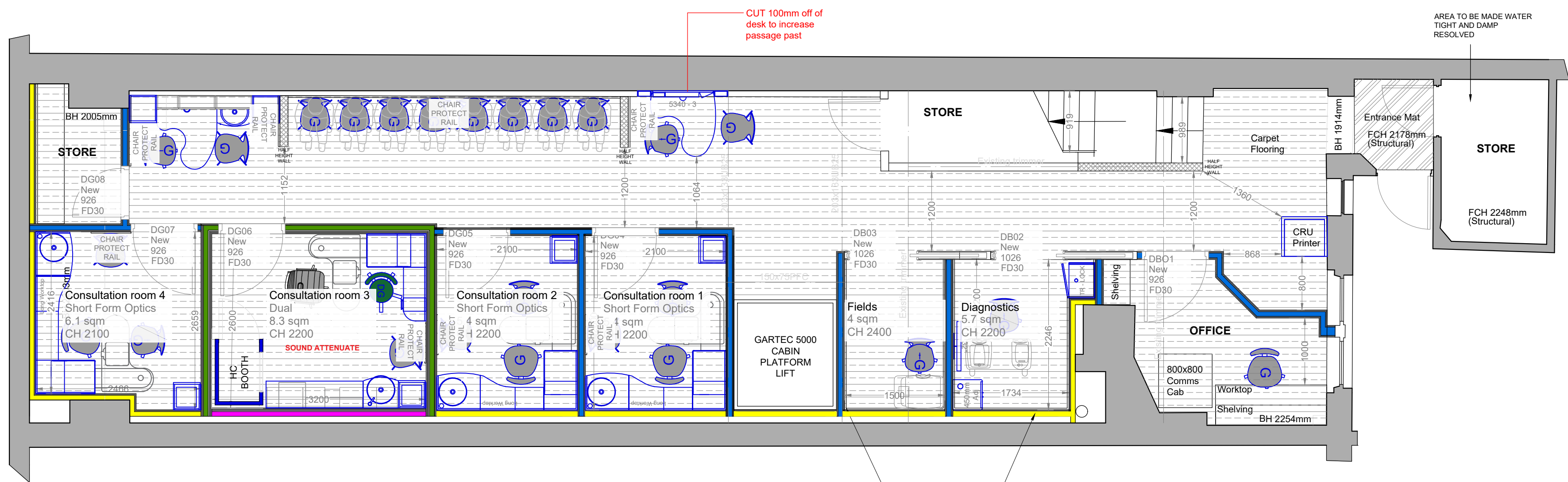

PROPOSED ELEVATION SCALE 1:50 @ A1

NOTES - SPECSAVERS DRAWINGS TO BE READ IN CONJUNCTION WITH THE SCHEDULE OF WORKS		
AIR CONDITIONING & VENTILATION	ELECTRICAL INSTALLATIONS	DEMOLITION & STRIP-OUT
ALL MECHANICAL VENTILATION TO BE DESIGNED BY AIR CONDITIONING CONTRACTOR. REFER TO AC CONTRACTORS DRAWINGS FOR ALL TECHNICAL NOTES AND DETAILING.	PROVIDE AND INSTALL ALL NEW ELECTRICAL FITTINGS AS SPECIFIED ON LEGEND, AND TO COMPLY WITH THE 18TH EDITION OF THE INSTITUTE OF ELECTRICAL ENGINEERS REGULATIONS, THE LOCAL ELECTRICITY BOARD REQUIREMENTS AND ALL RELEVANT BRITISH STANDARDS. CODES OF PRACTICE, CIBSE PUBLICATIONS AND APPROVED DOCUMENT L2B. CONTRACTOR TO PROVIDE THE RELEVANT CERTIFICATION UPON COMPLETION. ALLOW FOR FINAL LOCATION OF MULTIPOINT HEATER TO BE DIRECTED ON SITE. UNSWITCHED FUSED SPUR WITH INDICATOR LIGHT SHOULD ONLY BE INSTALLED IF SANIFLOW PUMP IS REQUIRED.	REMOVE ALL WALLS WHERE NECESSARY AS INDICATED ON PLAN AND CART AWAY DEBRIS FROM SITE. CONTRACTOR TO ALLOW FOR MAKING GOOD OF ALL AREAS PRIOR TO REDECORATION.
PLUMBING REQUIREMENTS	EMERGENCY PROVISIONS	
WORKS APPLICABLE TO GROUND FLOOR NEW TEST ROOM, CL TEACH & DISABLED WC, FIRST FLOOR NEW TEST ROOMS, LABORATORY, STAFFROOM & TOILETS.	- ALL FIRE EXIT SIGNAGE TO BE IN ACCORDANCE WITH BS 5499: Part 4: 2013. - ALL EMERGENCY LIGHTING TO BE IN ACCORDANCE WITH BS 5266: Part 1: 2016. - ALL AUTOMATIC FIRE DETECTION TO BE IN ACCORDANCE WITH BS 5839-1 (2002). - ALL SAFETY GLAZING TO COMPLY WITH BS 6206 AND BS 6262. - ALL WORK TO COMPLY IN ACCORDANCE WITH THE APPLICABLE LOCAL REGULATIONS, STANDARDS AND PUBLICATIONS.	
STRUCTURAL ALTERATIONS		
ALL STRUCTURAL ALTERATIONS, NEW LOAD BEARING ELEMENTS AND REMOVAL OF WALLS ETC., TO BE CARRIED OUT IN STRICT ACCORDANCE WITH STRUCTURAL ENGINEERS DETAILS AND CALCULATION SHEETS.		

FLOORING KEY

	Milliken Facets Accents Specsavers custom DR1105306
	Forbo Allura Grey College Oak Vinyl - 53 sqm
	Heckmondwike Hippo Ribbed barrier matting - 3.7 sqm
	Forbo safestep R11 174952 - Elephant - 14 sqm

WALL LEGEND	
	PARTITION OR WALL REMOVED
	EXISTING PARTITION OR WALL
	STANDARD STUD WALL NBS Spec Ref: K10/125 12.5mm plasterboard taped and filled on 12mm OSB/3 on either side of a 70mm metal stud
	ACOUSTIC STUD WALL NBS Spec Ref: K10/128 2no. layers of 12.5mm soundbloc plasterboard on 12mm OSB/3 on either side of a 70mm metal stud complete with resilient bar fitted to the inside face.
	WALL LININGS NBS Spec Ref: K10/155 12.5mm plasterboard on 12mm OSB/3 on 70mm Gyp liner wall lining system
	PRODUCT WALL LINING 12.5mm plasterboard on 18mm OSB/3 on 70mm Gyp liner wall lining system
	ACOUSTIC WALL LININGS NBS Spec Ref: ---- 2no. layers of 12.5mm Soundbloc Plasterboard on 12mm OSB/3 on 70mm Gyp liner wall lining system complete with resilient bar to the inside face.
	HALF HEIGHT / DWARF WALL NBS Spec Ref: K10/126 12.5mm Soundbloc Plasterboard on 12.5mm Plywood / sterling board on 70mm s/w timber stud.

Amendments:			
Rev	Init	Date	Description

Drawn By:	fisch	FISCH DESIGN LTD 1 HERITAGE BUSINESS CENTRE DERBY ROAD, Belper DERBYSHIRE, DE56 1SW
+44 (0)1773 828222 / WWW.FISCHDESIGN.CO.UK / MAIL@FISCHDESIGN.CO.UK		

Caring for your sight and hearing

Business Development,
Cirrus House, 10 Experian Way,
Nottingham, NG2 1EP

Tel: +44 (0)345 2020 241
Email: designs@specsavers.com

Project:
Specsavers Opticians
194 West End Lane
West Hampstead
London
NW6 1SG

Title:
Proposed plans and Elevation

**WEST HAMPSTEAD
NEW STORE**

PRODUCTION DRAWING

Drawn By:	Scale:	Date:
GT	1:100@A1 1:50@A1	22/05/2023

Drawing Number:
2501/1011

Revision:

Do not scale from this drawing. Dimensions to be checked on site