

Proposed Section BB

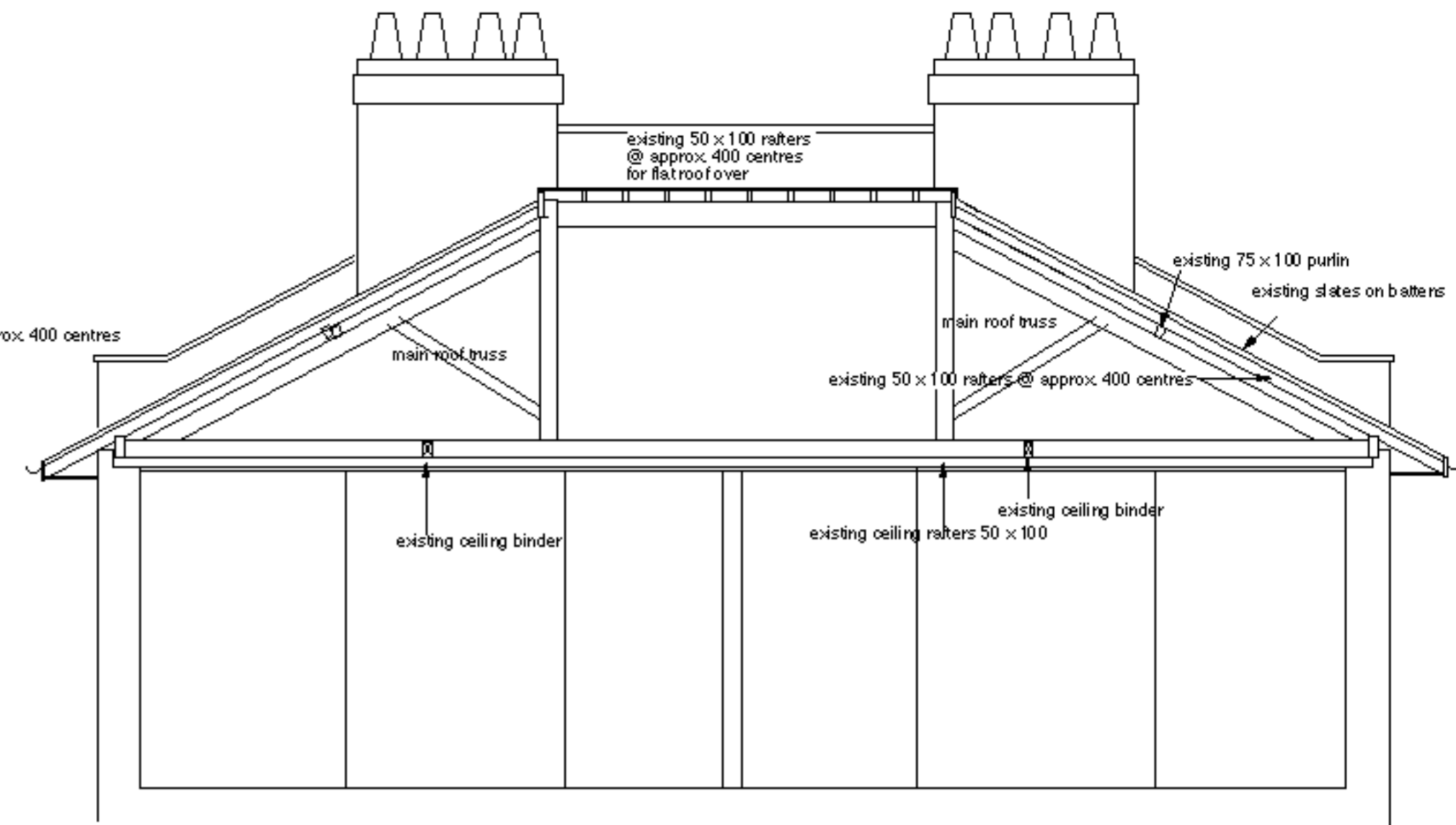

Existing Section BB

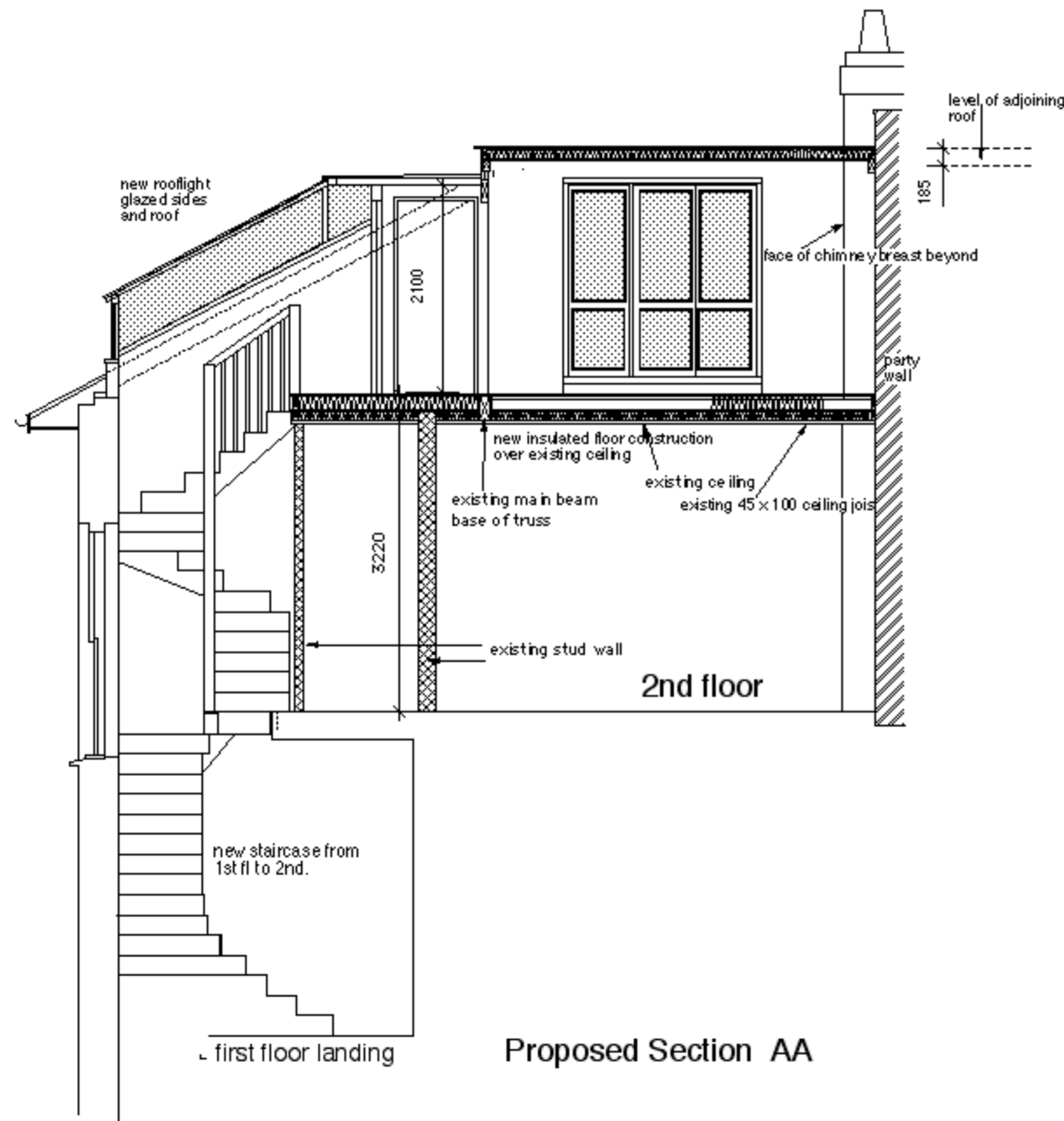

Proposed Section AA

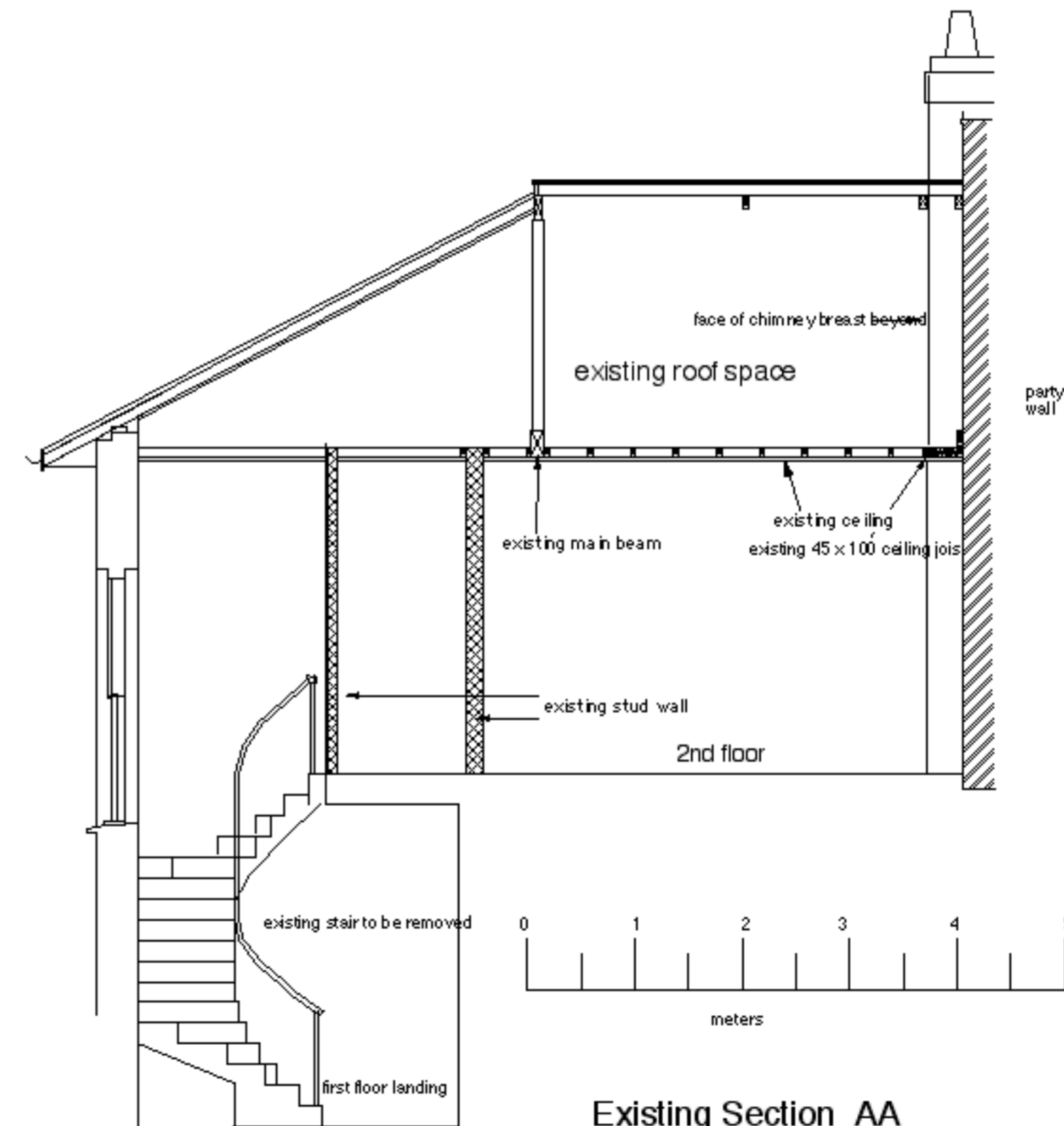

Existing Section AA

Architects and Project Managers
Tim Drewitt Associates
 83 Somers Court
 185 Haversham Hill
 London NW8 4PX
 Tel: 020 7488 8070
 07770 450054
 E: tim.drewitt@tda.co.uk

Studio flat
 15 Upper Park Road
 London NW8 2UN
 DWG1
 Existing and proposed sections
 Second floor, Third floor

Scale: 150 @ A2
 Date: Feb 2023
 DWG No: UPR/15.03