

EXISTING COURTYARD PLAN
scale 1:200

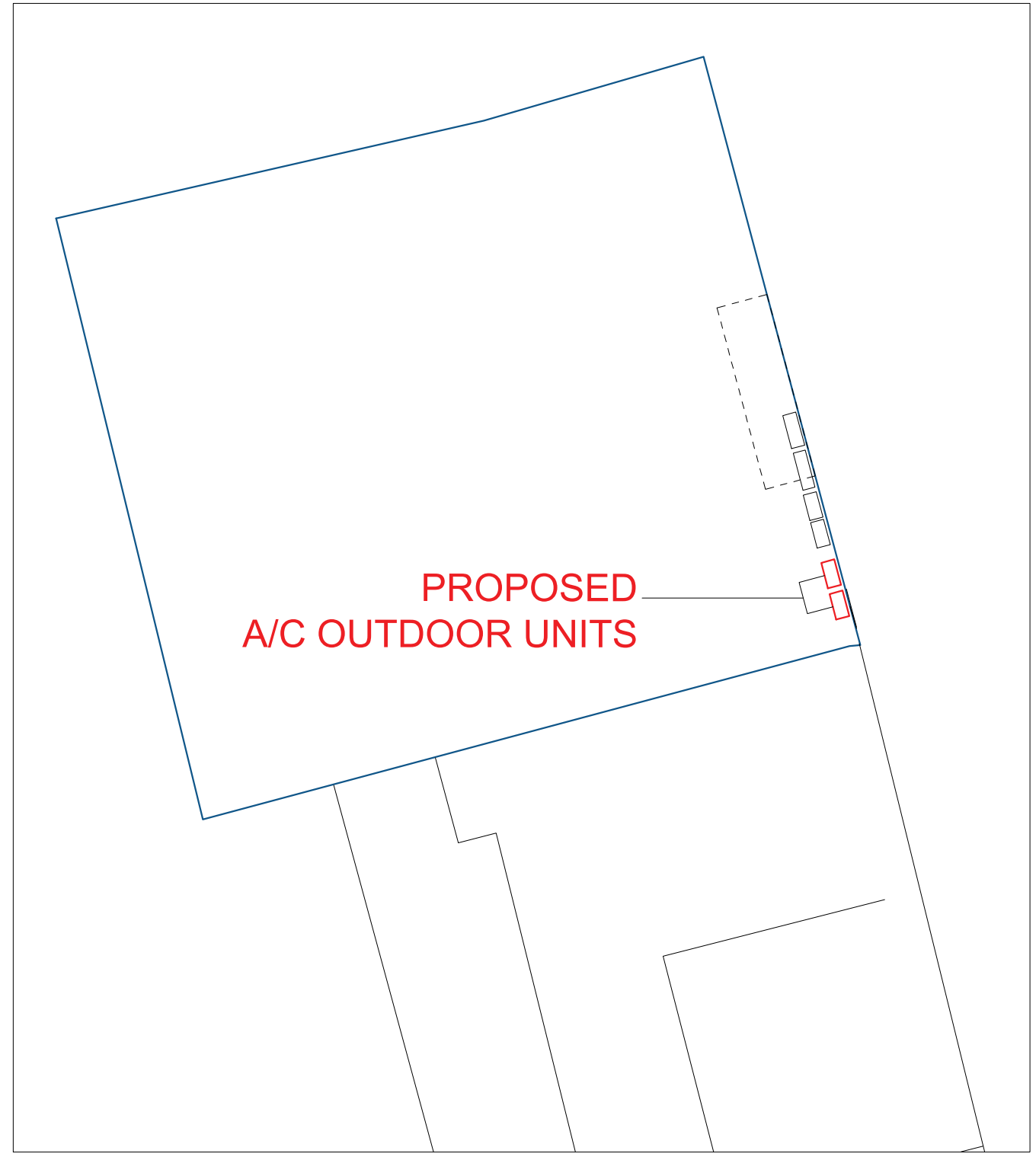

PROPOSED COURTYARD PLAN
scale 1:200



F-Line Designs Ltd
12 Berghem Mews,
Blythe Road, London
United Kingdom
W14 0HN
planning@finedesigns.com
020 364 268 00

GENERAL NOTES

- All dimensions must be checked on site before any works commencement.
- All discrepancies must be reported to the Main Architect before works proceed.
- Only figured dimensions are to be used.
- Any conflict of given data on the drawing(s) with site condition to be discussed with the Architect
- The General Contractor and/or all Sub-contractors working according these drawings and specifications to contact the architect or representative if any measurements do not appear correct or unclear, add up properly or scale correctly to the indicated size upon approvals.

STRUCTURAL NOTES

- All drawings to be read in conjunction with structural engineer's drawings and specifications.
- All Structural Elements Spans must be measured on site before ordering.
- This drawing must be read in conjunction with the Structural Engineer's Drawings, Calculations and other details.
- Accurate site dimensions are to be taken by the contractor on site prior to any construction commencing.

PROJECT

INSTALLATION OF A/C UNITS

PROPERTY ADDRESS

108-109,
HATTON GARDEN,
EC1N 8NX

TITLE

EXISTING & PROPOSED
COURTYARD PLAN

DWG REF

FL129

TAB

A103

REV	DATE	BY	SCALE
-	09/06/2023	NV	1:200 / A3
-		AC	
-			