

UPPER GROUND FLOOR

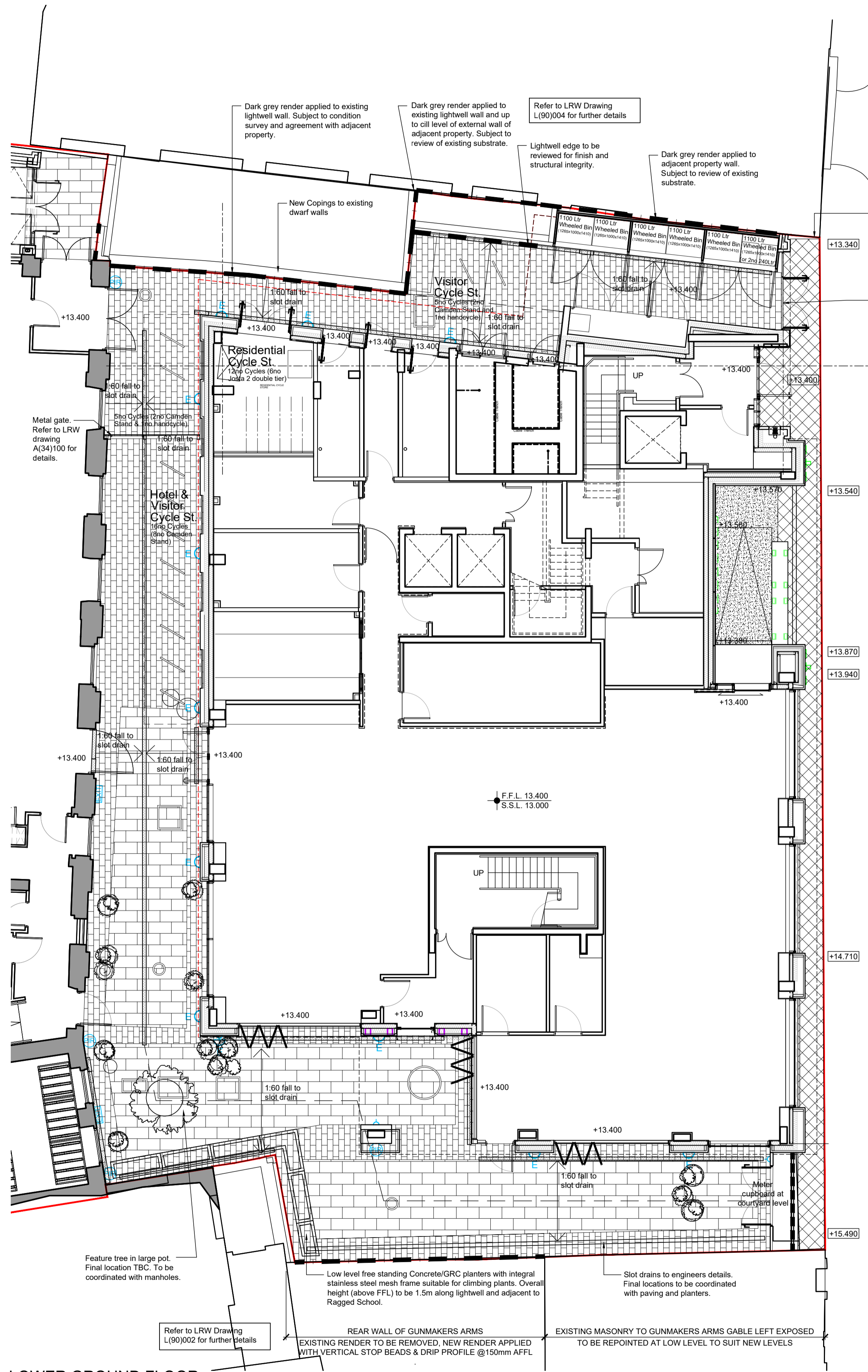

LOWER GROUND FLOOR

| EXTERNAL WORKS KEY:   |  | GENERAL NOTES:   |  |
|---|--|--|--|
| <b>EXTERNAL FINISHES</b>  |  |  |  |
|   | <b>LARGE FORMAT PAVING</b><br>Material: Natural stone<br>Manufacturer: Marshalls or equal approved<br>Colour: Mix of grey, purple and pink tones | <p>ALL DIMENSIONS ARE TO BE CHECKED ON SITE WITH ANY DISCREPANCIES REPORTED TO THE ARCHITECT PRIOR TO THE WORKS BEING CARRIED OUT.</p> <p>ALL WORKS ARE TO BE IN ACCORDANCE WITH THE PLANNING APPROVAL AND ANY SUBSEQUENT APPROVED LOCAL AUTHORITY PLANNING CORRESPONDENCE INCLUDING DRAWINGS, DOCUMENTS AND REPORTS.</p> <p>ALL WORKS ARE TO COMPLY WITH THE BUILDING REGULATIONS, BRITISH STANDARDS, CODE OF PRACTICE, AND ANY LOCAL STATUTORY REQUIREMENTS.</p> <p>ALL WORKS ARE TO COMPLY WITH CURRENT HEALTH AND SAFETY LEGISLATION, H.S.E. RECOMMENDATIONS/GUIDANCE AND THE CURRENT C.D.M. REGULATIONS.</p> <p>THIS DRAWING IS TO BE READ IN CONJUNCTION WITH LEACH RHODES WALKER ARCHITECTS GENERAL ARRANGEMENT (L CODE) DRAWINGS, TOGETHER WITH RELEVANT DETAILED (A CODE) DRAWINGS AND SPECIFICATIONS.</p> <p>FOR ALL STRUCTURAL WORKS REFER TO THE STRUCTURAL ENGINEERS INFORMATION.</p> <p>FOR ALL MECHANICAL AND ELECTRICAL WORKS REFER TO THE MECHANICAL AND ELECTRICAL ENGINEERS INFORMATION.</p> <p>FOR ALL ABOVE GROUND DRAINAGE WORKS REFER TO THE PUBLIC HEALTH ENGINEERS INFORMATION.</p> <p>ALL PRODUCTS SPECIFIED ARE TO BE INSTALLED STRICTLY IN ACCORDANCE WITH THE MANUFACTURERS RECOMMENDATIONS, SPECIFICATION AND DETAILS.</p> |  |
|   | <b>SMALL SETT PAVING - TYPE A</b><br>Material: Natural stone<br>Manufacturer: Marshalls or equal approved<br>Colour: Mix of blue and pink tones  |  |  |
|   | <b>SMALL SETT PAVING - TYPE B</b><br>Material: Natural stone<br>Manufacturer: Marshalls or equal approved<br>Colour: Mix of blue and grey tones  |  |  |
|   | <b>PAVEMENT</b><br>Material: TBC<br>Manufacturer: TBC<br>Colour: To match existing highways finishes   |  |  |
|   | <b>GRAVEL EDGE STRIP</b><br>Material: Gravel<br>Manufacturer: Marshalls or equal approved<br>Colour: Grey  |  |  |
|   | <b>PIN CURB</b><br>As civil engineers details  |  |  |
|   | <b>EXTERNAL BARRIER MATTING</b><br>Intrasystems Waterlogic Ribbed Rubber Inserts in Bronze Profile   |  |  |
|   | <b>SLOT DRAIN</b><br>As civil engineers details  |  |  |
|   | <b>RAILINGS</b><br>Refer to A(34) series drawings for further details  |  |  |
|   | <b>RENDER FINISH</b><br>Proposed render finish to adjacent buildings   |  |  |
|   | <b>EXTERNAL SOCKETS</b><br>Refer to engineers information for further details  |  |  |
|   | <b>EMERGENCY LIGHT FITTINGS</b><br>Fixed to facade at circa 2800mm AFFL.   |  |  |
|   | <b>EMERGENCY EXIT SIGNS &amp; PIR'S</b><br>Fixed to facade at circa 2800mm AFFL.   |  |  |
| <b>PAVING NOTES:</b><br>Substrate build-up and thickness as required to deal with public highways loadings and service conditions as civil engineers details.<br>All paving must be laid to falls away from the building line with suitable flush thresholds at all doors and slot drains across all door thresholds.<br>All paving to be slip resistant. |  |  |  |
| <b>STREET FURNITURE</b>   |  |  |  |
|   | <b>CYCLE STANDS</b><br>Type: CaMen cycle stands<br>Finish: Stainless steel   |  |  |

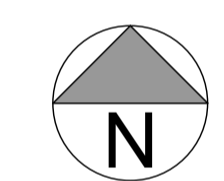

|     |  |       |      |          |
|-----|--|-------|------|----------|
| E   | PLANNING ISSUE EXTERNAL LIGHTING & POWER ADDED.                          | SJM   | SJM  | 26.04.23 |
| D   | PLANNING ISSUE   | CS    | SJM  | 16.03.23 |
| C   | BOUNDARY TREATMENT OPTION 2 OMITTED                                      | BE    | SJM  | 17.06.20 |
| B   | ADDITIONAL PARTY WALL TREATMENTS ADDED.                                  | SJM   | SJM  | 16.04.20 |
| A   | EXTERNAL SOCKETS ADDED, KEY UPDATED IN LINE. TITLE PANEL NAMING UPDATED. | HL    | SJM  | 30.03.20 |
| rev | Description  | drawn | auth | date     |

DO NOT SCALE OFF THIS DRAWING © LEACH RHODES WALKER 2021

**LeachRhodesWalker**  
Architects

info@lrw.co.uk | www.lrw.co.uk  
H.Q. 50 Dearmans Place | Manchester M3 5LH

Manchester +44 (0)161 833 0211 | London +44 (0)207 993 1363

client: CLERKENWELL LIFESTYLE (UK) LTD

project: VINE HILL

project no: 8060 | drawing no: L(90)001 | rev: E

description: SITE PLAN HOTEL AND OFFICE

scale: 1:100@ A1 | date drawn: 21.02.20 | drawn by: HL | authorised by: SJM

purpose of issue:  planning  building regs  tender  prelim./comment  approval  construction