

APPENDIX D

SUDS STRATEGY LAYOUT AND CALCS

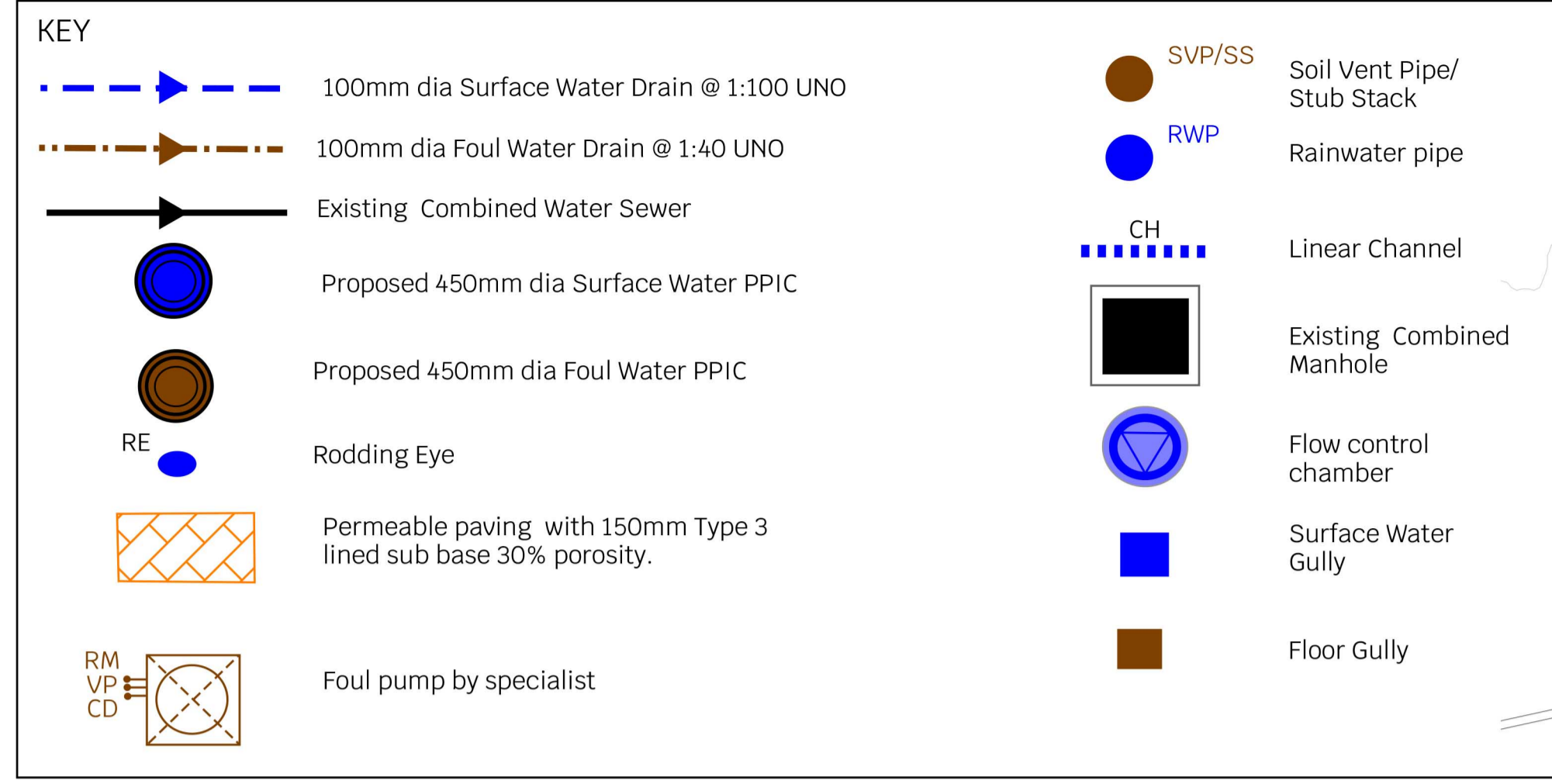

Existing areas

Impermeable	Permeable
Roof 48 sqm	Grass 59.3 sqm
External paving 61.3 sqm	

Existing runoff 3.22 l/s

Rational Method
 $Q = 2.78 \times 106.3 \times 0.0109 = 3.22 \text{ l/s}$
 intensity calculated for 1 in 100 15 min storm

Proposed areas

Impermeable	Permeable
Roof 59 sqm	Greenroof 39 sqm
	Permeable Paving 70.6 sqm

Proposed runoff 1.4 l/s for 1 in 100 +40%
56% reduction of existing rates

Impermeable areas are reduced by 35%

NOTES

1. Drainage Strategy subject to CCTV Drainage Survey and detailed design
2. Drainage Strategy for planning stage only, to be developed
3. Foul water drainage to be developed at next design stage

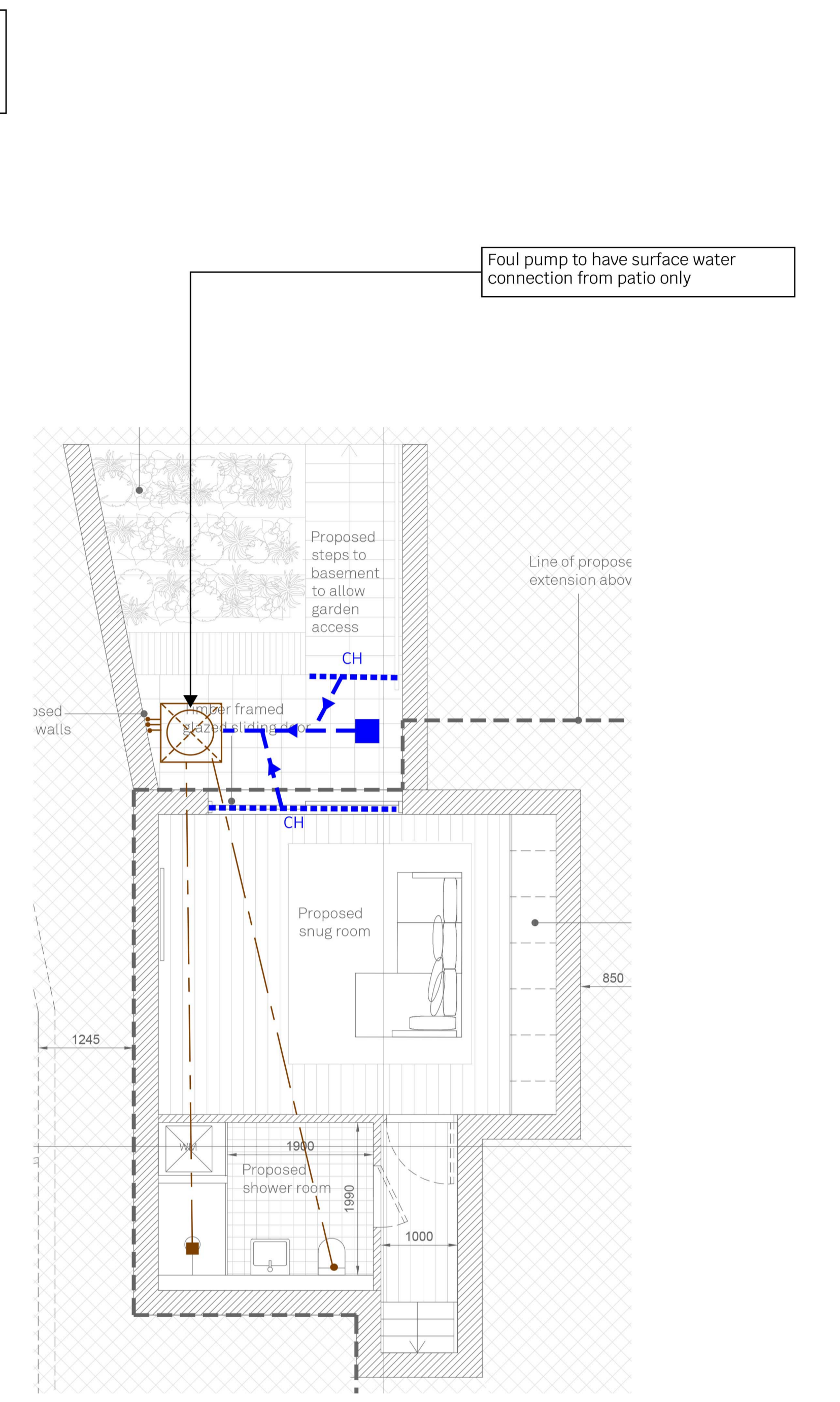
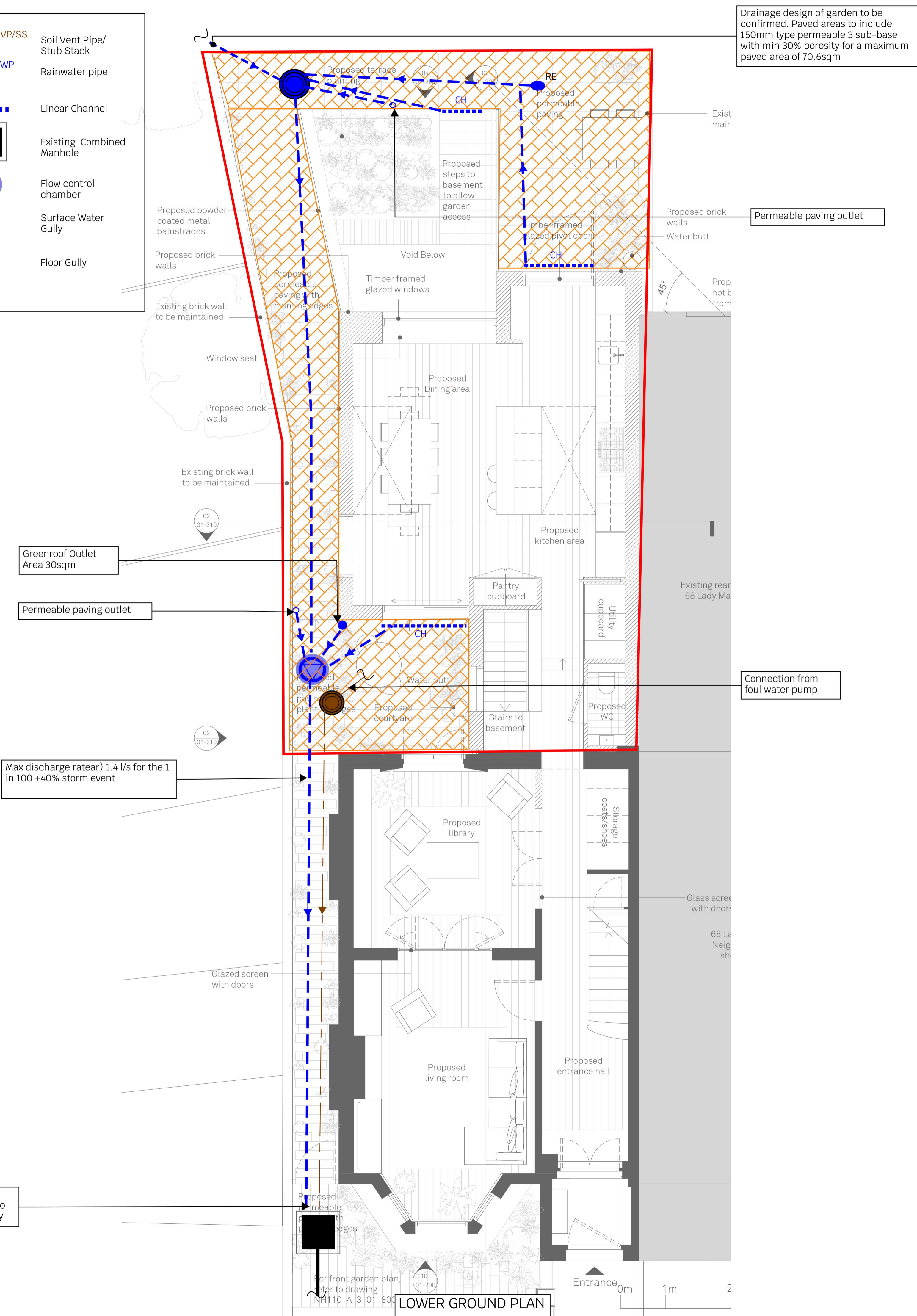

BASEMENT PLAN

LOWER GROUND PLAN



22276-SYM-XX-XX-SK-C-0001-REV A
 70 Lady Margaret Road
 London NW5 2NP
 SUDS LAYOUT
 YP
 23/05/2023