

Photographs - Rear Garden

Photo 3.

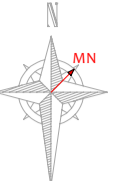

Photo 4.



Tree Data Schedule

Reference G = Group H = Hedge	Age & Species	Height (m)	Crown Ht (m)		Crown Spread (m)	Scaled Tree Diagram (m)	Notes	Recommendations (Independent of any development proposals)		Vigour Physiological Condition Structural Condition	Amenity Value Life Expectancy (yrs) Retention Category	
			W	E				Priority	Inspect Freq (yrs)			
T1	Semi-Mature Sycamore <i>Acer pseudoplatanus</i>	12	3	21	4	3	Position: Situated on third party land. Other: Limited inspection, dimensions estimated. Recorded stem diameter is equivalent for three stems (13cm, 12cm, 12cm).	No action required.	n/a	3	Good	Low 40+ C
T2	Early-Mature Ash <i>Fraxinus excelsior</i>	12	3.5	38	5	5	Position: Situated on third party land. History: Previously topped at 5m. Defects: No significant defects observed. Other: Limited inspection, dimensions estimated.	No action required.	n/a	3	Good	Low 40+ C
T3	Early-Mature Cherry <i>Prunus sp.</i>	9	2.5	28	4	3	Form: Single stemmed and vertical with a poorly formed crown. History: Previously topped at 6m.	No action required.	n/a	3	High Good Fair	Low 40+ C
T4	Early-Mature Sycamore <i>Acer pseudoplatanus</i>	13	4	40	4.5	4.5	Position: Situated on third party land. Other: Limited inspection, dimensions estimated.	No action required.	n/a	3	Moderate Good Good	Moderate 40+ B
T5	Mature Cherry <i>Prunus sp.</i>	11	5	32	5	3.5	Form: Twin-stemmed at 3m with a compact crown. History: Multiple pruning wounds due to crown reduction & crown lifting.	No action required.	n/a	3	Moderate Good Good	Low 40+ C+
T6	Early-Mature Ash <i>Fraxinus excelsior</i>	13	4	50	4	4	Position: Situated on third party land. History: Recently heavily reduced. Other: Limited inspection, dimensions estimated.	No action required.	n/a	3	Moderate Good Good	Low 40+ C+

Drawing No: CCL 11413 / TCP Rev: 1
 Title: Tree Constraints Plan (Existing Layout)
 Site: 70 Lady Margaret Road NWS 2NP
 Scale: 1:100 Paper Size: A1

Tree Retention Categories
 Stems & canopies shown

- Category A tree
- Category B tree
- Category C tree
- Category U tree

CROWN
 Arboricultural Consultants
 01423 316660

Trees of high quality with an estimated life expectancy of 40+ years. Usually large trees with significant presence or smaller trees with excellent form. Retention of these trees is highly desirable.
 Trees of moderate quality with a life expectancy of 20+ years. Usually maturing trees, or younger trees with good form. Retention of these trees is desirable though less than Category A trees.
 Unremarkable trees of low quality and merit. Individual specimens are not considered to be a material planning consideration.
 Trees unsuitable for retention due to their very poor condition.

Tree Constraints Plan
 Status: Final

BS 5837 Root Protection Area (radius = 1x stem diameter)
 Root Protection Area needing amendment due to site conditions, e.g. presence of existing road or building.
 Root Protection Area having been amended to account for site conditions

T1 = Tree No 1 G2 = Group No 2 H3 = Hedge No 3

Photo 1
 MN = Measured North:
 Canopy spreads are sometimes measured to an approximate N defined by site features. Often more accurate, especially where rows of trees are not aligned N-S or E-W.

Tree Ref.	Species	Height (m)	Root Protection Area	
			Radius (m)	Square (m)
T1	Sycamore	12	2.5	4.5
T2	Ash	12	4.6	8.1
T3	Cherry	9	3.4	6.0
T4	Sycamore	13	4.8	8.5
T5	Cherry	11	3.8	6.8
T6	Ash	13	6.0	10.6

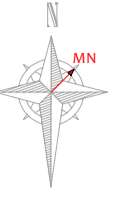

Existing Layout (Black)
 Demolition Layout (Blue)
 Proposed Layout (Pink)

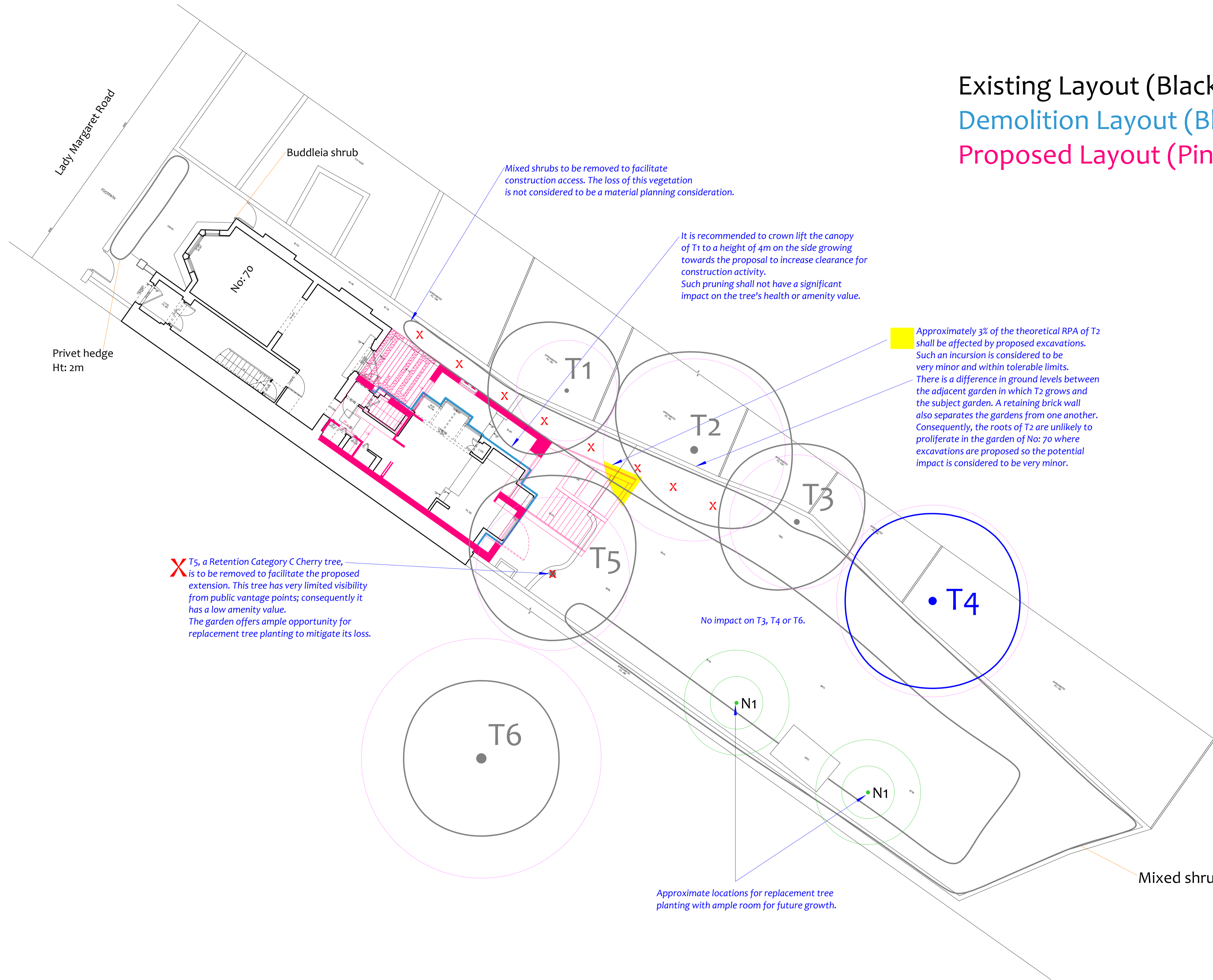

Drawing No: CCL 11413 / IAP Rev: 1
 Title: Impact Assessment Plan
 Site: 70 Lady Margaret Road NWS 2NP
 Scale: 1:100 Paper Size: A1



Tree Retention Categories		Stems & canopies shown
	Category A tree	Trees of high quality with an estimated life expectancy of 40+ years. Usually large trees with significant presence or smaller trees with excellent form. Retention of these trees is highly desirable.
	Category B tree	Trees of moderate quality with a life expectancy of 20+ years. Usually maturing trees, or younger trees with good form. Retention of these trees is desirable though less than Category A trees.
	Category C tree	Unremarkable trees of low quality and merit. Individual specimens are not considered to be a material planning consideration.
	Category U tree	Trees unsuitable for retention due to their very poor condition.

Impact Assessment Plan

Status: Final - for submission

	B5 S837 Root Protection Area (radius = 1x stem diameter)
	Root Protection Area needing amendment due to site conditions, e.g. presence of existing road or building.
	Root Protection Area having been amended to account for site conditions
T1 = Tree No 1	G2 = Group No 2 H3 = Hedge No 3

Tree to be removed to facilitate the proposal
 Tree to be removed due to its low quality
 Proposed pruning

MN = Measured North:
 Canopy spreads are sometimes measured to an approximate N defined by site features. Often more accurate, especially where rows of trees are not aligned N-S or E-W.

Tree Ref.	Species	Height (m)	Root Protection Area	
			Radius (m)	Square (m)
T1	Sycamore	12	2.5	4.5
T2	Ash	12	4.6	8.1
T3	Cherry	9	3.4	6.0
T4	Sycamore	13	4.8	8.5
T5	Cherry	11	3.8	4.6
T6	Ash	13	6.0	10.6