



EXISTING FLOOR PLAN - ROOM G39

DEMOLITION AND ALTERATION NOTES

 Existing doors to be retained and protect for durations of works.

 Take up existing carpet within room & clear from site.
carpet

 Take out and clear from site FFE items.

 Radiator to be removed as M&E specifications

 Removal of railings on the window on the external side.

NOTE:

- Refer to asbestos refurbishment and demolition survey before commencing works.

- Erect all necessary full height temporary acoustic hoarding / dust hoarding / barriers to protect the area of works and adjoining accommodation from both noise and dust where required

EXISTING SECTION A

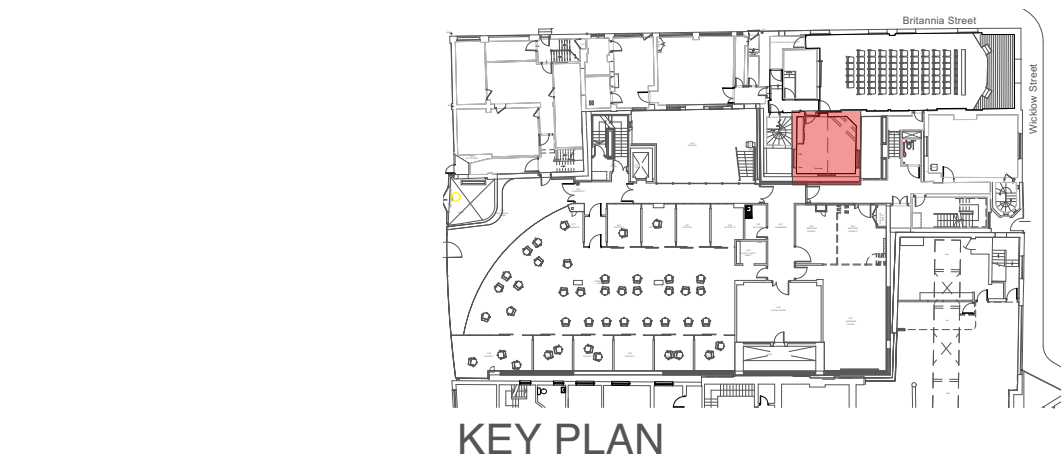

D&A - SW08 - EAR INST., 75 WICKLOW ST EXISTING FLOOR PLAN AND SECTION - ROOM G39



Scale 1:50 @ A3



 Kendall Kingscott

Chartered Architects
Chartered Building Surveyors
Interior Designers
CDM Services

Suite 3, Sandford House,
1b Claremont Road,
Teddington, TW11 8DH
+44 (0)20 8943 5300
www.kendallkingscott.co.uk

Project
Life and Medical Sciences - Small Works

Client
University College London

Scale 1:50
Paper Size ISO A3
Filename 220593-UCL-Contract B -SW08 AC
v2022.vwx
Do not scale this drawing

P1 22/05/23 AC MM Issued to Planning
Rev Date By Ap Note

Drawing Title
D&A - SW08 - Ear Inst., 75 Wicklow St
Existing Floor Plan - Room G39

Project Number Drawing Number Revision

220593(SW08)-1600 P1

Date 23/06/2022 Drawn ML Checked KS Purpose/Status PLANNING

Only to be used on the site for which designed. The electronic transmission of designs/information contained in this drawing is carried out entirely at the User's risk and Kendall Kingscott Ltd. will have no liability for any errors or inaccuracies arising therefrom. The production of amended or updated information from the said designs/information by the User is entirely the responsibility of the User and Kendall Kingscott Ltd. shall have no responsibility in respect thereof whatsoever.