

PROPOSED FLOOR PLAN - ROOM G02



KEY PLAN

CEILING - SW24 - 49 GORDON SQUARE
PROPOSED GROUND FLOOR



Scale 1:50 @ A3

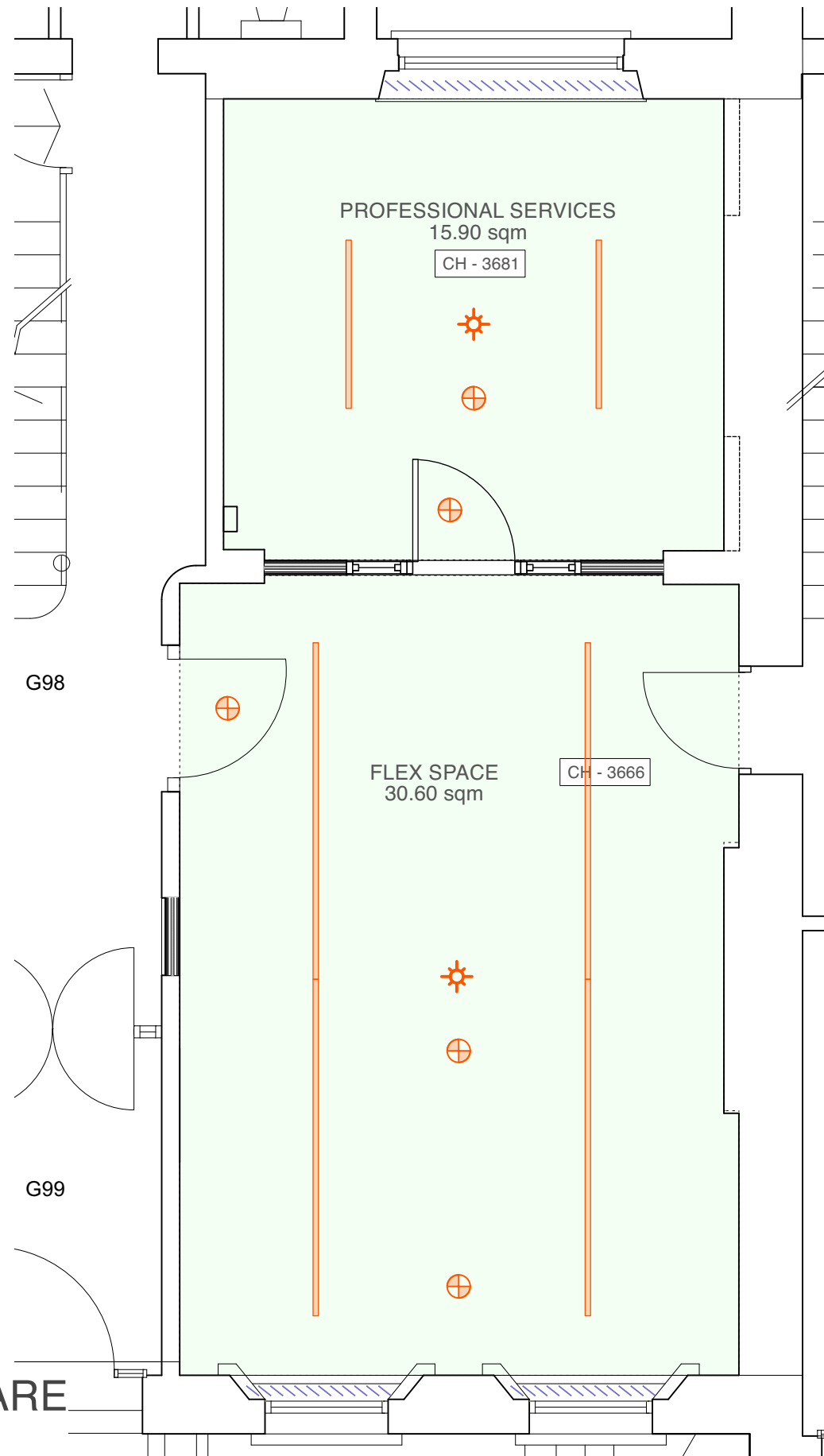

PROPOSED FLOOR PLAN
ROOM G01

CEILING TYPE KEY:

 TYPE 1 EXISTING CEILING Clean, make good, and redecorate. Colour as per finishes schedule.	 TYPE 2 NEW MINERAL FIBRE CEILING TILES Refer clause K45/40 Colour as per finishes schedule. Allow access panels if required.
 TYPE 3 NEW SUSPENDED MR PLASTERBOARD CEILING Refer clause K40/21. Colour as per finishes schedule. Allow access panels if required.	<p>CH - xxxx Indicated ceiling height</p>

MECHANICAL AND ELECTRICAL KEY:

 ELECTRICAL: Refer to M&E specification for electrical details.	 MECHANICAL: Refer to M&E specification for mechanical details.
 Refer to M&E specification for light presence detector.	 Emergency lighting.

MECHANICAL AND ELECTRICAL NOTES:

For information relating to the mechanical and electrical work please refer to the package contained within Document 1 Volume 3 - Mechanical and Electrical Specification and Drawings. Please advise the CA if any discrepancies are identified between this this drawing and M&E information.



Chartered Architects
Chartered Building Surveyors
Interior Designers
CDM Services
Suite 3, Sandford House,
1b Claremont Road,
Teddington, TW11 8DH
+44 (0)20 8943 5300
www.kendallkingscott.co.uk

Project		Life and Medical Sciences - Small Works		Drawing Title		Ceiling - SW24 - 49 Gordon Square Proposed Ground Floor	
Client		University College London		Project Number		220593(SW24)-2501	
Scale		1:50		Drawing		ML	
Paper Size		ISO A3		Checked		KS	
Filename		220593-UCL-Contract B -C1		Purpose/Status		CONSTRUCTION	
Date		23/06/2022		Revision		C1	

Only to be used on the site for which designed. The electronic transmission of designs/information contained in this drawing is carried out entirely at the User's risk and Kendall Kingscott Ltd. will have no liability for any errors or inaccuracies arising therefrom. The production of amended or updated information from the said designs/information by the User is entirely the responsibility of the User and Kendall Kingscott Ltd. shall have no responsibility in respect thereof whatsoever.