

PROPOSED FLOOR PLAN - ROOM G02

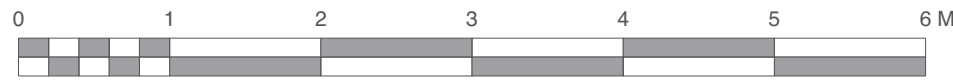

KEY PLAN

SW24 - 49 GORDON SQUARE
PROPOSED GROUND FLOOR





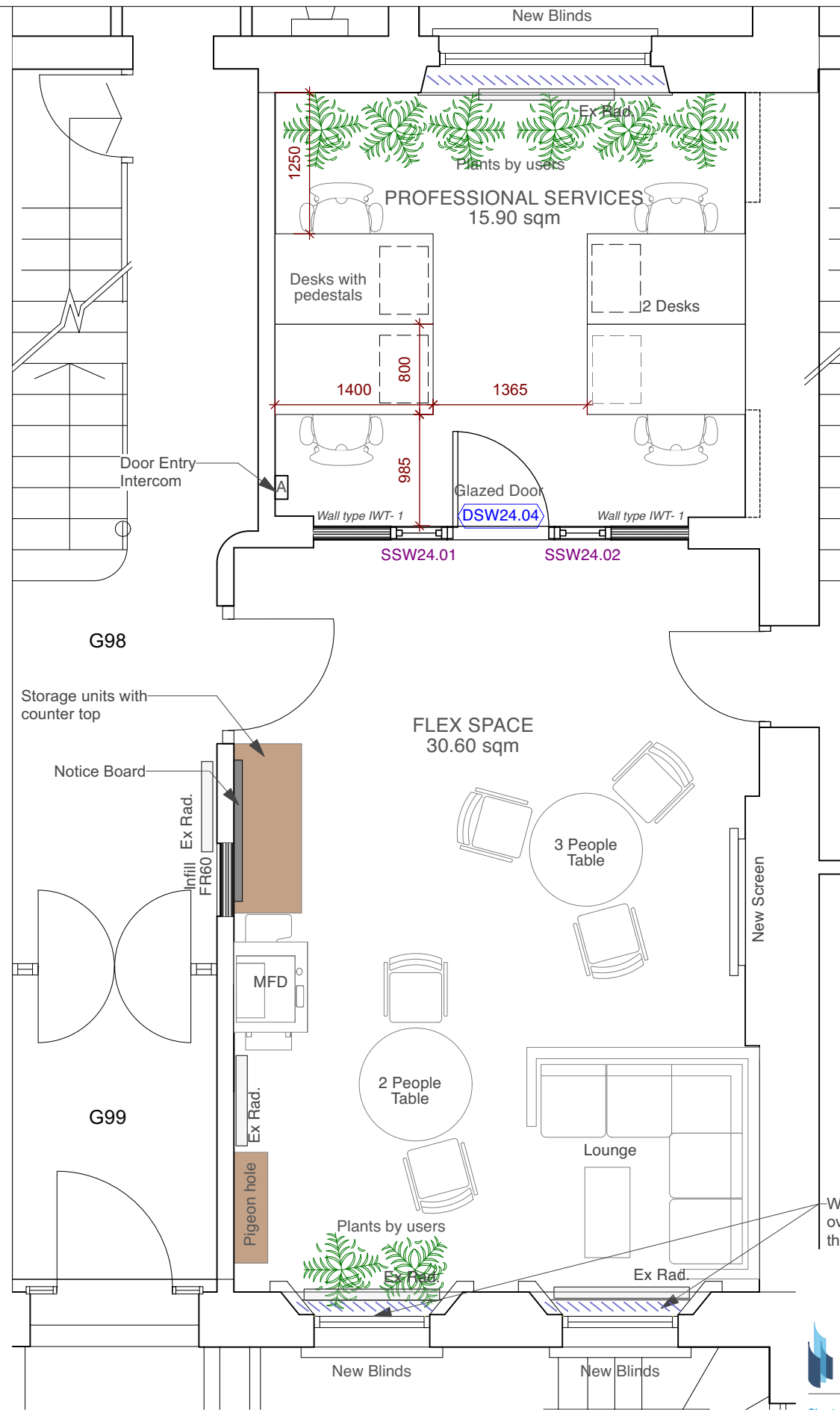





Scale 1:50 @ A3



PROPOSED FLOOR PLAN
ROOM G01

Key

-  Out of Scope
-  Demolitions
-  New storage
-  New internal partition wall as clause K10/31
Refer to 220593(SW24)-4100 Proposed Internal Partition Details for further information.
-  New glazed partition wall
-  Proposed decorative blind as clause N10/70
-  Door Entry Intercom
-  Radiator



Chartered Architects
Chartered Building Surveyors
Interior Designers
CDM Services

Suite 3, Sandford House,
1b Claremont Road,
Teddington, TW11 8DH
+44 (0)20 8943 5300
www.kendallkingscott.co.uk

Project
Life and Medical Sciences - Small Works

Client
University College London

Scale Paper Size Filename
1:50 ISO A3 220593-UCL-Contract B -C1

C1	20/01/2023	ML	KS	STAGE 5 - Construction Issue
P2	09/11/2022	ML	KS	STAGE 4 - Issued
P1	14/10/2022	ML	KS	STAGE 3 - Issued
Rev	Date	By	Ap	Note

Drawing Title
GA - SW24 - 49 Gordon Square
Proposed Ground Floor

Project Number Drawing Number Revision

220593(SW24)-2001 C1

Date Drawn Checked Purpose/Status
23/06/2022 ML KS CONSTRUCTION

Check all dimensions and levels on site

Only to be used on the site for which designed. The electronic transmission of designs/information contained in this drawing is carried out entirely at the User's risk and Kendall Kingscott Ltd. will have no liability for any errors or inaccuracies arising therefrom. The production of amended or updated information from the said designs/information by the User is entirely the responsibility of the User and Kendall Kingscott Ltd. shall have no responsibility in respect thereof whatsoever.