

5 NO OLIVE TREES

EXISTING LILAC TREE TO BE PRUNED AT FRONT WITH TWO LARGEST HORIZONTAL BRANCHES TO BE REMOVED AT GROUND LEVEL TO ALLOW CONSTRUCTION OF NEW BIN STORE CLIPBOARD

FRONT LOW LEVEL BRICK PLANTER TO BE REMOVED

4 NO VEGETABLE WASTE BINS STORED TWO ABOVE TWO ON SHELF IN CLIPBOARD

4 NO CAMDEN WASTE & RECYCLING BINS INSIDE CLIPBOARD DESIGN OF DOORS & TRELLIS TO BE SIMILAR TO NO 37 WITH PLANTER TRAYS ON ROOF OF CLIPBOARD - TO CONTAIN ARTIFICIAL PLANTS

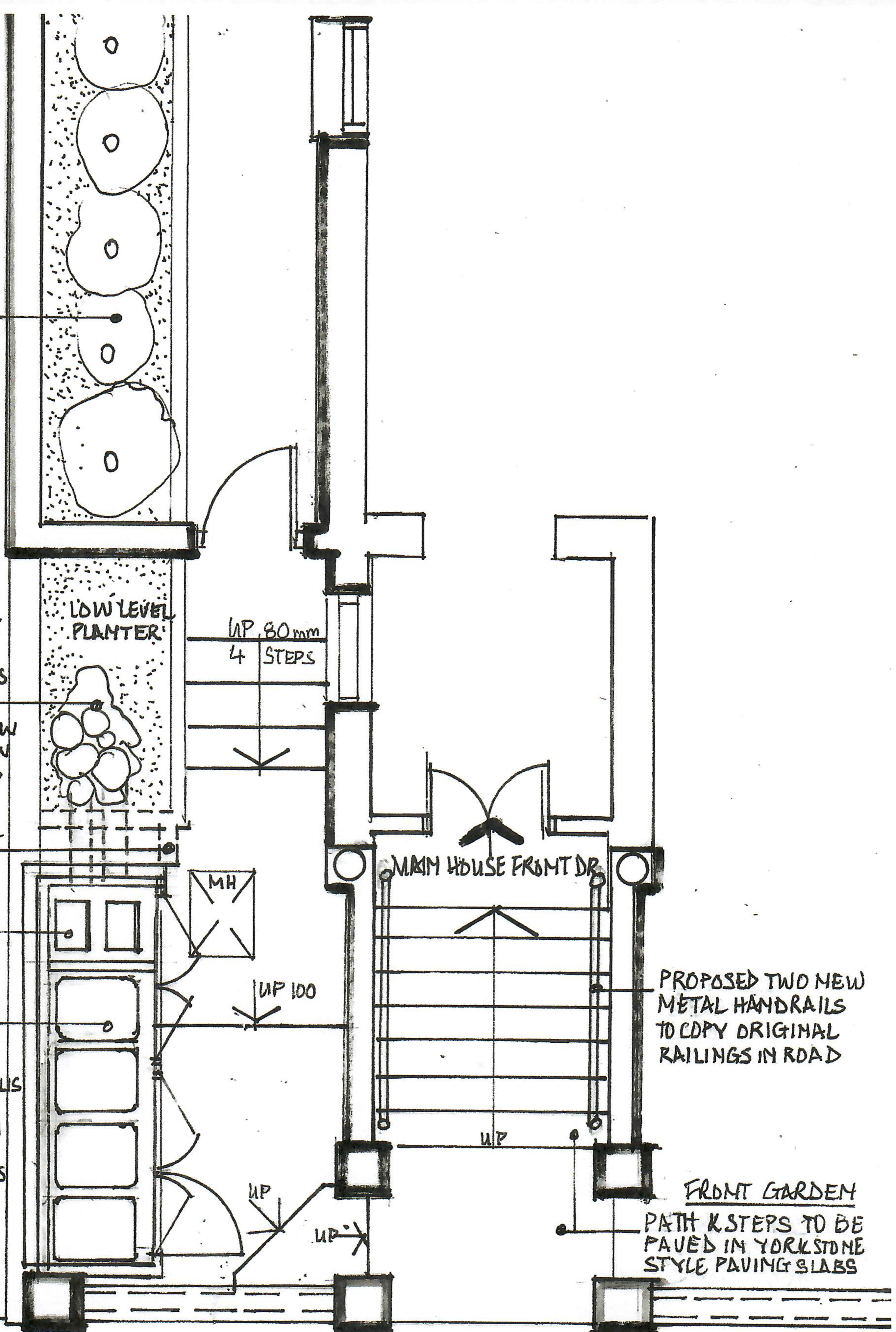

JOB: **41, BUCKLAND CRESCENT
HAMPSTEAD NW3 5DJ**

TITLE: **PROPOSED FRONT GARDEN BIN STORE**

DRWG: **PLAN NEW DUSTBIN CLIPBOARD**

SCALE: **1:50** DATE: **MAY 2023** DRWG NO: **4**

DRAWN: **INDIGNERS PLANNING & DESIGN PARTNERSHIP LTD**

SCALE BAR: 0 1 2 METRES @ 1:50