

1 **Illustrative Section 04**
1 : 100

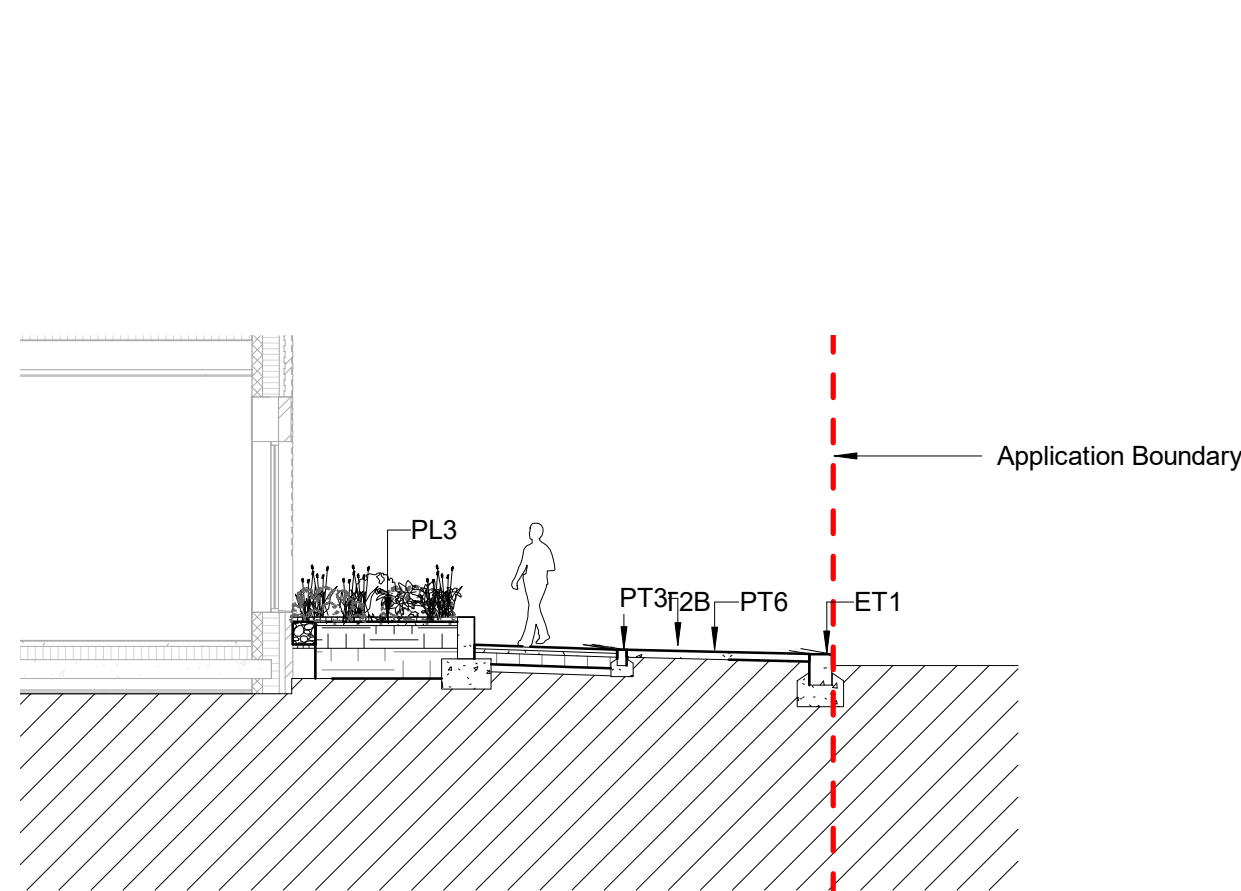

2 **Illustrative Section 05**
1 : 100



3 **Illustrative Section 06**
1 : 100

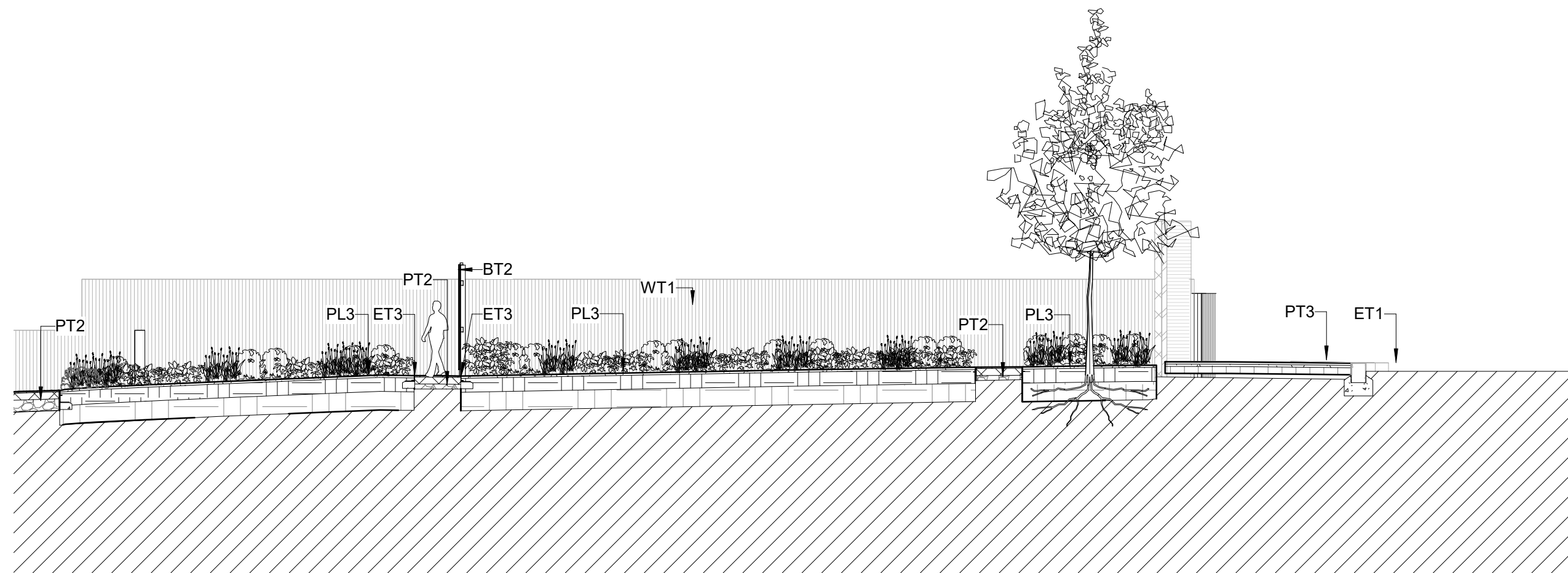

4 **Illustrative Section 07**
1 : 100

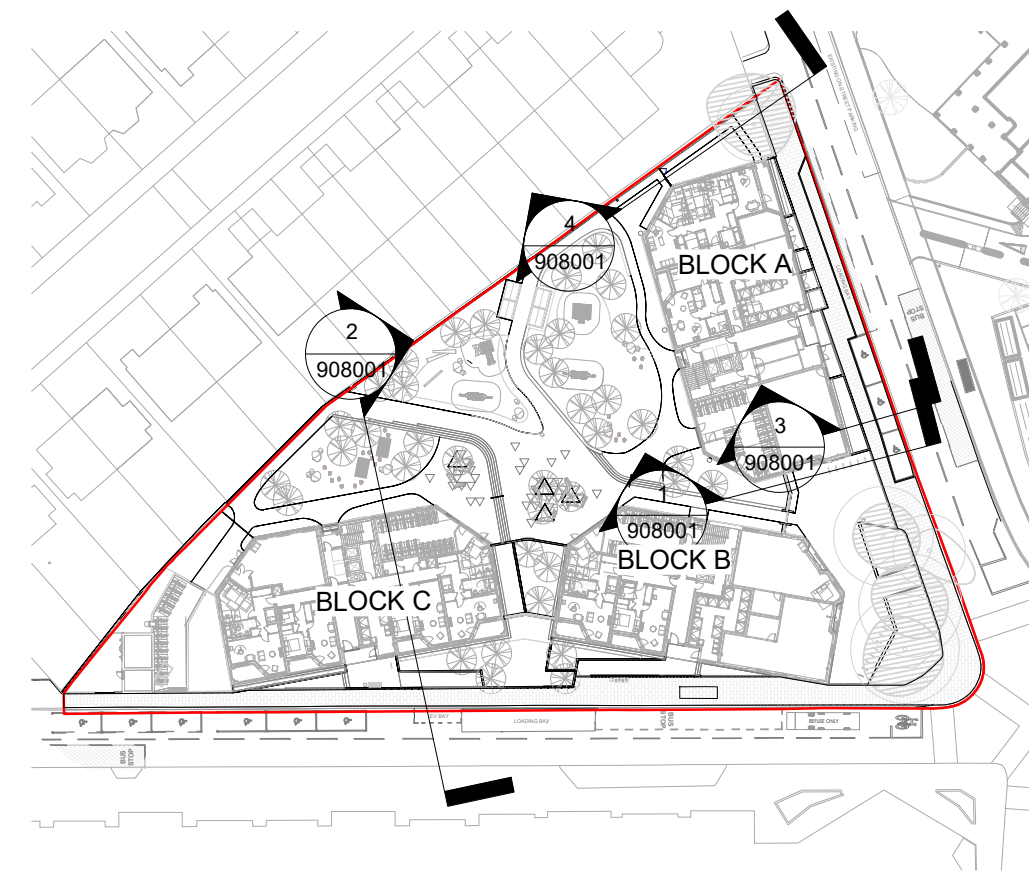

- KEY:
- PT1 Paving Type 1: Clay brick paver
 - PT2 Paving Type 2: Resin bound gravel
 - PT3 Paving Type 3: Adoptable highway paving to Highway Engineer's design and specification
 - PT4 Paving Type 4: Salvaged site-won paving features
 - PT5 Paving Type 5: Cedec self binding gravel to tree pits
 - PT6 Paving Type 6: Granite setts to Highway Engineer's design and specification
 - PT7 Paving Type 7: Brick steps
 - PT8 Paving Type 8: 300mm gravel strip to building facade
 - WT1 Wall Type 1: Existing brick wall retained
 - WT2 Wall Type 2: Existing brick wall to be made good or replaced
 - WT3 Wall Type 3: Brick wall to match Architectural brickwork proposals, 215mm width
 - WT4 Wall Type 4: Brick wall to match Architectural brickwork proposals, 440mm width
 - WT5 Wall Type 5: Concrete wall to courtyard entrance
 - BT1 Boundary Type 1: Ornamental railings to brick wall
 - BT2 Boundary Type 2: Close board timber fence
 - BT3 Boundary Type 3: Handrail to steps
 - BT4 Boundary Type 4: Indicative railings to Architect's design and specification
 - G1 Gate Type 1: Ornamental metal gate
 - G2 Gate Type 2: Timber gate with secure locking mechanism
 - ET1 Edge Type 1: Highway road kerb to Highway Engineer's design and specification
 - ET2A Edge Type 2A: Flush kerb
 - ET2B Edge Type 2B: Flush kerb to Enginner's details and specification
 - ET3 Edge Type 3: Metal edging
 - ET4 Edge Type 4: Raised kerb to planting area
 - DR1 Drainage Type 1: Channel drain
 - DR2 Drainage Type 2: Slot drain to building threshold
 - DR3 Drainage Type 3: Indicative rainwater butts to Architect's details
 - FT1 Furniture Type 1: Salvaged bench feature
 - FT2 Furniture Type 2: Timber bench
 - FT3 Furniture Type 3: Litter bins
 - FT4 Furniture Type 4: London cycle stands
 - FT5 Furniture Type 5: Cargo bike cycle store
 - PE1 Play Type 1: Play hut type 01
 - PE2 Play Type 2: Play hut type 02
 - PE3 Play Type 3: Balancing beam
 - PE4 Play Type 4: Stepping logs
 - PE5 Play Type 5: Hammock
 - PE6 Play Type 6: Play boulders
 - PE7 Play Type 7: Play tree trunk
 - PE8 Play Type 8: Timber play platform
 - H1 Proposed hedge to private terraces, 800mm height
 - PL1 Proposed species rich lawn to central courtyard
 - PL2 Proposed rain garden to central courtyard
 - PL3 Proposed shrub planting
 - PL4 Proposed ground cover planting

- Notes
- This drawing is the property of fabrik ltd. It must not be copied or reproduced without written consent.
 - Only figured dimensions are to be taken from this drawing. All contractors must visit site and be responsible for taking and checking all dimensions related to the works shown on the drawing.
 - The original of this drawing has coloured lines. Do not rely on the monochrome copy.

No.	Date	Reason	Name
Revisions			
P2	31/01/2023	Stage 4a Issue	XL
P1	02/12/2022	Stage 4a Preliminary Issue for Comments	XL

fabrik

First Floor
4-8 Emerson Street
London
SE1 9DU

T : 0207 620 1453
F : 0207 261 9126
E : london@fabrikuk.com
W : www.fabrikuk.com

Project
**ABBEE AREA PHASE 3 for
WATES**

Drawing
Landscape Sections Sheet 2

Scale	Date	Approved	Checked	Drawn
As indicated@A1	31/01/23	MB	DY	XL

Project No.	Drawing No.	Revision
D2857, ARP3	ARP3-FAB-ZZ-00-DR-L-908001	P2

- | | |
|---|--|
| <input checked="" type="checkbox"/> Preliminary | <input type="checkbox"/> Issued for Design/Information |
| <input type="checkbox"/> Issued for Planning Approval | <input type="checkbox"/> Issued for Tender |
| <input type="checkbox"/> Issued for Construction | <input type="checkbox"/> As Built |

Drawing sheet size - A1

Copyright Reserved (C)