

1 Typical PT1 Clay Pavers Details - Plan
1 : 10

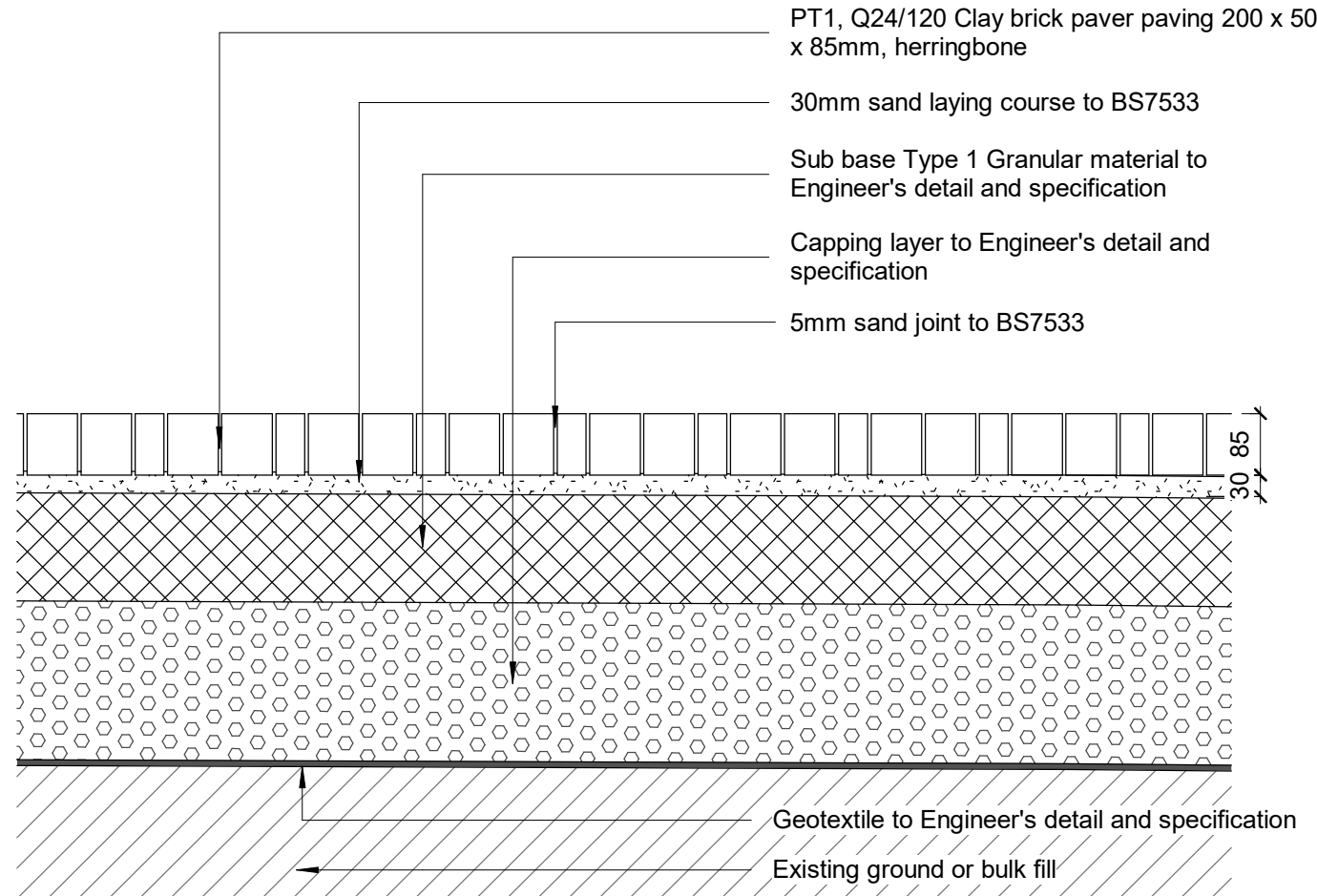

2 Typical PT1 Clay Paver Details - Section
1 : 10

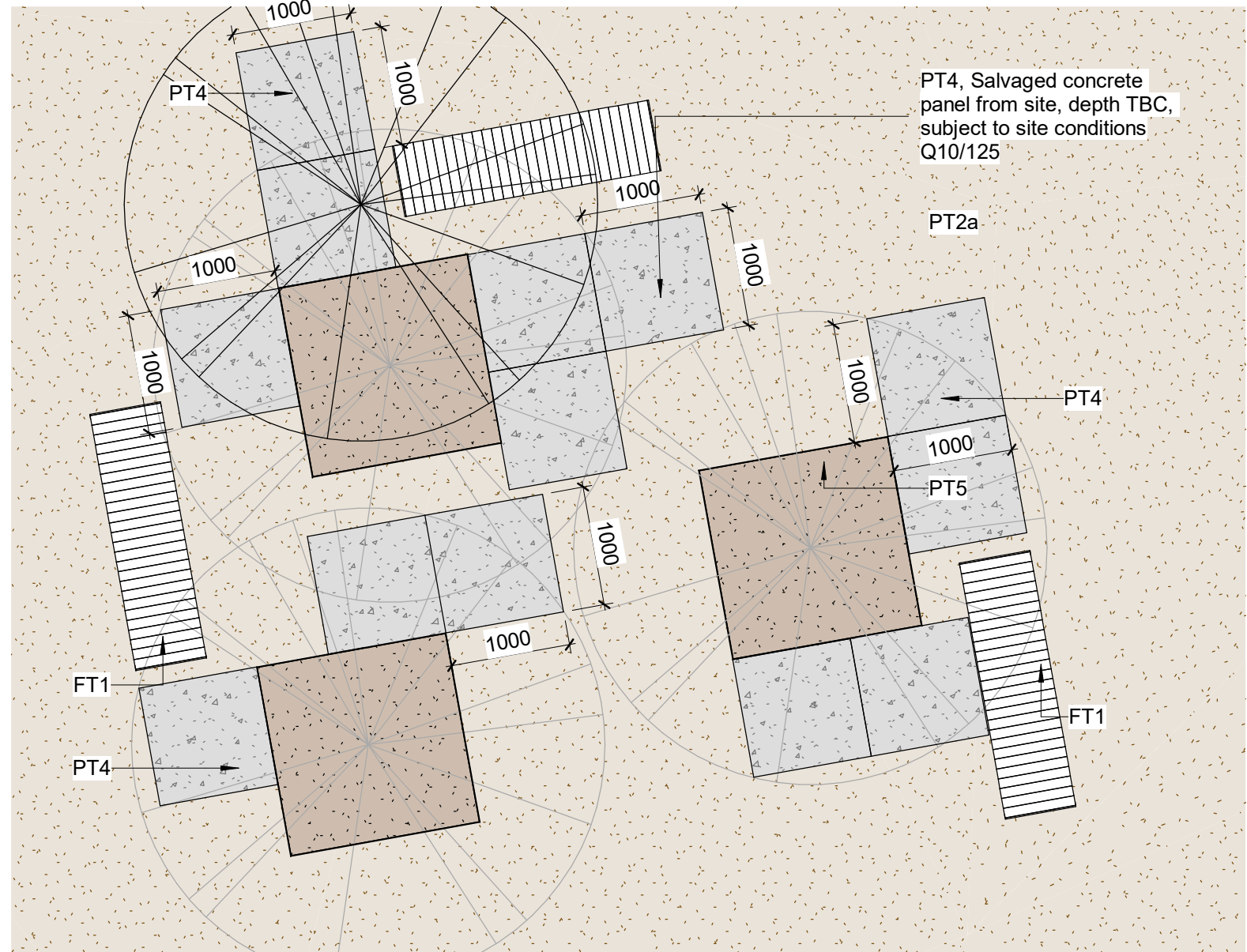

6 Typical PT4 Salvaged Site-won Feature Paving Plan
1 : 50

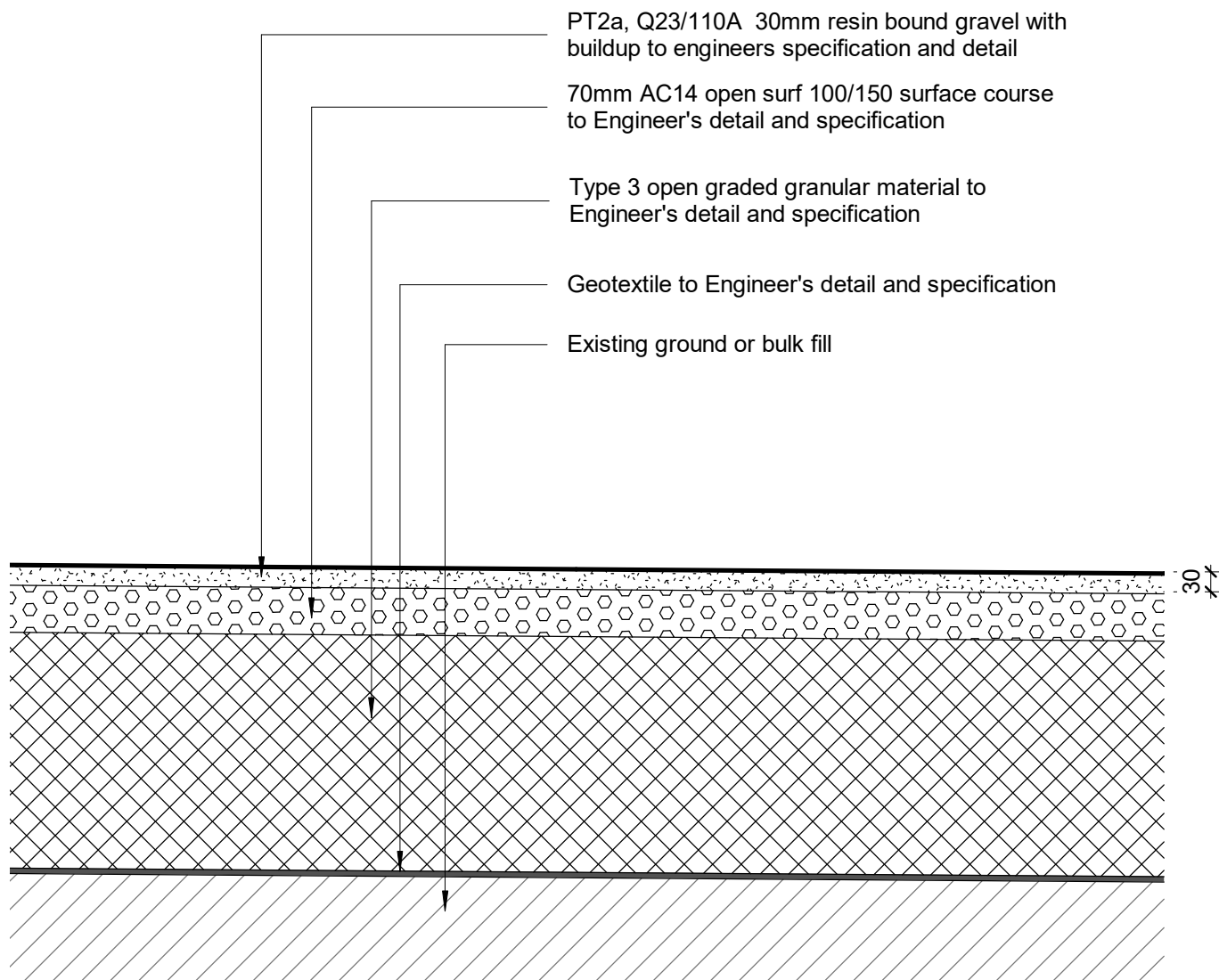

3 Typical PT2a Resin Bound Gravel Details
1 : 10

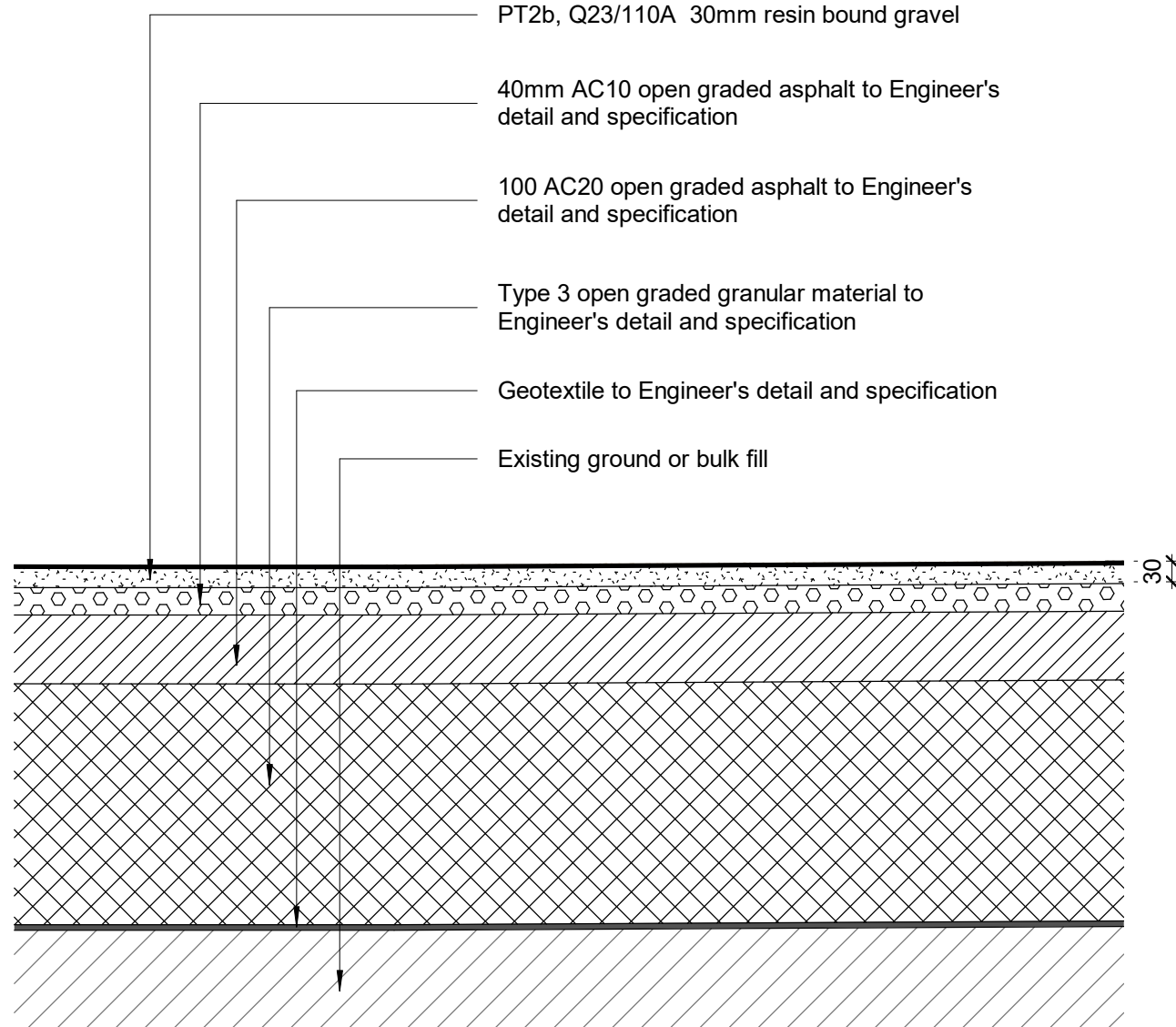

8 Typical PT2b Resin Bound Gravel Details
1 : 10

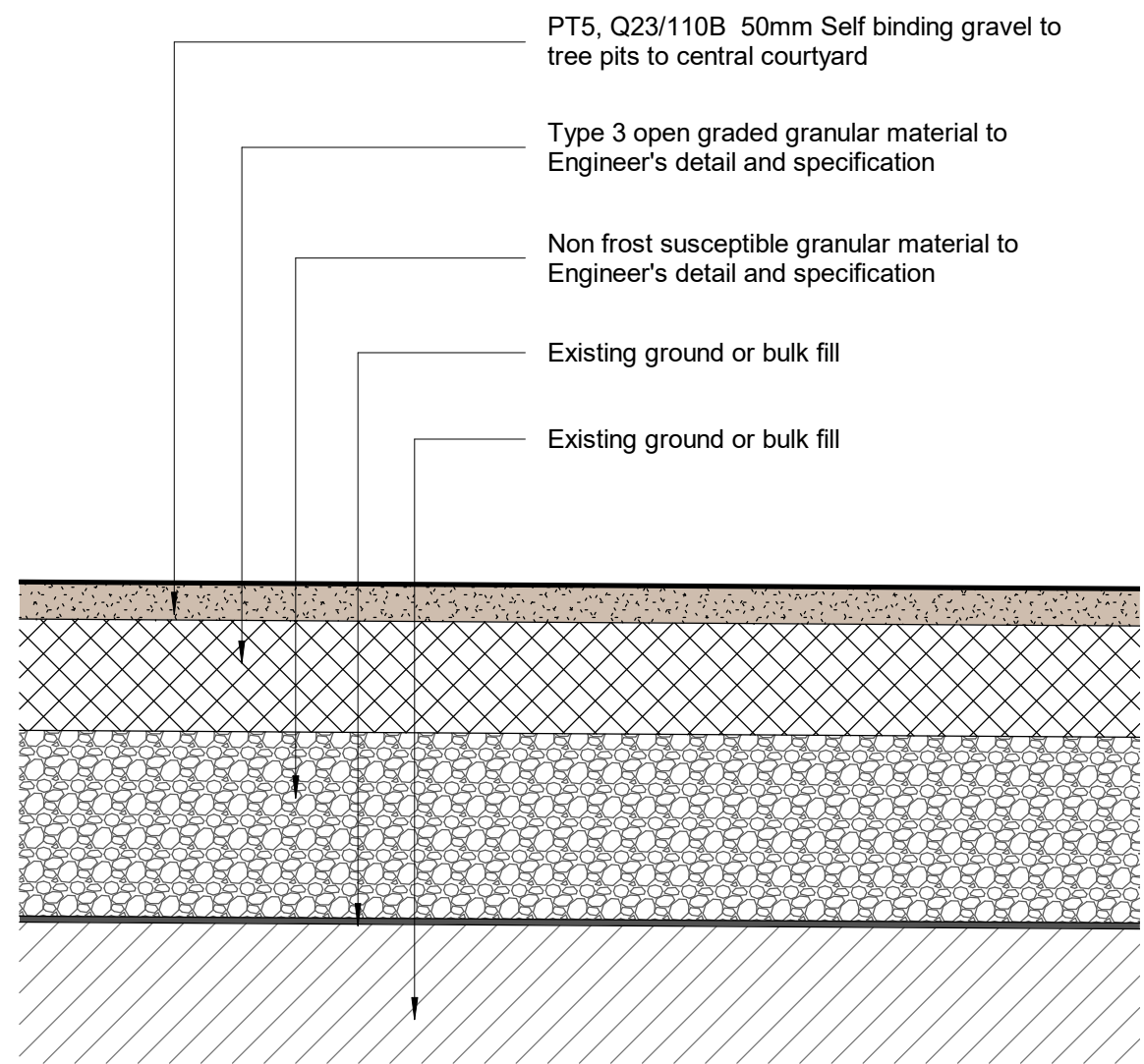

4 Typical PT5 Self Binding Gravel Details
1 : 10

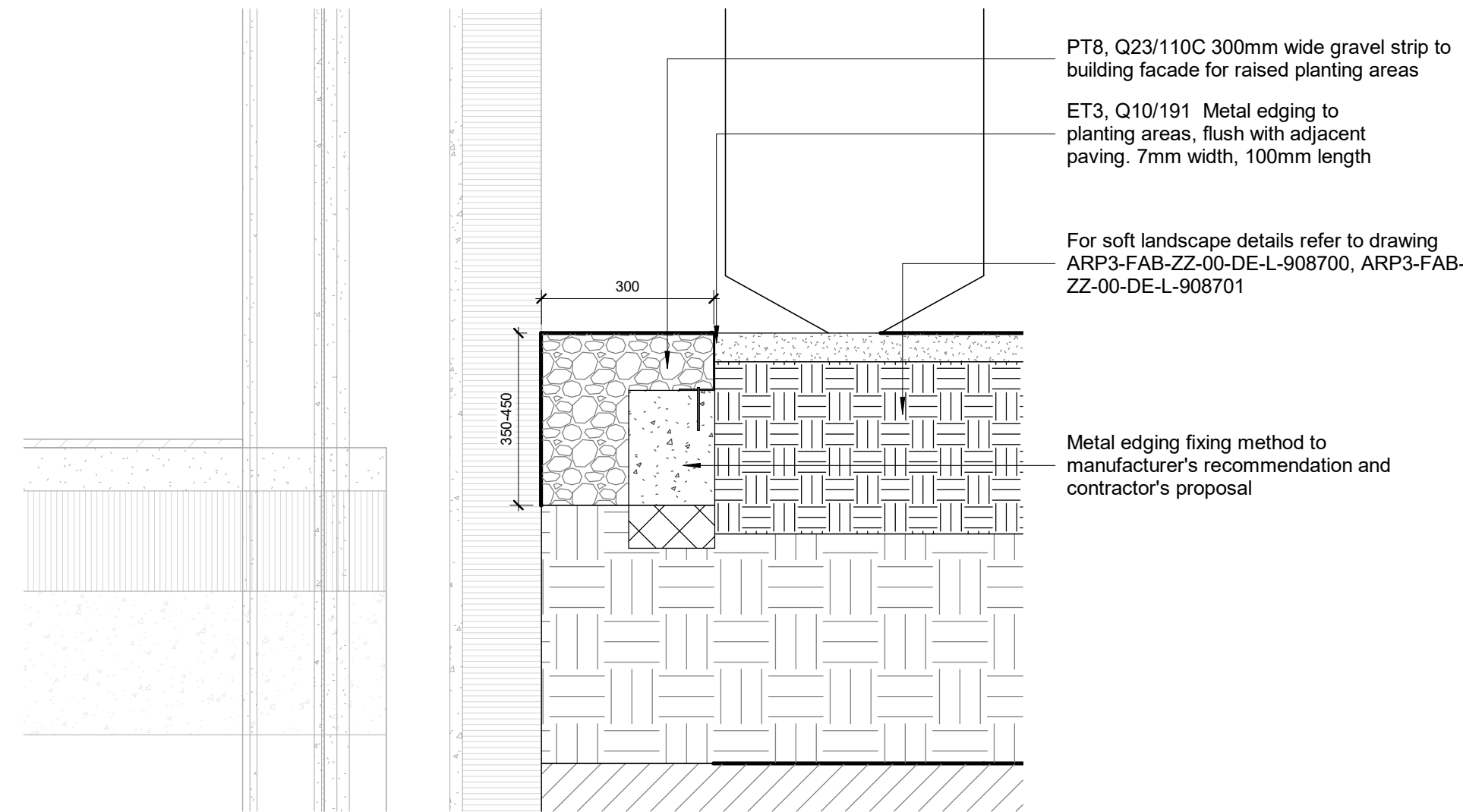

5 Typical PT8 Gravel Strip to Building Facade Details
1 : 10

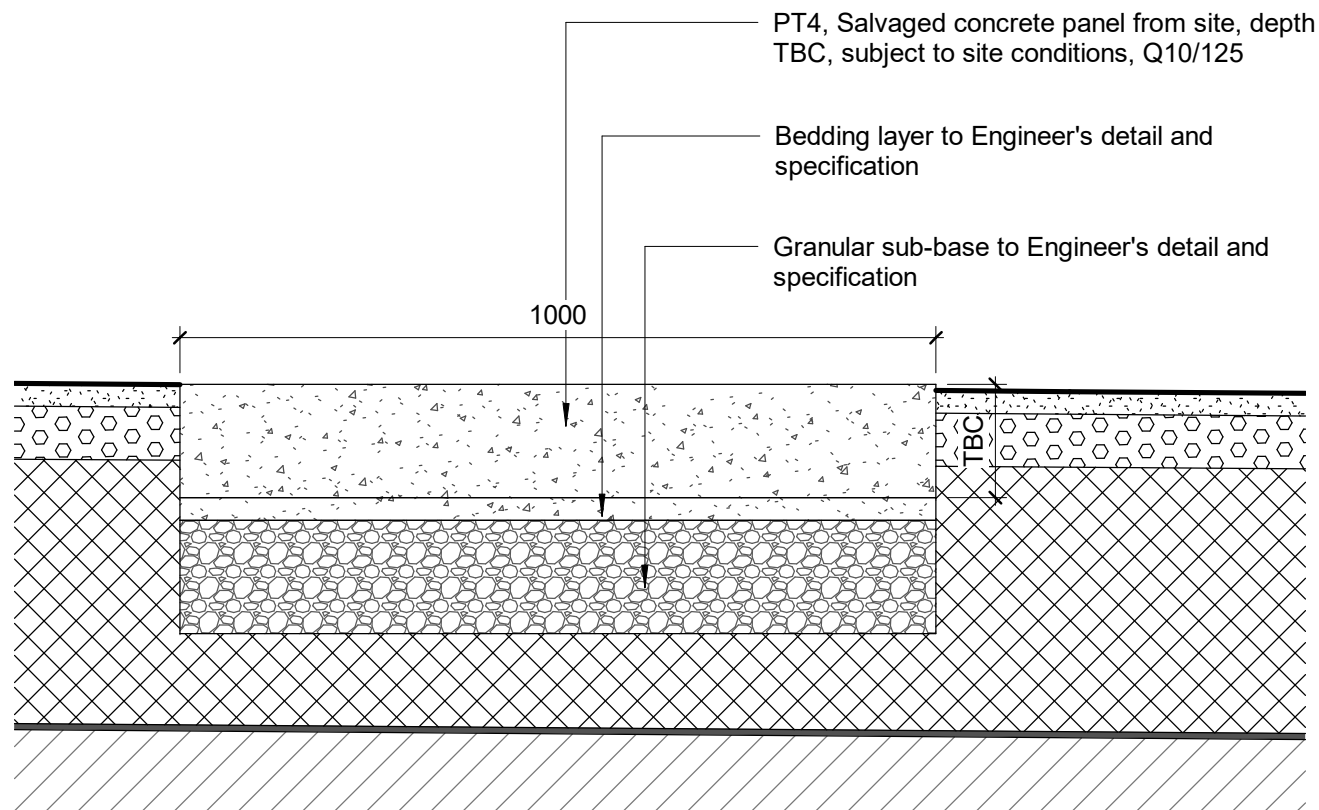

7 Typical PT4 Salvaged Site-won Feature Paving Details
1 : 10

- KEY:
- PT1 Paving Type 1: Clay brick paver
 - PT2a Paving Type 2a: Resin bound gravel (No vehicular loading)
 - PT2b Paving Type 2b: Resin bound gravel (Occasional maintenance vehicle loading)
 - PT3 Paving Type 3: Adoptable highway paving to Highway Engineer's design and specification
 - PT4 Paving Type 4: Salvaged site-won paving features
 - PT5 Paving Type 5: Cedec self binding gravel to tree pits
 - PT6 Paving Type 6: Granite setts to Highway Engineer's design and specification
 - PT7 Paving Type 7: Brick steps
 - PT8 Paving Type 8: 300mm gravel strip to building facade

- NOTES
- All detail drawings to be read in conjunction with Landscape GA Plans, NBS Specification and Soft landscape schedules.
 - All products to be installed to manufacturer's recommendations
 - For all buildings to landscape finishes to Civil Engineer's detail and specification.
 - All masonry to be F2 S2 as per Structural Engineer's recommendations.
 - All coping bricks to be F2 S2 as per Structural Engineer's recommendations.
 - All mortar to be M12 as per Structural Engineer's recommendations.
 - Use bucket handle or weather-struck mortar jointing.
 - All foundations to landscape retaining walls to Structural Engineer's detail and specification, and to Contractor's proposals.
 - All footings and foundations to landscape furniture, play equipment to manufacturer's recommendations and to Contractor's proposals.
 - All fixing method to fences, railings, handrails, furniture, play equipment to manufacturer's recommendations.

- Notes
- This drawing is the property of fabrik ltd. It must not be copied or reproduced without written consent.
 - Only figured dimensions are to be taken from this drawing. All contractors must visit site and be responsible for taking and checking all dimensions related to the works shown on the drawing.
 - The original of this drawing has coloured lines. Do not rely on the monochrome copy.

No.	Date	Reason	Name
P4	19/05/2023	Stage 4A Issue - Salvaged bench and sculpture removed	JC
P3	24/02/2023	Stage 4A Issue - Comments Incorporated	XL
P2	31/01/2023	Stage 4a Issue	XL
P1	22/12/2022	Stage 4a Preliminary Issue for Comments	XL

fabrik

First Floor Studio
The Old School, Exton Street
London
SE1 8UE

T : 0207 620 1453
F : 0207 261 9126
E : london@fabrikuk.com
W : www.fabrikuk.com

Project

ABBEY AREA PHASE 3 for
WATES

Drawing

Typical Landscape Paving Details

Scale	Date	Approved	Checked	Drawn
As indicated@A1	26/10/22	MB	DY	XL

Project No.	Drawing No.	Revision
D2857, ARP3	ARP3-FAB-ZZ-00-DE-L-908100	P4

<input checked="" type="checkbox"/> Preliminary	<input type="checkbox"/> Issued for Design/Information
<input type="checkbox"/> Issued for Planning Approval	<input type="checkbox"/> Issued for Tender
<input type="checkbox"/> Issued for Construction	<input type="checkbox"/> As Built

Drawing sheet size - A1

Copyright Reserved (C)