

© Julian Harrap Architects
 All rights described in Chapter IV of the Copyright, Designers and Patents Act 1998 have been asserted.

All levels are in metres above Ordnance Datum.

All dimensions should be checked on site. Do not scale from this drawing. This drawing is for reference and information only. Any discrepancies should be reported to project lead.

To be read in conjunction with the submitted design and access statement and other associated reports.

NOTES & KEY :

- Proposed Strip-Out in red
- New / Proposed Elements

LOCATION KEY @ NTS :

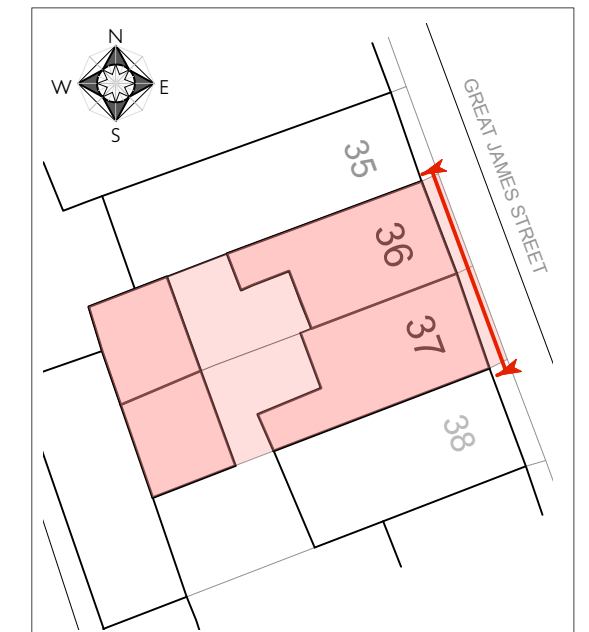

SCALE BAR - 1 : 100 @ A3

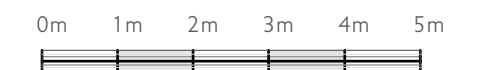

Brickwork repairs to former outlets as necessary, using second-hand bricks and tuck pointing to match existing adjacent.

New cast lead RWP Hoppers, early-Georgian style, in-keeping with the front facade. *Ref. to 645a/PA09*

Brickwork repairs (behind pipework only) to where damage was caused by fixings and water leakage and over-saturation. Given the extent of damage, proposed cleaning and repair works entail:

- 1) One Doff steam clean throughout, working from top to bottom of elevation (section behind the pipes).
- 2) One Torc or Jos clean to heavily affected areas only, working from top to bottom of elevation at medium pressure ~1.5 bar
- 3) Spot treatment with Efflorescence B and Detergent 600 treatment plus rinse-off to agreed areas affected by efflorescence (section behind the pipes only).
- 4) Carefully cut-out and re-face areas of damaged brickwork (assume 40-50% of the area, affected by heavy efflorescence, loss of brick face or damaged by RWP fixings (section behind the pipes only).
- 5) Carefully piece in matching second-hand or specially-made, matching plum stocks and soft red bricks (LAMBs or similar).
- 6) Rake out all modern, cementitious pointing to masonry (section behind the pipes only). Re-point in soft lime mortar and traditional Tuck pointing, colour to match existing adjacent.

New 100mm diameter lead rain water pipe to No.37 only

New 100mm diameter lead rain water pipe to No.36 only

PROPOSED FRONT ELEVATION @ 1: 100
 PROPOSED RE-INSTATEMENT OF THE RAIN WATER PIPES AND HOPPERS

36 & 37 GREAT JAMES ST
 BLOOMSBURY WC1N

DRAWING TITLE	DRWG	645a/PA05A
Front Elevation - Proposed	SCALE	1:100 @ A3
location of the two	DATE	JULY 2022
re-instated rain water pipes		

JULIANHARRAP
 ARCHITECTS LLP

95 KINGSLAND ROAD LONDON E2 8AG
 PHONE 020 7729 5111 www.julianharraparchitects.co.uk