

Indicative Detail 11: Room 234A & Corridor 2C04, 2F

Proposed galvanised conduit will run along the wall slightly above the door. The location of the penetrations (P7, 8 & 9), LWGs, and cable route (indicated by the red dotted line) will be confirmed by the specialist contractor during the construction phase.

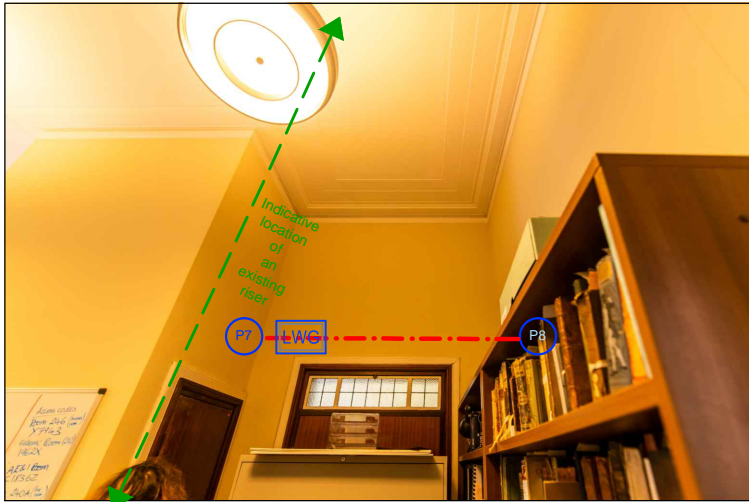

An existing riser in 234A (looking west) and the approximate locations of the proposed conduit and penetrations (subject to specialist contractor). All devices shown are indicative of locations only. Not to scale.

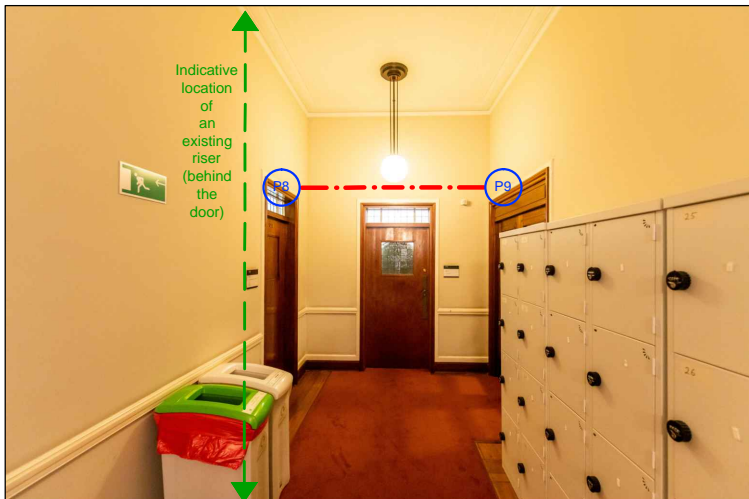

Looking west from Corridor 2C04, showing the approximate route of the proposed galvanised conduit (subject to specialist contractor).

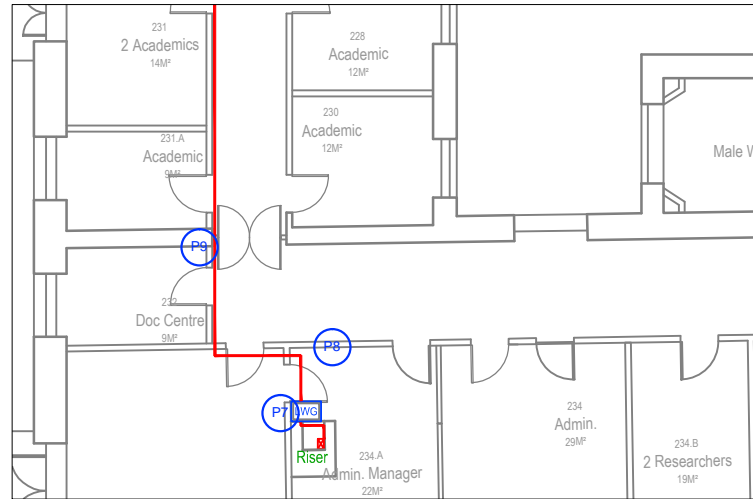

Floorplan showing the devices and associated cabling works to be installed in this location.



Proposed LWG to be installed. For further details of this device, please refer to Appendix 5 of the heritage, design & access statement.

Notes

1. This drawing is an Outline Design showing the relative location of the proposed devices. The final locations of the proposed devices are subject to the final assessment to be carried out by the specialist contractors once listed building consent has been granted.
2. If the proposal materially differs from the outline design included here, a new LBC application will be submitted. Additional details can be provided as a Discharge of Condition if required.
3. This drawing indicates design intent only and shall not be used as an installation or working drawing.

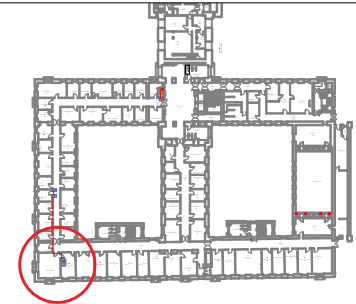

Key

- Existing device to be removed
- ↔ Indicative location of the existing riser
- Proposed galvanised conduit
- DRRU Proposed Disabled Refuge Remote Unit
- LWG Proposed Loop-Powered Wireless Gateway
- ⚡ Proposed Sounder (& Beacon)
- P Proposed penetration

JOB TITLE

Senate House Library
University of London

DRAWING TITLE

INDICATIVE DETAIL (Proposed)

Detail 11

JOB No	DWG No	REV
N2865	411	A
DRAWN BY	CHECKED BY	SCALE (@A4)
DYT	NS	N/A
		DATE
		May/23

STEPHEN LEVRANT
HERITAGE ARCHITECTURE



62 British Grove, London, W4 2NL
E-mail: info@heritagearchitecture.co.uk T: 020 8748 5501