

**1 TEMPLEWOOD AVENUE, HAMPSTEAD**  
 TEM\_003 rev B SOFT LANDSCAPE PLAN (Stage 3)

Date: 19/05/2023 Scale: 1:100 @ A2

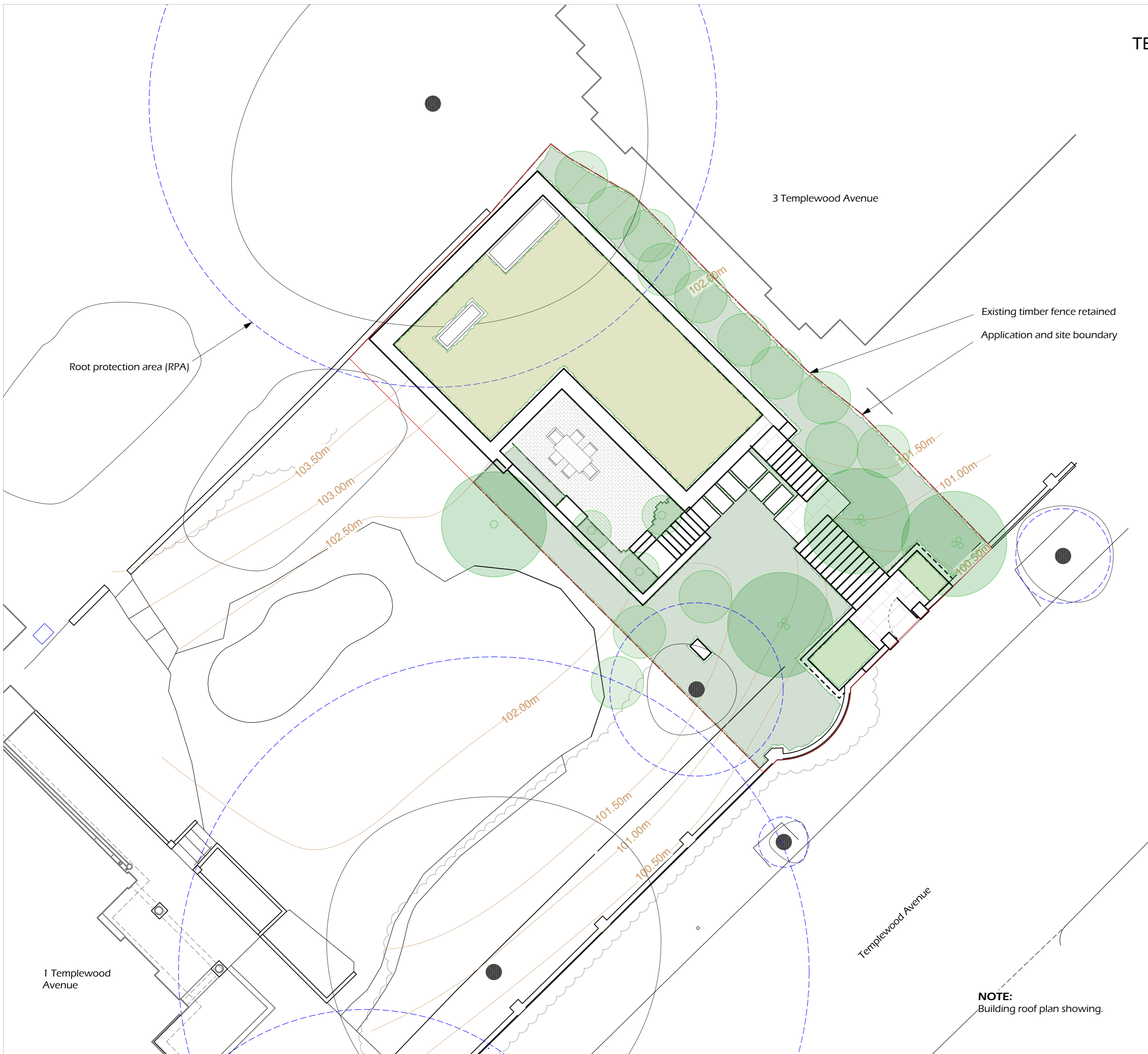

eg.

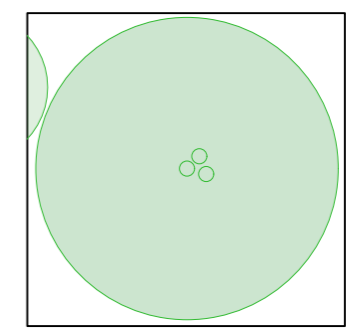

Hamamelis intermedia 'Diane' (3m tall multi-stem)

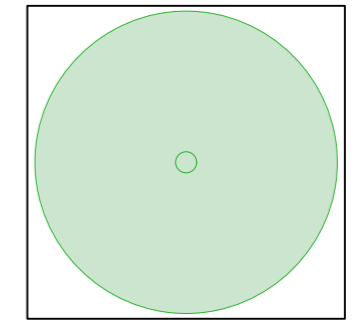

Styrax japonicus (3m standard)

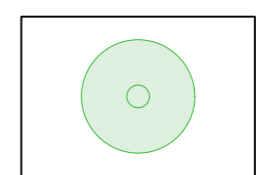

Dicksonia antarctica (3m tall)

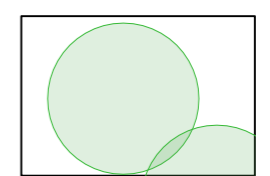

**Shrubs** eg.  
 Euonymus europaeus (10L)  
 Rosa canina (3L)  
 Sambucus nigra (3L)  
 Viburnum opulus (10L)

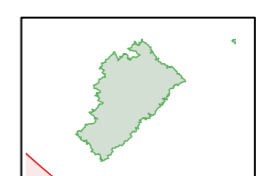

**Ground Cover / Herbaceous** eg.  
**AROUND HOUSE**  
 Viola riviniana (1L)  
 Vinca difformis (1L)  
 Luzula nivea (3L)  
 Digitalis purpurea (1L)  
 Geranium macrorrhizum 'Ingwersen's' (1L)  
 Dryopteris erythrosora (3L)  
 Dryopteris wallichiana (3L)  
 Anemone x hybrida 'Honorine Jobert' (1L)  
 Cyclamen hederifolium (bulb)  
 Eranthis hyemalis (bulb)

**COURTYARD / STEPPING STONES**  
 Aquilegia 'Ruby Port' (1L)  
 Dryopteris cristata (3L)  
 Blechnum spicant (3L)  
 Ficaria verna (1L)  
 Lamium maculatum 'Beacon Silver' (1L)  
 Mentha requienii (1L)  
 Saxifraga x geum (1L)  
 Heuchera villosa (1L)  
 Cyclamen coum (bulb)

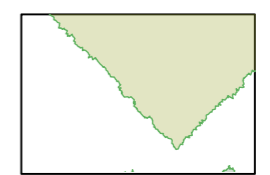

**Green Roof** eg.  
**HOUSE**  
 Thymus pulegioides 'Aureus' (1L)  
 Thymus vulgaris (1L)  
 Thymus serpyllum (1L)  
 Thymus doerfleri (1L)  
 Tulipa tarda (bulb)  
 Ipheion uniflorum 'Wisley Blue' (bulb)

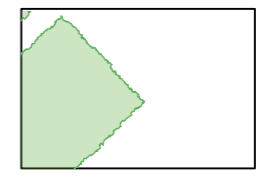

**BIN / BIKE STORE**  
 Sedum (turf / blanket)

**NOTE:**  
 Building roof plan showing.



**SEED** \_landscape design

School House, Countess Of Huntingdon's Chapel, Vineyards, Bath, BA1 5NA  
 +44 (0)1225 424 514 info@seedlandscape.com