

General Notes
 The drawing is copyright of Vabel LTD. All rights reserved. No reproduction in any material form is permitted without consent. Do not scale from this drawing. All dimensions are in mm unless stated otherwise. Dimensions, levels, sizes and location of particulars are to be verified by the contractor on site prior to engaging in works. This drawing may incorporate information from other professionals. Vabel LTD cannot accept responsibility for the integrity and accuracy of such information.

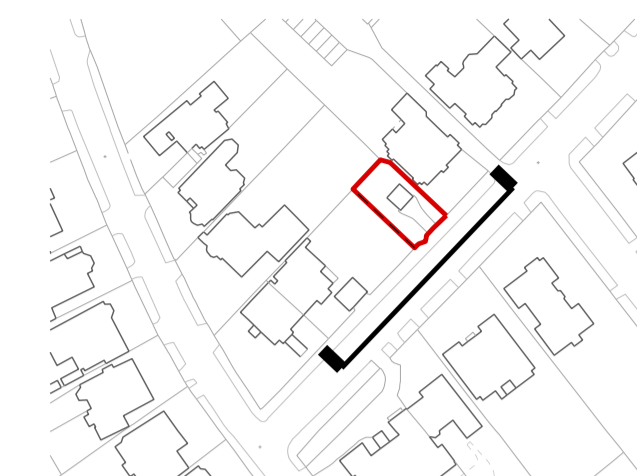

Key

- Proposed site boundary
- 1 Templewood site boundary
- Demolition
- Site Ground excavation for foundations

- Notes:**
1. Topographical information based on Matrix Survey information
 2. Tree locations based on Matrix Survey information in conjunction with Elemental Consultants Tree Survey
 3. For Tree Species and Survey information refer to Elemental Tree Report - 220402_TCS
 4. For tree removal refer to Elemental Arboricultural Impact Assessment - 220402_AIA and Seed Landscaping TEM_005



▲ Entrance
 ▲ Internal Garage Entrance

Overgrown, dead and poor quality trees impacted by the works removed in accordance with the Arboricultural report and Tree Survey - refer to Elemental AIA and Seed Landscapes removal drawing

Existing entrance brickwork removed sufficiently to allow for tooting of new brickwork to match existing

Existing garages and surrounding retaining walls demolished

Existing concrete driveway demolished

← 1a Templewood Avenue No. 1 Templewood Avenue No. 3 Templewood Avenue →

P01	03/05/23	Planning	NE
Rev	Date	Reason for Issue	Chk

VABEL
LONDON

531 Highgate Studios, 53-79 Highgate Road, London NW5 1TL
 Tel +44 (0)20 7183 6405 Email contact@vabel.co.uk

Project
 1 Templewood Avenue

Title
 South East Elevation
 Existing with demolition

Date	Scale @ A1	Drawn	Checked
31/07/19	1:100	BB	NE

Status
 Planning

Drawing Number	Revision
1705_PL_07_120	P01