

GRAYS INN ROAD



BRITANNIA STREET

1 PROPOSED Level 01
1 : 100

GRAYS INN ROAD

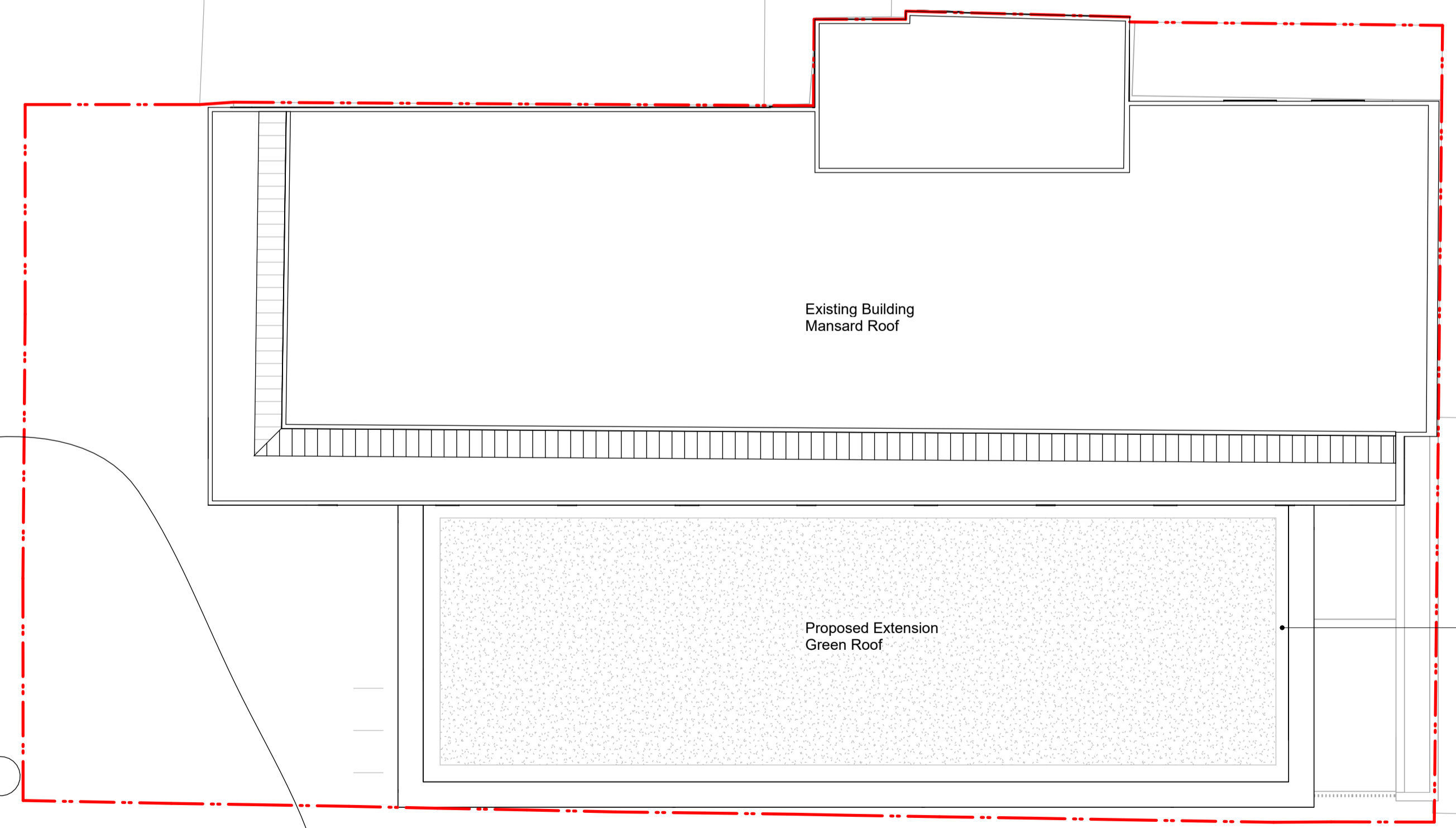

BRITANNIA STREET

2 PROPOSED Roof Plan
1 : 100



REV	DATE	NOTES
PL02	12.05.2023	Issue for Planning
PL01	29.09.2022	Planning

NOTE

- Do not scale from this drawing.
- All dimensions to be checked on site by the contractor and such dimensions to be his responsibility.
- Report all drawing errors, omissions and discrepancies to the architect.
- This document may be issued in an uncontrolled CAD format to enable others to use it as background information to make alterations and/or additions. In that instance the file will be accompanied by a PDF version. It is for those making such alterations and additions to ensure that they make use of current background information. RA accepts no liability for any such alterations or additions to the background information or arising out of changes to background information which occur prior to alterations of additions being made.

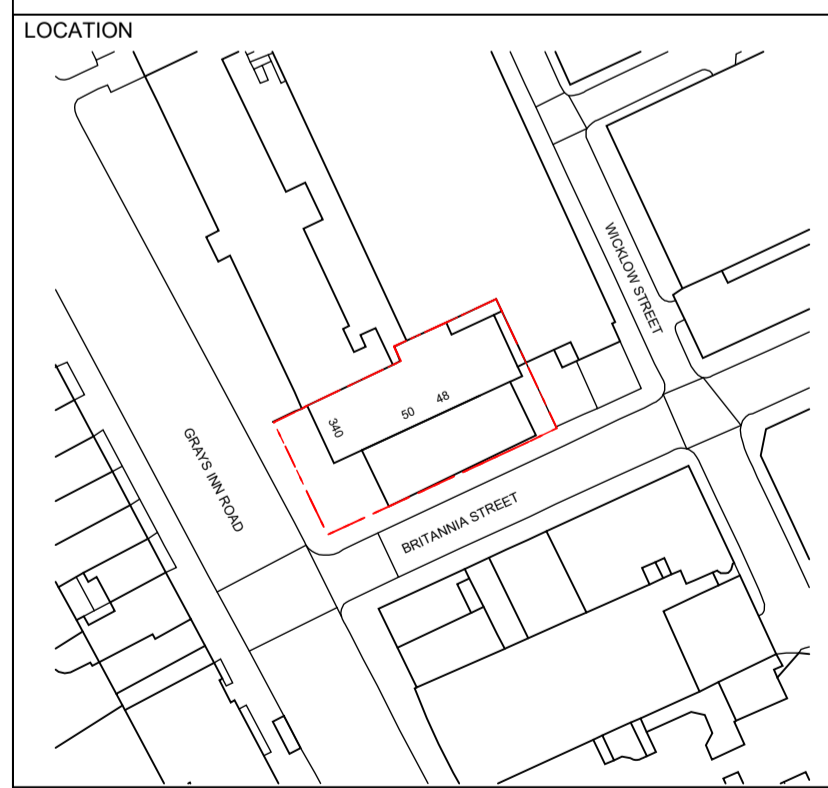

R U F F A R C H I T E C T S

205 WARDOUR ST, LONDON W1F 6ZJ
EMAIL INFO@RUFFARCHITECTS.CO.UK WEB WWW.RUFFARCHITECTS.CO.UK

job title
Grays Inn Road

drawing title / location
Proposed First Floor & Roof Plan

drawn by	checked	scale	status	revision
EY	TP	1:100 @A1	PLANNING	PL02

project originator volume level type role drawing no
GIR-RUF-ZZ-XX-DR-A-00_151