

No.98C to F

No.98B

No.98A Priory Road

No.96

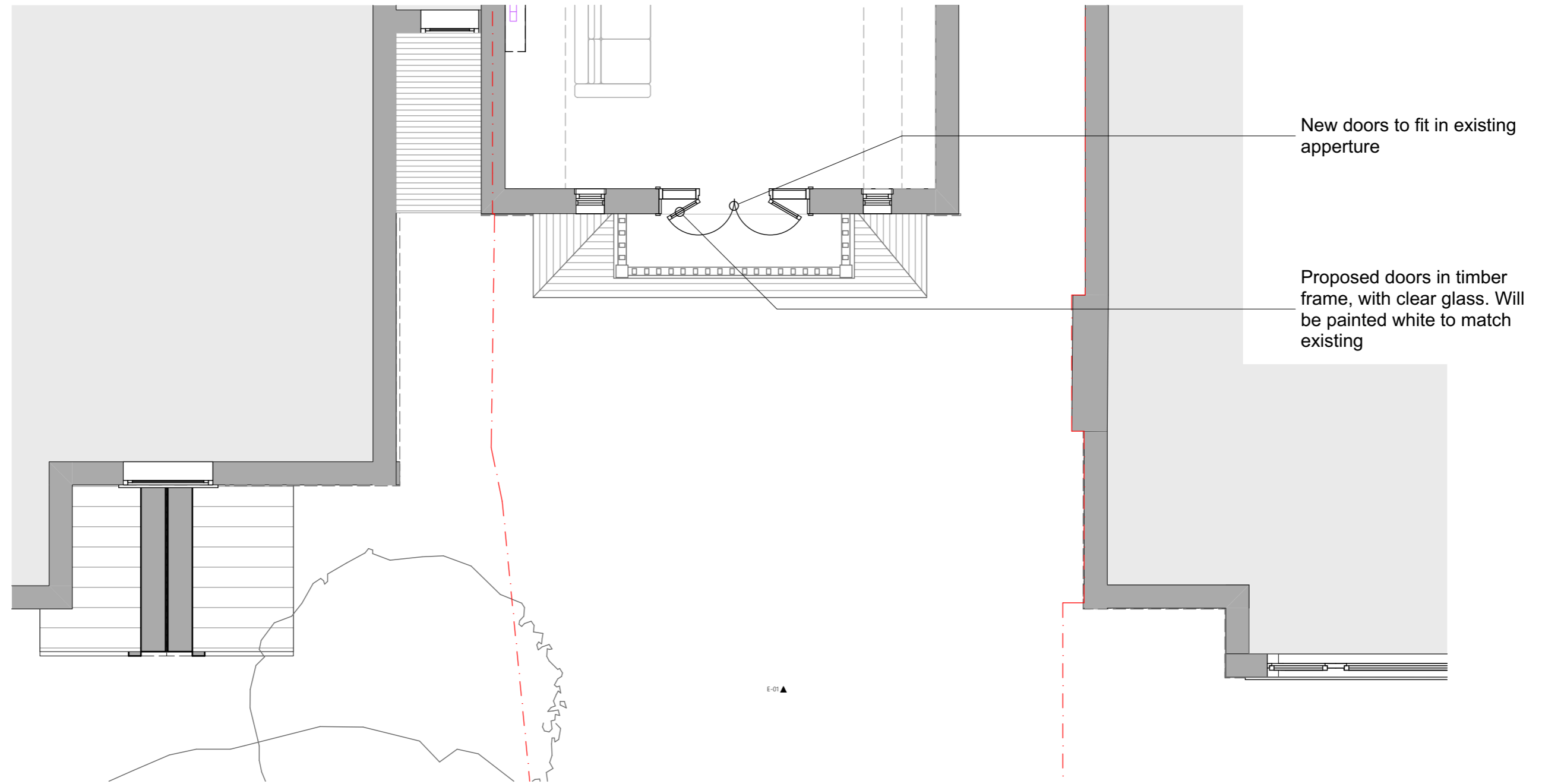

New doors to fit in existing aperture

Proposed doors in timber frame, with clear glass. Will be painted white to match existing

E-01▲



# MWArchitects

110 The Tea Factory  
Endwell Road  
London  
SE4 2LX  
020 7407 6767

© Copyright 2022 - All rights reserved  
Matthew Wood Architects Ltd.

Job Title 98A Priory Road

Job Number 2302

Drawn Corben Lai

Drawing Status  
Planning

Drawing Scale  
1:50 at A3

Created  
22.03.23

Issue Date  
24.05.23

Drawing Name  
Proposed First Floor Plan

Layout ID	Revision
P1.1	A

Revision Notes