

REV	DATE	DESCRIPTION
A	03/05/23	PROPOSED ALTERATIONS AMENDED

NOTES
 1. ALL EXISTING MODERN INTERNAL FLOOR FINISHES IN MAIN ROOMS TO BE REMOVED

KEY:
 - - - - - PROPOSED ALTERATIONS
 PROPOSED ALTERATIONS TO THE FABRIC

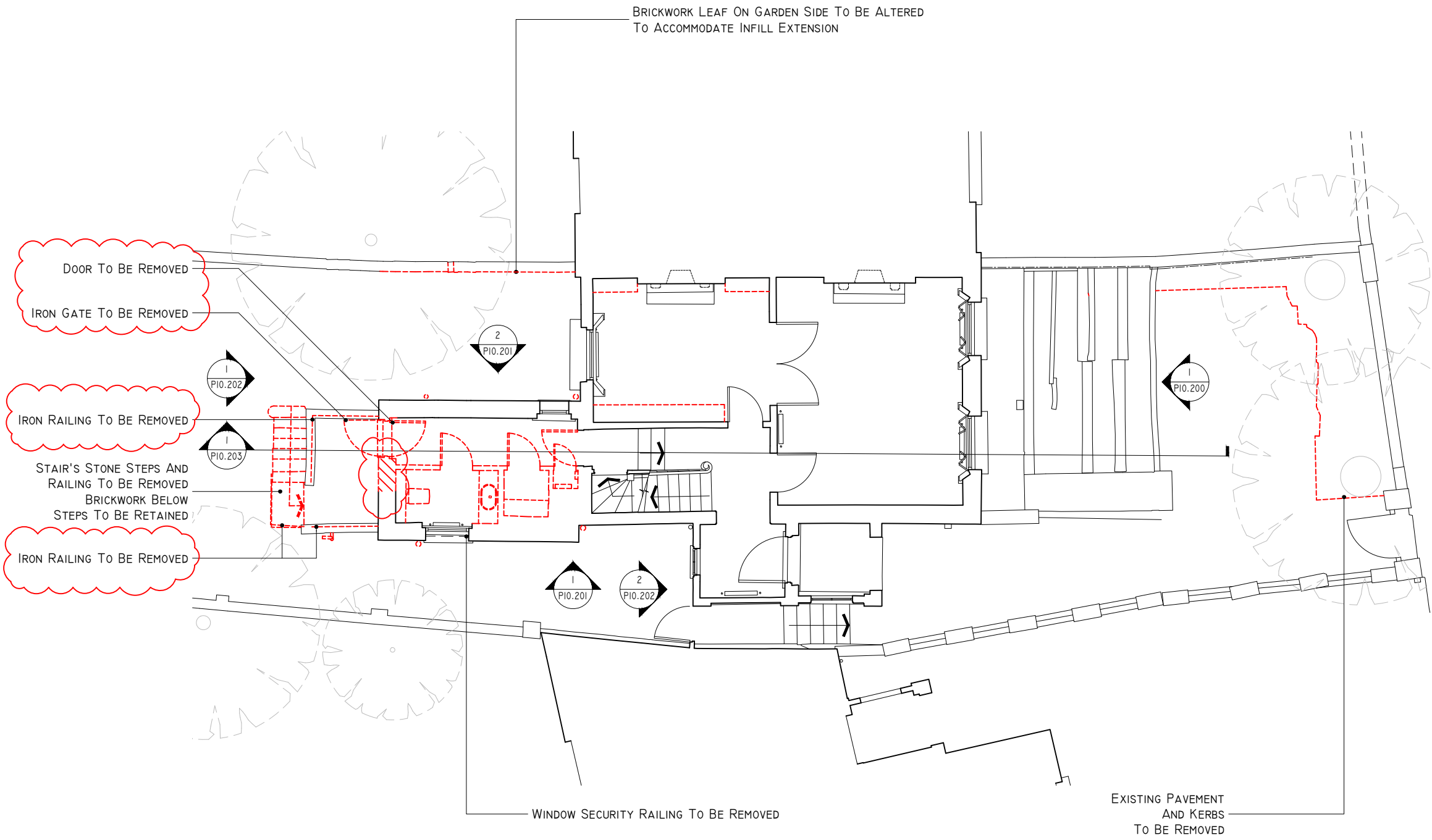

ECHLIN
 THIRD FLOOR
 91 WIMPOLE STREET,
 LONDON W1G 0EF
 +44 (0) 20 7349 9610
 ECHLINLONDON.COM

DO NOT SCALE FROM THIS DRAWING. ALL DIMENSIONS TO BE CHECKED ON SITE PRIOR TO COMMENCEMENT OF ANY WORKS OR PREPARATION OF SHOP DRAWINGS. THE SIZING AND DIMENSIONS OF ALL STRUCTURAL AND SERVICE ELEMENTS MUST ALWAYS BE CHECKED AGAINST THE RELEVANT ENGINEERS' DRAWINGS. THIS DRAWING IS TO BE READ IN CONJUNCTION WITH ALL OTHER CONSULTANTS' INFORMATION. IF THIS DRAWING HAS BEEN TRANSMITTED ELECTRONICALLY, THE ABOVE STATEMENTS ALSO APPLY. © ECHLIN 2015

PROJECT
 35 GLOUCESTER CRESCENT, LONDON, NW1 7DL

DRAWING TITLE
 EXISTING GROUND FLOOR PLAN + ALTERATIONS

STATUS
 ISSUED FOR PLANNING APPLICATION

SCALE	JOB NUMBER	DRAWN BY	CHECKED
1:100 @A3	2124	FP	SC
DRAWING No 2124_A_P10.100		DATE 28.09.2022	REVISION A

1 EXISTING GROUND FLOOR PLAN + ALTERATIONS
 SCALE: 1:100 @A3

