

REV	DATE	DESCRIPTION
A	03/05/23	PROPOSED ALTERATIONS AMENDED

SECTION CALL-OUT ADDED

NOTES

1. ALL EXISTING INTERNAL FLOORS TO BE REMOVED TO ACCOMMODATE PROPOSED FINISH FLOOR LEVEL.
2. ALL INTERNAL DOORS TO BE RETAINED AND DROPPED.

KEY:

----- PROPOSED ALTERATIONS

 PROPOSED ALTERATIONS TO THE FABRIC

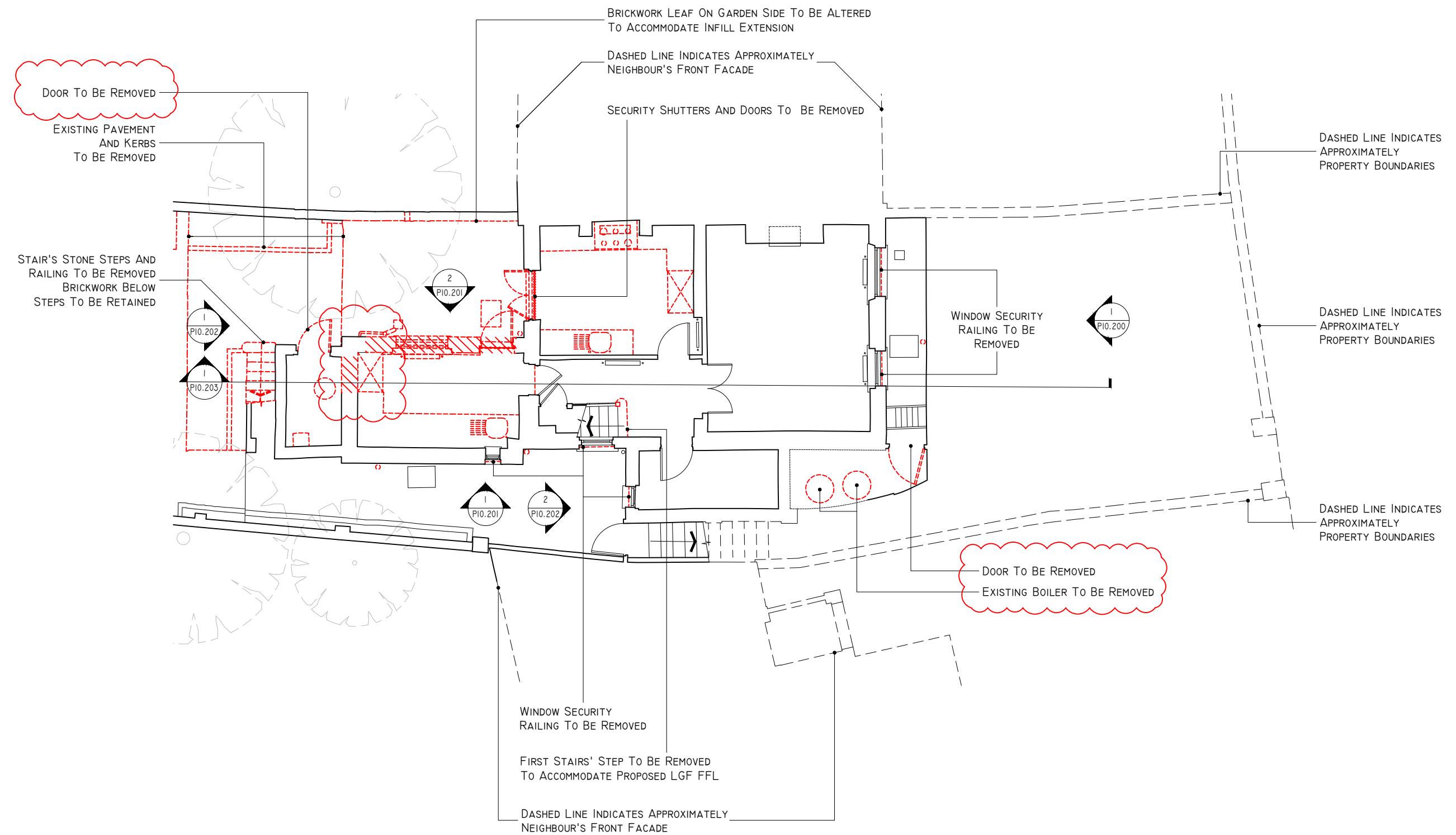

1 EXISTING LOWER GROUND FLOOR PLAN + ALTERATIONS
SCALE: 1:100 @A3

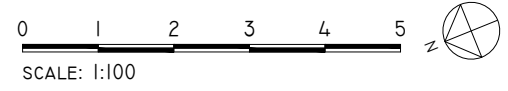

ECHLIN

THIRD FLOOR
91 WIMPOLE STREET,
LONDON W1G 0EF
+44 (0) 20 7349 9610
ECHLINLONDON.COM

DO NOT SCALE FROM THIS DRAWING. ALL DIMENSIONS TO BE CHECKED ON SITE PRIOR TO COMMENCEMENT OF ANY WORKS OR PREPARATION OF SHOP DRAWINGS. THE SIZES AND DIMENSIONS OF ALL STRUCTURAL AND SERVICE ELEMENTS MUST ALWAYS BE CHECKED AGAINST THE RELEVANT ENGINEERING DRAWINGS. THIS DRAWING IS TO BE READ IN CONJUNCTION WITH ALL OTHER CONSULTANTS INFORMATION. IF THIS DRAWING HAS BEEN TRANSMITTED ELECTRONICALLY, THE ABOVE STATEMENTS ALSO APPLY. © 2019 ECHLIN

PROJECT

35 GLOUCESTER CRESCENT, LONDON, NW1 7DL

DRAWING TITLE

EXISTING LOWER GROUND FLOOR PLAN + ALTERATIONS

STATUS

ISSUED FOR PLANNING APPLICATION

SCALE	JOB NUMBER	DRAWN BY	CHECKED
1:100 @A3	2124	FP	SC

DRAWING No	DATE	REVISION
2124_A_P10.099	28.09.2022	A