

- Willow den  
Living willow structure to form a den, 1.6m DIA  
supplied by Hand Made Places osap
- Key continued
- Timber poles  
M+M timber play ready grade poles, 150mm  
DIA x 1.5m high above CL osap
- Sheffield cycle hoops  
Stainless steel cycle hoops  
750mm above ground, root fixed  
osap
- 3m ht Pergola/timber feature  
element by specialist fabricator  
and CE approval- CDP item
- Bins with information plates - 5 no  
Sherwood Litter Bin with Hooded Top  
By Gladson osap
- Bollards - fixed and drop type to  
allow access for maintenance  
vehicles - SS - 140mm dia. 1.1m  
ht, at 1.5m average ctrs
- External Lighting/Power  
All landscape lighting and external power requirements (e.g.  
for irrigation) to be incorporated into MEP engineers  
information, refer to /Kingfisher external lighting package  
(44070). All to Specialist subcontractors CDP package to  
ensure all cabling, supplies and switching is coordinated.
- Steps and wall lighting shown for reference only.  
Hunza square eyelid step/wall lights, copper finish osap. All  
Lights sample to be approved by Client  
Lights set into upstand brick walls (80mm depth) to  
manufacturers specs.
- Drainage  
Drainage elements  
All drainage elements indicated on NTA landscape  
drawings for coord and are taken from P+M information -  
refer to CE drainage plans for full details.
- Gully / Slot Drain Location  
Aco multi drain brick slot MD ST osap to CE  
specification. Refer to latest P+M drawings for all  
drainage details
- Manhole cover levels as P+M given levels  
Refer to PM schedule for covers. All covers in  
paving to be recessed for paving and aligned  
with paving. All covers in soft landscape to be  
round ductile iron.
- General Soft Landscape levels
- Brick wall/ramps and steps with handrail  
details (to match building railings) to Architect  
and structural engineer and contractors CDP  
specialist fabrication drawing for approval
- Woodscape (osap) timber vertical retaining wall  
FSC NVDH hardwood, 65mm depth x 140mm planks  
by length required to manufacturers workshop drawing  
and engineers approval
- For hedging refer to softworks drawings
- All play areas/equipment/surfaces design to  
be reviewed by contractor using suitable  
inspector - e.g. API play.org before  
installation and as part of final design  
/procurement.
- Final drainage design to specialist / CE designs  
All Edge/kerb and Road build up to CE spec and  
approval and drawings
- All dimensions to be checked on site as part  
of site setting out
- Read in conjunction with current plans and  
detail sheets
- All kerbs and retaining edgings to engineers  
specification and drawings
- All final build ups to engineers specification  
and approval and drawings
- All brickwork/walls to engineers/architects  
details/specifications
- All railings/balustrades to  
engineers/architects details/specifications
- All drainage to engineers/architects  
specifications
- All named suppliers/ materials are osap - or  
similar and approved.
- All hardscape materials to be submitted for  
final approval by C Field
- Final fence fixing, layout and configuration  
to contractors CDP item - workshop  
drawings to be submitted for approval and  
client sign off.

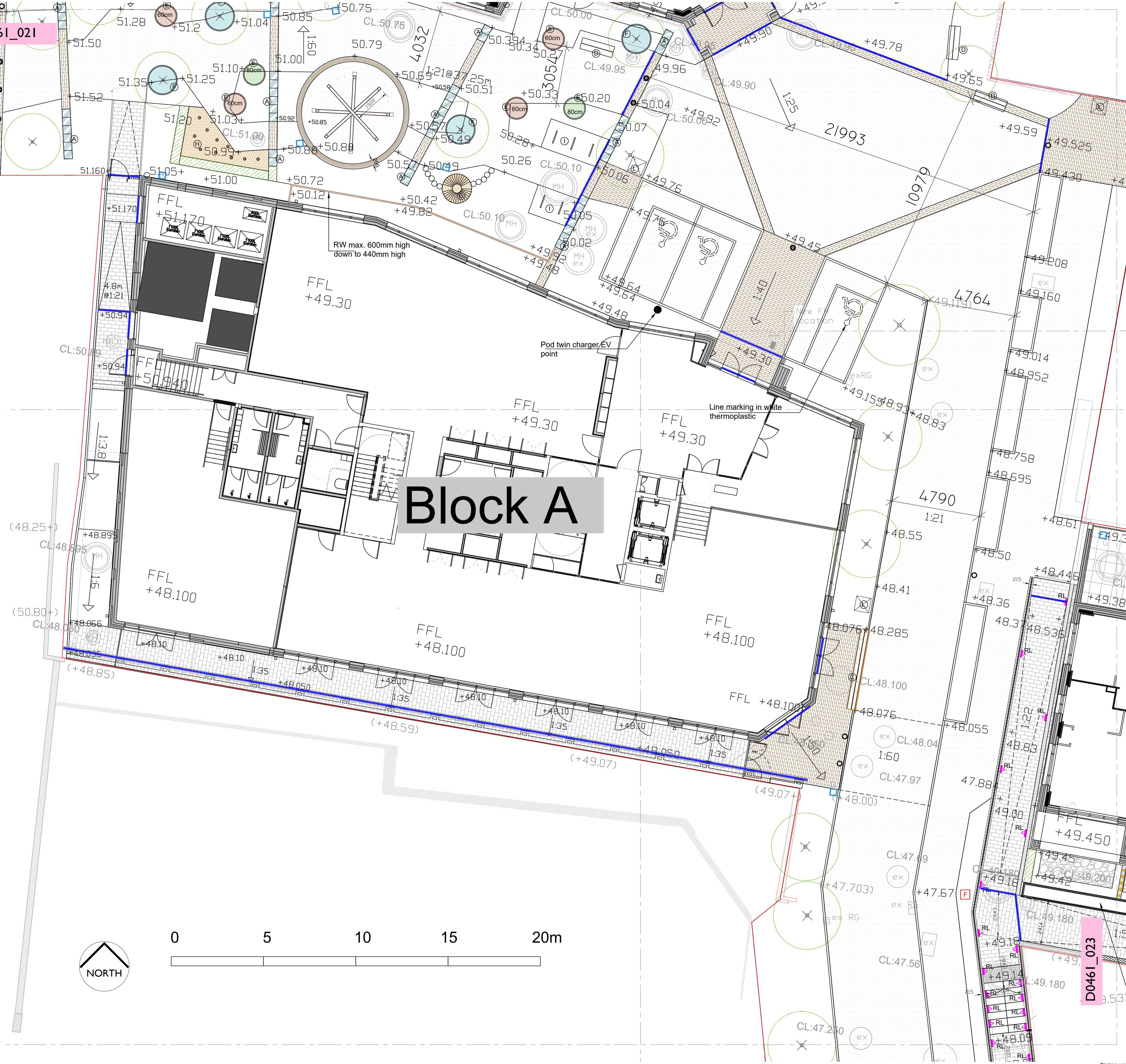

Legend  
osap = or similar and approved material  
All paving surfaces to be submitted as  
samples by contractor for client approval.  
All CDP works - contractor design portion  
to client approvals

- Resin bound gravel  
10mm size, colour: buff (Barley Butter)  
over non-permeable sub-base  
by Sureset osap
- Clay pavers  
Vande Moortel Vanilla type clay pavers  
218x52x72mm, stretcher bond pattern  
by Vande Moortel osap
- Concrete block paving- Modal colour: light cream  
granite, 300x200mm, textured, stretcher bond  
pattern to block C and rear of block B. To Block  
B and school area Single block row edge osap
- Loose Buff flint gravel with ECCO gravel  
stabilisation grid layer gravel 6mm size, colour: buff  
flint by CED osap with metal edge
- Paving slabs to private terraces Conservation type  
paving, cream 600x600x50mm, stacked grid pattern  
osap with min. 50mm flint gravel to all edges
- Recycled brown rubber play surface under  
willow den and under weaving poles by  
Tigermulch, dark brown colour, osap
- Stepping Logs  
Play grade stepping logs through planting  
at constant height of 50mm above FGL
- Tactile paving to top and bottom of steps  
Corduroy paving, contrasting buff or darker  
colour to C Eng/BCO approval  
400x400x50mm osap
- Concrete steps Perfecta type steps, colour: natural  
risers: 400x170 (av.) x50mm, treads 400x400x50mm  
to include standard black LRV visibility strips osap
- Cantebury timber privacy screen to block C  
frontages. Screen 1.4m high, with 45 deg. corner  
detail. On low brick wall to terrace/bldg ground level  
changes to BM detail /CDP and gravel board where  
needed. Screen by Jackson Fencing osap
- Cantebury timber privacy screen to block C, top  
rear pile wall. Screen 1.2m high level. Mounted on  
keyclamp fence detail set into concrete footings  
/CDP works. Include for timber capping to pile wall.  
Screen by Jackson Fencing osap
- Cantebury timber boundary fences to block C  
treated fence 2m ht. 80mm gap to bldg.  
Include gravel board all to CDP works, refer to  
details by Jackson Fencing osap
- Acoustic timber boundary fences to block  
C/School boundary treated fence min. 2m ht.  
all to CDP works, refer to details by Acoustic  
specialist and Jackson Fencing osap
- Habitat Wall  
Gabion basket (450x450x450mm) or similar  
and approved to fabricators spec and  
engineers approval, stacked to  
form habitat wall, max. 60cm ht- refer to detail
- Bramhall 1840 BSS13 type reclaimed oak bench  
top osap to precast concrete fairfaced bench  
base (Block A entrance) 500mm wide x 4435mm  
long
- Bramhall 1840 BSS13 type reclaimed oak bench  
with galvanised band steel legs osap  
500mm wide x 1779mm long
- Feature pots  
Aodh pots, medium size, 110cm top 60cm, taupe  
colour, heavy dragged texture supplied by 'Torc  
Pots' osap
- Feature pots  
Aodh pots, medium size, 110cm top, 80cm  
high (special), taupe colour, heavy dragged  
texture supplied by 'Torc Pots' osap
- Feature pots  
Aodh pots, large size, 150cm top, 80cm  
high, terracota colour, heavy dragged  
texture, supplied by Torc Pots osap.

REV	DESCRIPTION	APP.	DATE
I	update in line with planning comms/BM updates	JB	23.04.23
H	Detail update as planning mtg	JB	08.03.23
G	Block A timber RW update	JB	22.02.23
F	C Field comments update	JB	20.02.23
E	Client comments update	JB	21.01.23
D	C-Field well update	JB	15.12.22
C	update to C Field 08-12-22- comms	JB	14.12.22
B	To C Field comms	JB	06.12.22
A	Updated to C Field, P&M comments	JB	27.10.22

London  
T 020 70171786

Liddell Road

Hardworks Layout GA  
Sheet 2 of 4

DATE 22.09.22 DRAWN JB  
SCALE 1:100@A1 CHECKED NT  
STATUS Stage 4 APPROVED NT  
DWG NO D0461\_022 I

