



Are you affected by this planning application?

The Council has received an application for:

Erection of a single storey rear extension at first floor level to dwellinghouse (Class C3) (Associated applications at 24 Quickswood and 8 Conybeare)

At: 9 Conybeare London NW3 3SD

Application Number: 2022/4428/P

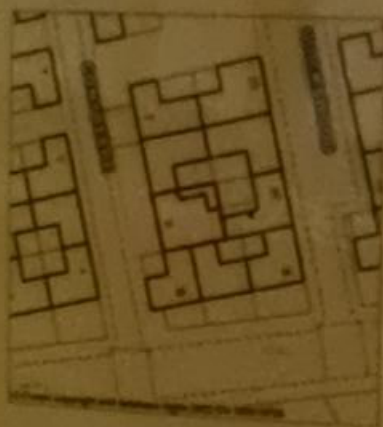

HAVE YOUR SAY

You can comment until: **Saturday 17th December 2022**

See the plans / make a comment: www.camden.gov.uk/viewplans

The person dealing with this application is:

Leela Muthoora (020 7974 2506)

All comments are public and can be viewed online. We will not acknowledge receipt of your comments. In the event of an appeal all comments will be shared with the Secretary of State. If this is a householder or minor commercial application you will not have a further opportunity to comment at appeal stage.





Are you affected by this planning application?

The Council has received an application for
**Erection of a single storey rear extension at first floor level to dwellinghouse
(Class C3) (Associated applications at 24 Quickwood and 8 Conybeare)**

At: 9 Conybeare London NW3 3SD

Application Number: 2022/4428/P

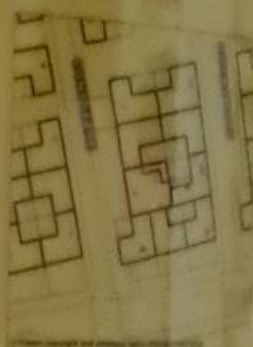

HAVE YOUR SAY

You can comment until: **Saturday 17th December 2022**

See the plans / make a comment: www.camden.gov.uk/viewplans

The person dealing with this application is:

Leela Muthoora (020 7974 2506)

All comments are public and can be viewed online. We will not acknowledge if you need a change
on appeal all comments will be shared with the Secretary of State. If this is a late stage
application you will not have a further opportunity to comment at appeal stage.



Are you affected by this planning application?

The Council has received an application for
**Conversion of integral garage to habitable room with associated works
door to window to front elevation to dwellinghouse (Class C3)**

At: 24 Quickwood London NW3 3SS

Application Number: 2022/2962/P

