

Site Measurements not to be taken from drawings.
Contractor to confirm all dimensions.
HHD not liable for seeking relevant planning authority permissions (including LBC) unless specifically directed by the client

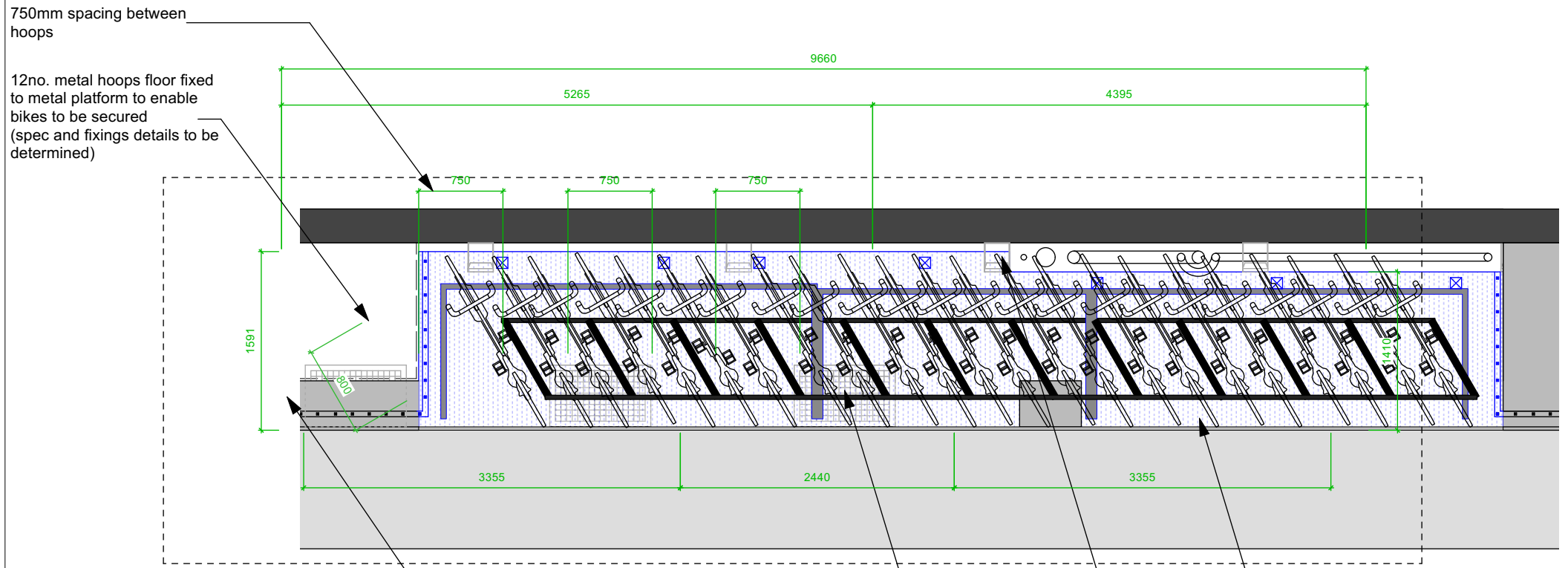

750mm spacing between hoops
12no. metal hoops floor fixed to metal platform to enable bikes to be secured (spec and fixings details to be determined)

TOTAL NUMBER OF BIKES: 23no

Proposed Plan
Scale 1:50

Railing continued to meet Ground Floor stair structure

New perforated metal platform to infill void at ground floor level. Free standing structure to rear (ie not fixed to existing facade of building). Mechanical fixings to rear edge of exposed pavement void. Please refer to HHD Dwg no. FB256.012.

Existing Pipework

New metal platform design intent only - final design and details to be confirmed by manufacturer

TOAST RACK HOOPS:
Supplied by 'Bike Dock Solutions'
Stands are 750mm tall and 750mm wide.
Galvanised steel
Overground fixing (boltdown)
Hoops set at a 30 degree angle

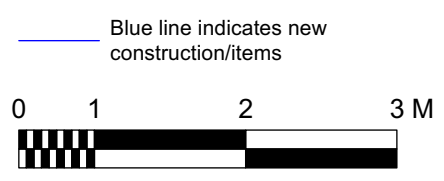

Proposed Bike Store Plan
Shropshire House Bike Store
1.50 @ A3

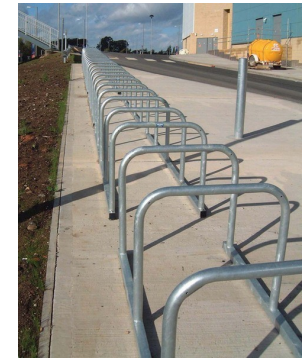
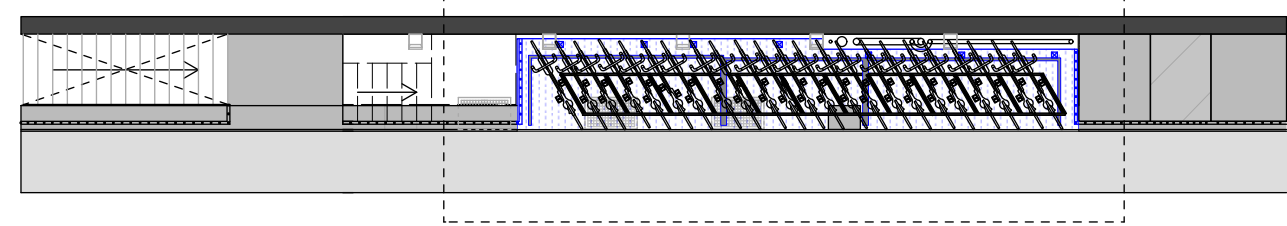

Image of Proposed Bike Hoops



Proposed Location Plan
Not to Scale

B	24/03/2023	Nos of Bikes Increased	RH
A	23/03/2023	Bike Arrangement Amended	RH
-	25/10/22	First Issue	AD

No.	Date	Revisions / Submissions	Revised by
-----	------	-------------------------	------------



Design Firm
HamburyHird Design Ltd.
50-52 Wellsway
Bath
BA2 4SA
Telephone: 01225 336004

Stage
PLANNING

Project Title
Shropshire House Bike Store
11-20 Capper Street
London.WC1E 6JA

Drawing Title
Proposed Bike Store Plan

Project Manager	TBC	Project ID	FB256
Drawn By	AD	CAD File Name	FB256(B) Shropshire House Bike Store.vwx
Reviewed By	RH	Drawing No.	FB256.010(B)
Date	October 2022		
Scale	1.50 @ A3		

