

Proposed Ground Floor Plan - scale 1:250

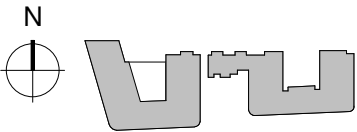

KEY PLAN

NOTES

THIS DRAWING MUST NOT BE SCALED.

ALL DIMENSIONS ARE TO BE VERIFIED AND CHECKED ON SITE. ANY DISCREPANCIES THAT ARE, OR BECOME APPARENT SHOULD BE REPORTED TO CHAPMAN TAYLOR.

AREAS INDICATED ARE APPROXIMATE GROSS INTERNAL AREA. THEY RELATE TO THE LIKELY AREAS OF THE BUILDING AT THE CURRENT STAGE OF DESIGN. ANY DECISIONS TO BE MADE ON THE BASIS OF THESE PREDICTIONS, WHETHER AS TO PROJECT VIABILITY, PRE-LETTING, LEASE AGREEMENTS, OR THE LIKE, SHOULD INCLUDE DUE ALLOWANCE FOR THE INCREASES AND DECREASES INHERENT IN THE DESIGN DEVELOPMENT AND BUILDING PROCESS.

© COPYRIGHT CHAPMAN TAYLOR 2020

Line of S73 Approved Scheme

REV	DATE	BY	DESCRIPTION	CHKD
-----	------	----	-------------	------

CLIENT



PROJECT
WEST END LANE
156 West End Lane
West Hampstead
London NW6 1SD

ARCHITECT

 **CHAPMAN TAYLOR**
GLOBAL ARCHITECTS & MASTERPLANNERS

LONDON STUDIO
10 Lambourne Terrace
London W2 6LG
United Kingdom
T +44 (0)20 7371 3000
E london@chapmantaylor.com
www.chapmantaylor.com

STRUCTURAL ENGINEER

IBSISSTRUCTURES

SERVICES ENGINEER



DRAWING TITLE
GROUND FLOOR PLAN
EAST BLOCK

INTERNAL JOB NO		ISSUE DATE		STATUS		DRAWN BY		CHECKED BY	
C340WEL		JUNE 2021				Author		Checker	
PROJECT NUMBER	ROLE	ORIGINATOR	TYPE	SERIES	LEVEL	SERIAL	REVISION		
0001	A	CTA	SKE	98	00	5571	-		





Proposed First Floor Plan - scale 1:250

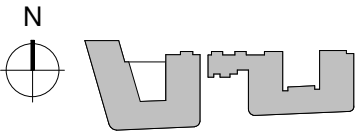

KEY PLAN

NOTES

THIS DRAWING MUST NOT BE SCALED.
ALL DIMENSIONS ARE TO BE VERIFIED AND CHECKED ON SITE. ANY DISCREPANCIES THAT ARE, OR BECOME APPARENT SHOULD BE REPORTED TO CHAPMAN TAYLOR.
AREAS INDICATED ARE APPROXIMATE GROSS INTERNAL AREA. THEY RELATE TO THE LIKELY AREAS OF THE BUILDING AT THE CURRENT STAGE OF DESIGN. ANY DECISIONS TO BE MADE ON THE BASIS OF THESE PREDICTIONS, WHETHER AS TO PROJECT VIABILITY, PRE-LETTING, LEASE AGREEMENTS, OR THE LIKE, SHOULD INCLUDE DUE ALLOWANCE FOR THE INCREASES AND DECREASES INHERENT IN THE DESIGN DEVELOPMENT AND BUILDING PROCESS.

© COPYRIGHT CHAPMAN TAYLOR 2020

Line of S73 Approved Scheme

REV	DATE	BY	DESCRIPTION	CHK'D
-----	------	----	-------------	-------

CLIENT

astr.

PROJECT
WEST END LANE
156 West End Lane
West Hampstead
London NW6 1SD

ARCHITECT

CHAPMAN TAYLOR
GLOBAL ARCHITECTS & MASTERPLANNERS
LONDON STUDIO
10 Eastbourne Terrace
London W2 6LG
United Kingdom
T +44 (0)20 7371 3000
E london@chapmantaylor.com
www.chapmantaylor.com

STRUCTURAL ENGINEER

IBSISSTRUCTURES

SERVICES ENGINEER



DRAWING TITLE
FIRST FLOOR PLAN
EAST BLOCK

INTERNAL JOB NO	ISSUE DATE	STATUS			DRAWN BY		CHECKED BY
C340WEL	JUNE 2021				Author		Checker
PROJECT NUMBER	ROLE	ORIGINATOR	TYPE	SERIES	LEVEL	SERIAL	REVISION
0001	A	CTA	SKE	98	01	5572	-





Proposed Second Floor Plan - scale 1:250

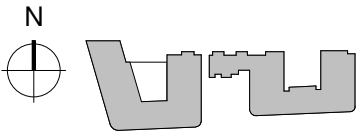
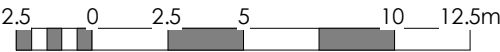

KEY PLAN

NOTES

THIS DRAWING MUST NOT BE SCALED.

ALL DIMENSIONS ARE TO BE VERIFIED AND CHECKED ON SITE. ANY DISCREPANCIES THAT ARE, OR BECOME APPARENT SHOULD BE REPORTED TO CHAPMAN TAYLOR.

AREAS INDICATED ARE APPROXIMATE GROSS INTERNAL AREA. THEY RELATE TO THE LIKELY AREAS OF THE BUILDING AT THE CURRENT STAGE OF DESIGN. ANY DECISIONS TO BE MADE ON THE BASIS OF THESE PREDICTIONS, WHETHER AS TO PROJECT VIABILITY, PRE-LETTING, LEASE AGREEMENTS, OR THE LIKE, SHOULD INCLUDE DUE ALLOWANCE FOR THE INCREASES AND DECREASES INHERENT IN THE DESIGN DEVELOPMENT AND BUILDING PROCESS.

© COPYRIGHT CHAPMAN TAYLOR 2020

Line of S73 Approved Scheme

REV	DATE	BY	DESCRIPTION	CHKD
-----	------	----	-------------	------

CLIENT

astr.

PROJECT
WEST END LANE
156 West End Lane
West Hampstead
London NW6 1SD

ARCHITECT

CHAPMAN TAYLOR
GLOBAL ARCHITECTS & MASTERPLANNERS
LONDON STUDIO
15 Eastbourne Terrace
London W2 6LG
United Kingdom
T +44 (0)20 7571 3000
E london@chapmantaylor.com
www.chapmantaylor.com

STRUCTURAL ENGINEER

ISISSTRUCTURES

SERVICES ENGINEER



DRAWING TITLE
SECOND FLOOR PLAN
EAST BLOCK

INTERNAL JOB NO		ISSUE DATE		STATUS		DRAWN BY		CHECKED BY	
C340WEL		JUNE 2021				Author		Checker	
PROJECT NUMBER		ROLE	ORIGINATOR	TYPE	SERIES	LEVEL	SERIAL	REVISION	
0001		A	CTA	SKE	98	02	5573	-	

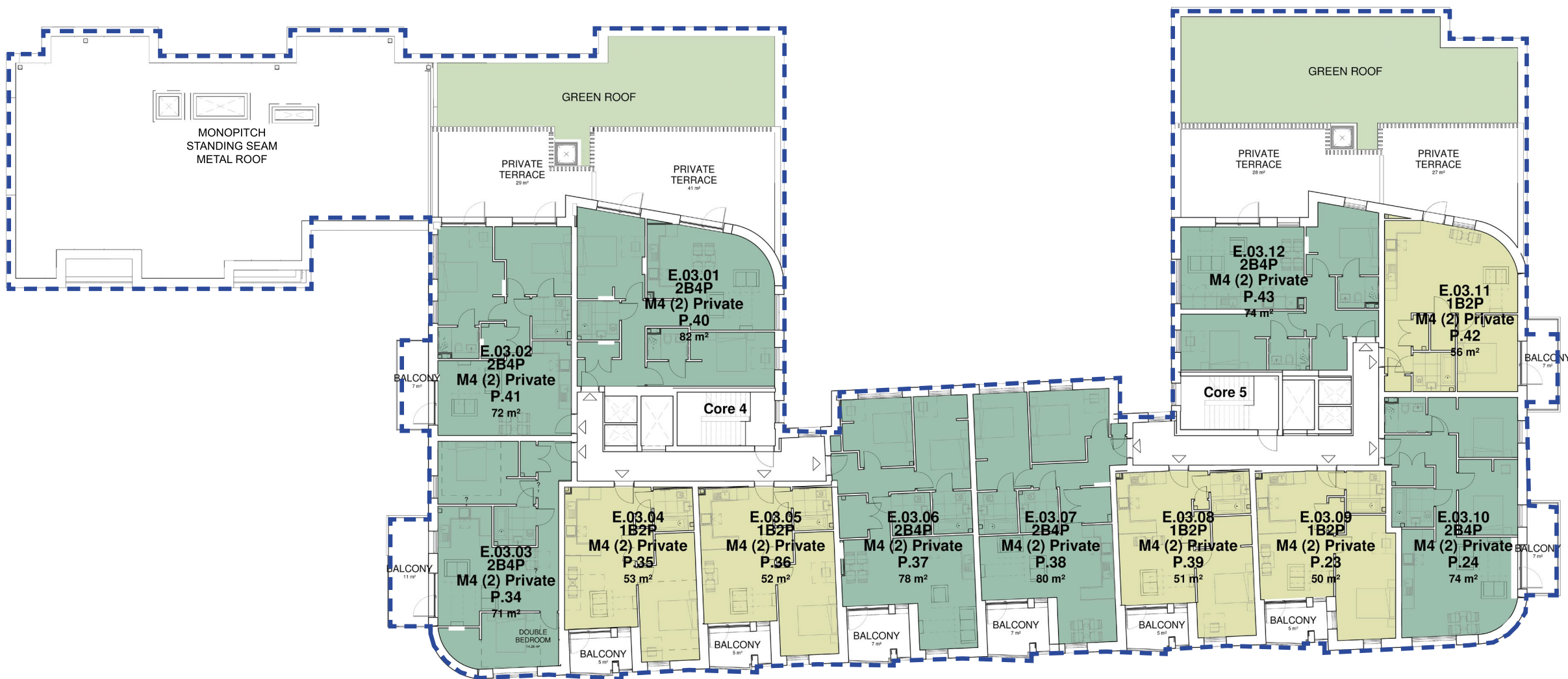

Proposed Third Floor Plan - scale 1:250

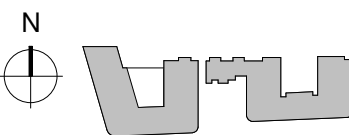
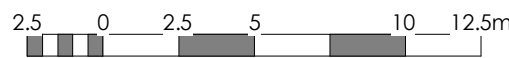

KEY PLAN

NOTES

THIS DRAWING MUST NOT BE SCALED.

ALL DIMENSIONS ARE TO BE VERIFIED AND CHECKED ON SITE. ANY DISCREPANCIES THAT ARE, OR BECOME APPARENT SHOULD BE REPORTED TO CHAPMAN TAYLOR.

AREAS INDICATED ARE APPROXIMATE GROSS INTERNAL AREA. THEY RELATE TO THE LIKELY AREAS OF THE BUILDING AT THE CURRENT STAGE OF DESIGN. ANY DECISIONS TO BE MADE ON THE BASIS OF THESE PREDICTIONS, WHETHER AS TO PROJECT VIABILITY, PRE-LETING, LEASE AGREEMENTS, OR THE LIKE, SHOULD INCLUDE DUE ALLOWANCE FOR THE INCREASES AND DECREASES INHERENT IN THE DESIGN DEVELOPMENT AND BUILDING PROCESS.

© COPYRIGHT CHAPMAN TAYLOR 2020

Line of S73 Approved Scheme

REV	DATE	BY	DESCRIPTION	CHKD
-----	------	----	-------------	------

CLIENT



PROJECT
WEST END LANE
156 West End Lane
West Hampstead
London NW6 1SD

ARCHITECT



CHAPMAN TAYLOR
GLOBAL ARCHITECTS & MASTERPLANNERS

LONDON STUDIO
101 Goldbourne Terrace
London W2 6LG
United Kingdom
T +44 (0)20 7571 3000
E london@chapmantaylor.com
www.chapmantaylor.com

STRUCTURAL ENGINEER



SERVICES ENGINEER



DRAWING TITLE
**THIRD FLOOR PLAN
EAST BLOCK**

INTERNAL JOB NO		ISSUE DATE		STATUS			DRAWN BY		CHECKED BY	
C340WEL		JUNE 2021					Author		Checker	
PROJECT NUMBER		ROLE	ORIGINATOR	TYPE	SERIES	LEVEL	SERIAL		REVISION	
0001		A	CTA	SKE	98	03	5574			

Proposed Fourth Floor Plan - scale 1:250

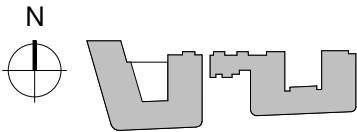

KEY PLAN

NOTES

THIS DRAWING MUST NOT BE SCALED.
ALL DIMENSIONS ARE TO BE VERIFIED AND CHECKED ON SITE. ANY DISCREPANCIES THAT ARE, OR BECOME APPARENT SHOULD BE REPORTED TO CHAPMAN TAYLOR.
AREAS INDICATED ARE APPROXIMATE GROSS INTERNAL AREA. THEY RELATE TO THE LIKELY AREAS OF THE BUILDING AT THE CURRENT STAGE OF DESIGN. ANY DECISIONS TO BE MADE ON THE BASIS OF THESE PREDICTIONS, WHETHER AS TO PROJECT VIABILITY, PRE-LETTING, LEASE AGREEMENTS, OR THE LIKE, SHOULD INCLUDE DUE ALLOWANCE FOR THE INCREASES AND DECREASES INHERENT IN THE DESIGN DEVELOPMENT AND BUILDING PROCESS.
© COPYRIGHT CHAPMAN TAYLOR 2020

Line of S73 Approved Scheme

REV	DATE	BY	DESCRIPTION	CHK'D
-----	------	----	-------------	-------

CLIENT



PROJECT
WEST END LANE
156 West End Lane
West Hampstead
London NW6 1SD

ARCHITECT

CHAPMAN TAYLOR
GLOBAL ARCHITECTS & MASTERPLANNERS
LONDON STUDIO
10 Garsington Terrace
London W2 6LG
United Kingdom
T +44 (0)20 7571 3000
E london@chapmantaylor.com
www.chapmantaylor.com

STRUCTURAL ENGINEER

IBSISSTRUCTURES

SERVICES ENGINEER



DRAWING TITLE
FOURTH FLOOR PLAN
EAST BLOCK

INTERNAL JOB NO	ISSUE DATE	STATUS	DRAWN BY		CHECKED BY		
C340WEL	JUNE 2021		Author		Checker		
PROJECT NUMBER	ROLE	ORIGINATOR	TYPE	SERIES	LEVEL	SERIAL	REVISION
0001	A	CTA	SKE	98	04	5575	-

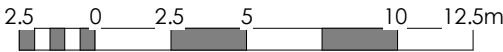

Proposed Fifth Floor Plan - scale 1:250

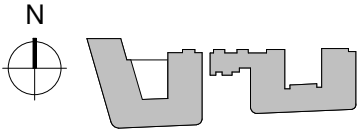
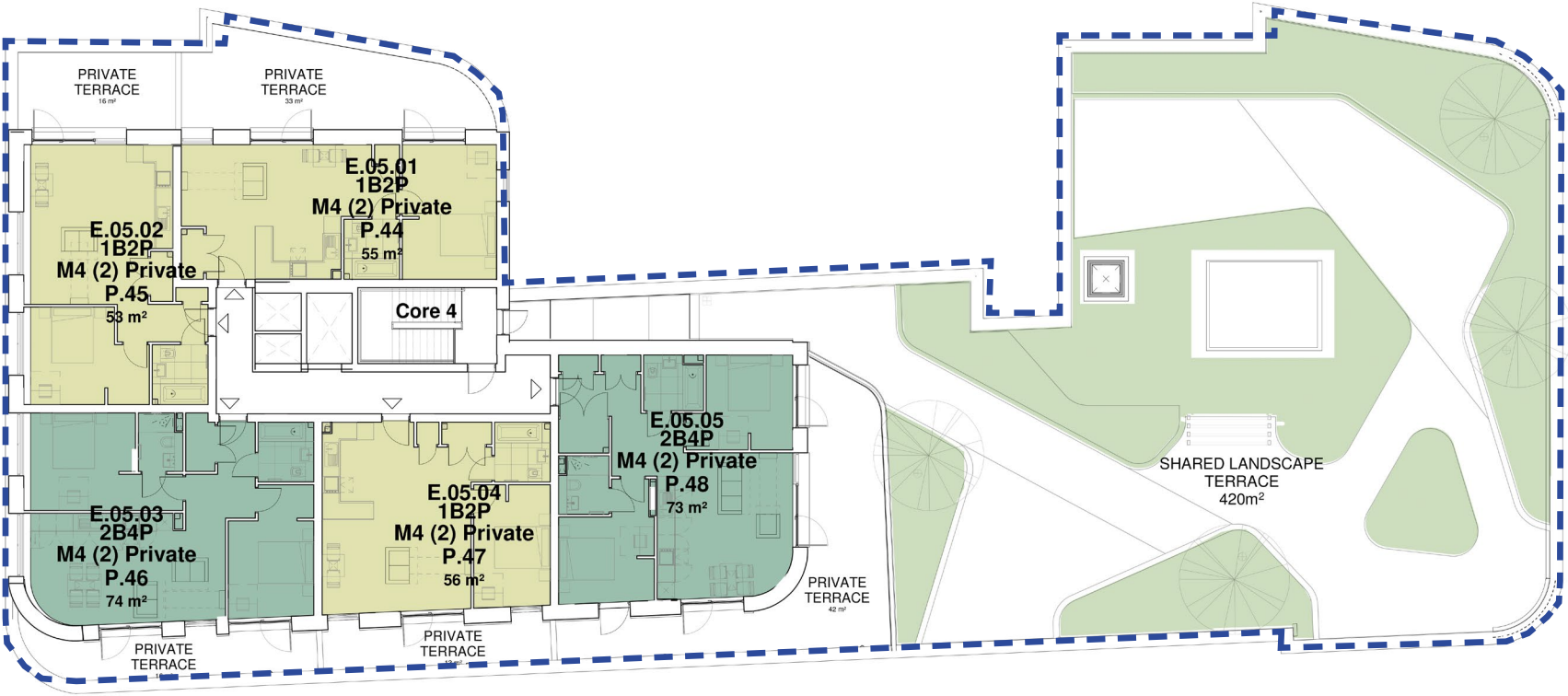

KEY PLAN

NOTES

THIS DRAWING MUST NOT BE SCALED.

ALL DIMENSIONS ARE TO BE VERIFIED AND CHECKED ON SITE. ANY DISCREPANCIES THAT ARE, OR BECOME APPARENT SHOULD BE REPORTED TO CHAPMAN TAYLOR.

AREAS INDICATED ARE APPROXIMATE GROSS INTERNAL AREA. THEY RELATE TO THE LIKELY AREAS OF THE BUILDING AT THE CURRENT STAGE OF DESIGN. ANY DECISIONS TO BE MADE ON THE BASIS OF THESE PREDICTIONS, WHETHER AS TO PROJECT VIABILITY, PRE-LETTING, LEASE AGREEMENTS, OR THE LINE, SHOULD INCLUDE DUE ALLOWANCE FOR THE INCREASES AND DECREASES INHERENT IN THE DESIGN DEVELOPMENT AND BUILDING PROCESS.

© COPYRIGHT CHAPMAN TAYLOR 2020

Line of S73 Approved Scheme

REV	DATE	BY	DESCRIPTION	CHK'D
-----	------	----	-------------	-------

CLIENT

astir.

PROJECT
WEST END LANE
156 West End Lane
West Hampstead
London NW6 1SD

ARCHITECT

CHAPMAN TAYLOR
GLOBAL ARCHITECTS & MASTERPLANNERS
LONDON STUDIO
101 Garsington Terrace
London W92 6LG
United Kingdom
T +44 (0)20 7571 3000
E london@chapmantaylor.com
www.chapmantaylor.com

STRUCTURAL ENGINEER

IBSISSTRUCTURES

SERVICES ENGINEER

DRAWING TITLE
**FIFTH FLOOR PLAN
EAST BLOCK**

INTERNAL JOB NO	ISSUE DATE	STATUS			DRAWN BY	CHECKED BY	
C340WEL	JUNE 2021				Author	Checker	
PROJECT NUMBER	ROLE	ORIGINATOR	TYPE	SERIES	LEVEL	SERIAL	REVISION
0001	A	CTA	SKE	98	05	5576	-

