

A SHUTTER ELEVATION
DET-58 PROPOSED - pW-F-04

B SHUTTER ELEVATION
DET-58 PROPOSED - pW-S-01, pW-S-02, pW-S-03

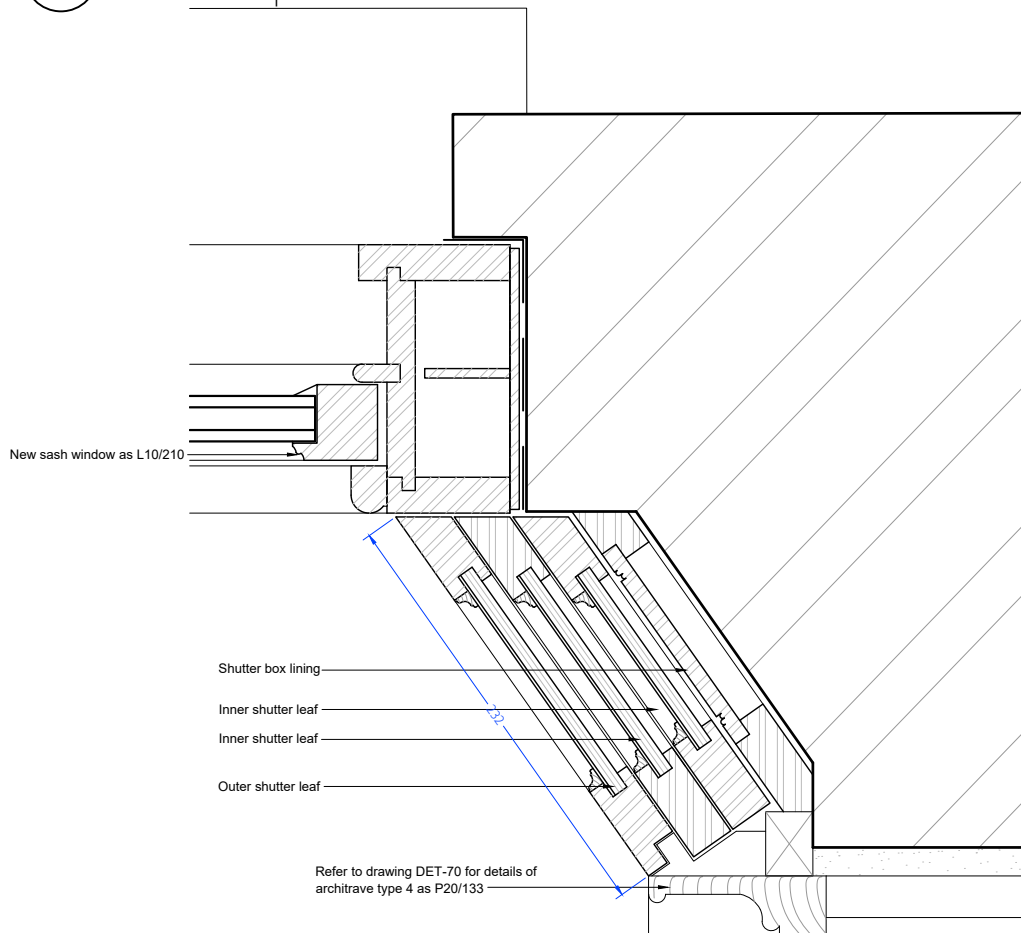

I SHUTTER BOX PLAN
DET-58 PROPOSED - pW-F-04 Scale 1:2

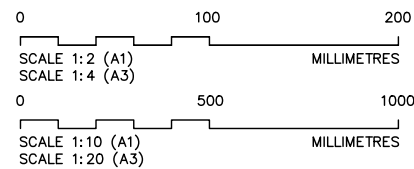

ALL EXISTING JOINERY TO BE FULLY
STRIPPED & REPAIRED PRIOR TO
REDECORATION

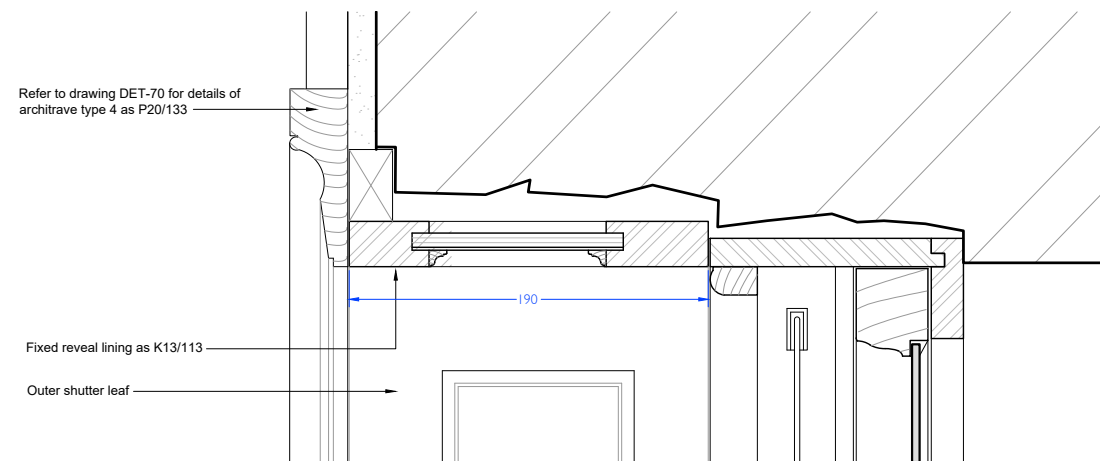

2 WINDOW HEAD DETAIL
DET-58 PROPOSED - pW-F-04 Scale 1:2

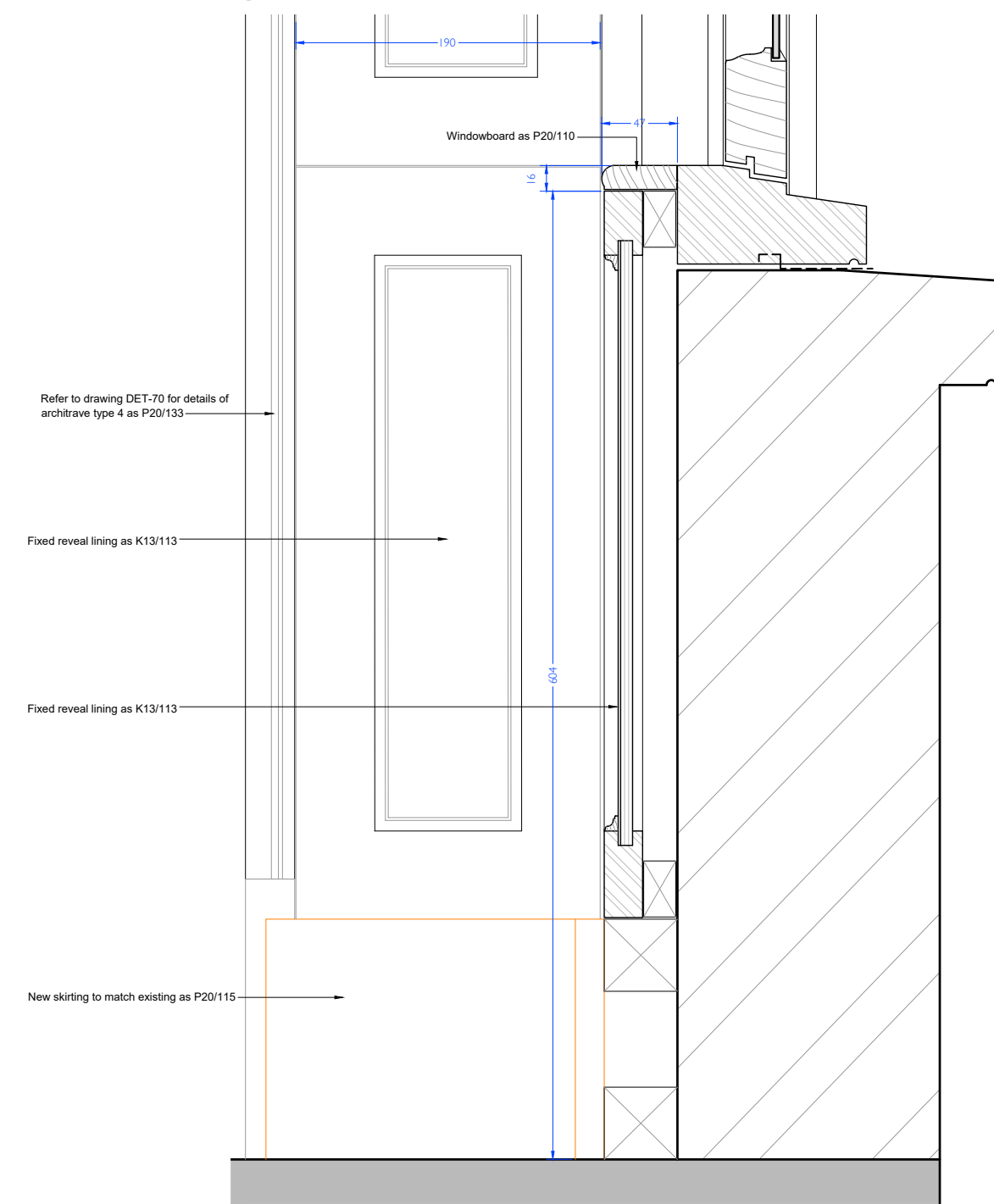

3 WINDOW CILL DETAIL
DET-58 PROPOSED - pW-F-04 Scale 1:2

DO NOT SCALE DRAWINGS. THE CONTRACTOR IS RESPONSIBLE FOR CHECKING DIMENSIONS & ANY DISCREPANCY IS TO BE REFERRED TO THE ARCHITECT.

DIMENSIONS & SIZES GIVEN FOR PRICING PURPOSES ONLY. ALL EXISTING WINDOWS TO BE MEASURED ON SITE. SHUTTER SIZES TO BE DETERMINED BY CONTRACTOR PRIOR TO MANUFACTURE. WORKSHOP DRAWINGS OF ALL SHUTTERS TO BE SUBMITTED TO ARCHITECT FOR APPROVAL PRIOR TO MANUFACTURE.

ALL NEW HINGES & FITTINGS TO MATCH EXISTING.

T1	Tender Amendments	Oct 22
T	Tender	Aug 22
REV.	AMENDMENT	DATE

THOMAS FORD & PARTNERS
CHARTERED ARCHITECTS SURVEYORS

177 KIRKDALE
SYDENHAM • LONDON • SE26 4QH
TEL 020 8659 3250 • FAX 020 8659 3146
EMAIL tfp@thomasford.co.uk

PROJECT 41 DOUGHTY STREET RENOVATION CAMDEN			
TITLE NEW WINDOW SHUTTERS pW-F-04, pW-S-01-03 AS PROPOSED			
DRAWN Sed	DATE Jun 22	SCALES 1:10/2@A1	CHECKED
PROJECT REF. 381401	DWG. No. DET-58	REV. T1	