

ALL DIMENSIONS AND LEVELS TO BE CHECKED ON SITE BEFORE COMMENCING WORK. ANY DISCREPANCIES SHALL BE IMMEDIATELY NOTIFIED TO THE ARCHITECT IN WRITING. DO NOT SCALE FROM THIS DRAWING. USE FIGURED DIMENSIONS ONLY. IF IN DOUBT CONSULT THE ARCHITECT.
© GODDARD MANTON LIMITED

GENERAL NOTES:

1 NOTE TEXT - borders will not plot

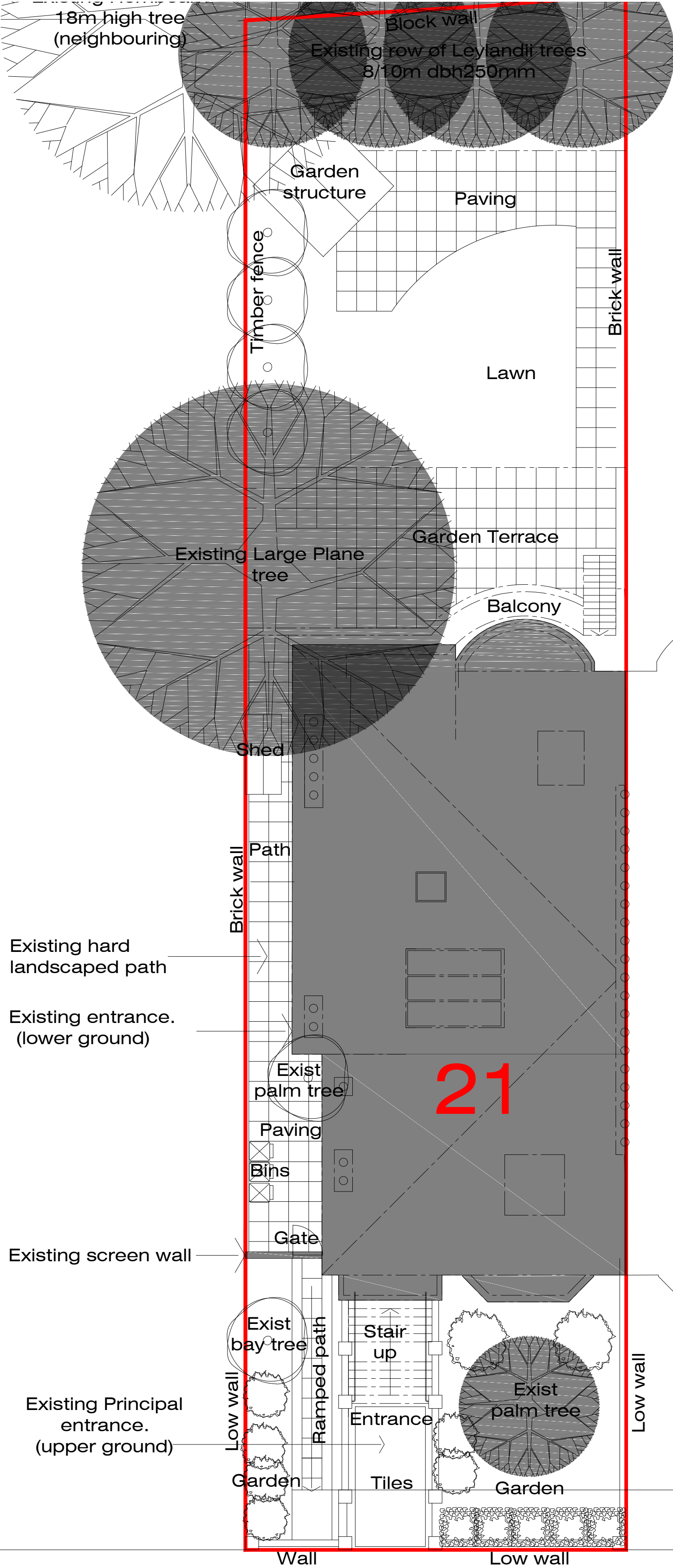

EXISTING Site Plan
Area 543m2

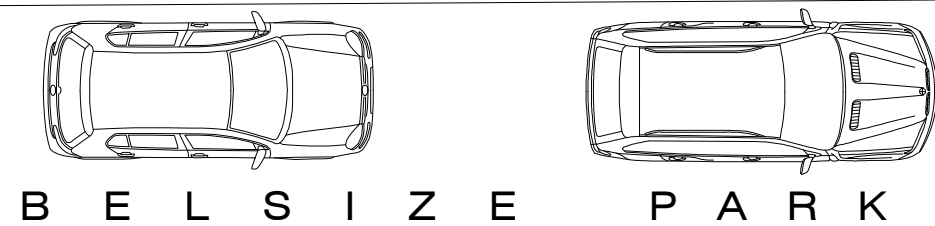

1
PL 01
EXISTING Site Plan
SCALE 1:100

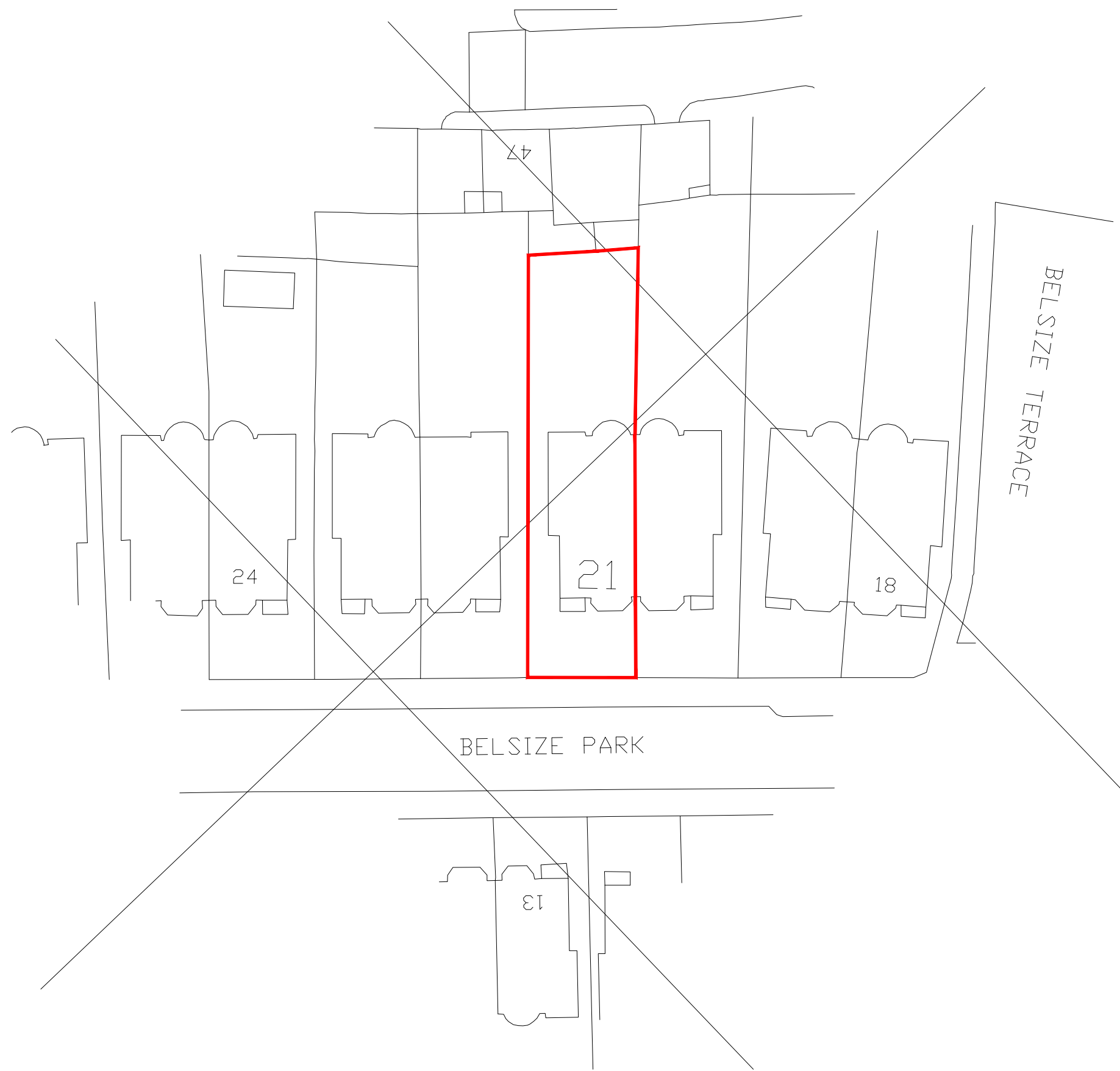
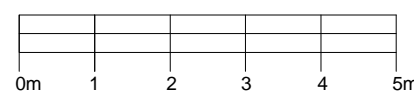

2
PL 01
Location Plan
SCALE 1:500

A	21/04/2023	ISSUED FOR INFORMATION	LF
REV	DATE	AMENDMENT	BY
1	21/04/2023	ISSUED FOR INFORMATION	LF
####			
Key Plan			
PROJECT: House Conversion 21 Belsize Park London NW3 4DU			
TITLE: PLANNING Site Plan			

Goddard Manton Architects
1 Bury St London NW3 4DU
Telephone: 020 7267 3161
Fax: 020 7267 3125
Web: www.goddardmanton.com
Goddard Manton Limited
Registered in England No. 2384800
Registered Office The Oval 14 West Walk Leicester LE1 7HA

DRAWN:	CHECKED:	CREATION DATE:	SCALE:
LF	-	Apr-23	# A1 1:100, 1:500
PROJ No.:	DRAWING No.:	REV. No.:	
1081	PL-01	A	