

1) Setting out

a. Plantings and beds must be set out as per the approved soft landscaping plan, and measured from existing fixed points.

2) Ground preparation

a. Where weeds are present on proposed planting beds, a pre-planting herbicide application is required. When used, it must be applied by a skilled and qualified operative using suitable spraying apparatus. The herbicide must also be applied in line with the manufacturer's instructions and in accordance with 1997 Control of Pesticides Regulations and 2003 COSHH regulations. On heavily weeded sites, multiple applications may be required so as to kill of dormant seeds.

b. To ensure that the existing topsoil within the planting beds complies with BS 3882:2007 rocks and rubble/debris larger than 50mm diameter, must be removed.

c. To ensure that planting beds are not compacted and are free draining, they must be forked over.

3) Planting

a. All planting shall be carried out in accordance with the approved specification and plant schedule and following the specified planting bed preparation specification. Planting shall be undertaken in the next available planting season.

b. Plants must be planted at the correct depth making sure that the root collar is at the proposed surface level; adjust depth as required.

c. Plant substitutions are not permitted without prior approval of the project manager and client. All plants must be of a size and specification in line with the approved specification, unless otherwise agreed by the project manager and client.

d. Immediately following planting, whips shall be watered in with 20 litres per square metre.

4) Aftercare

a. Following the establishment of the selected hedge plants (3-5 years after planting), annual pruning/ trimming may be required.

b. Supplemental irrigation will be required in order to ensure the long-term health and survival of the plants. The frequency and extent of the supplemental irrigation should consider the prevailing weather conditions and season (e.g. prolonged dry periods or rainfall patterns). However, it is advised that for the initial 2 years, following planting, each plant will require watering between three to seven days per week, during the summer months.

Ref.	Species	Size	Type	Quantity
-	Yew hedging - Taxus baccata	60-90cm whips	Whips planted in double staggered rows 5p/m	55

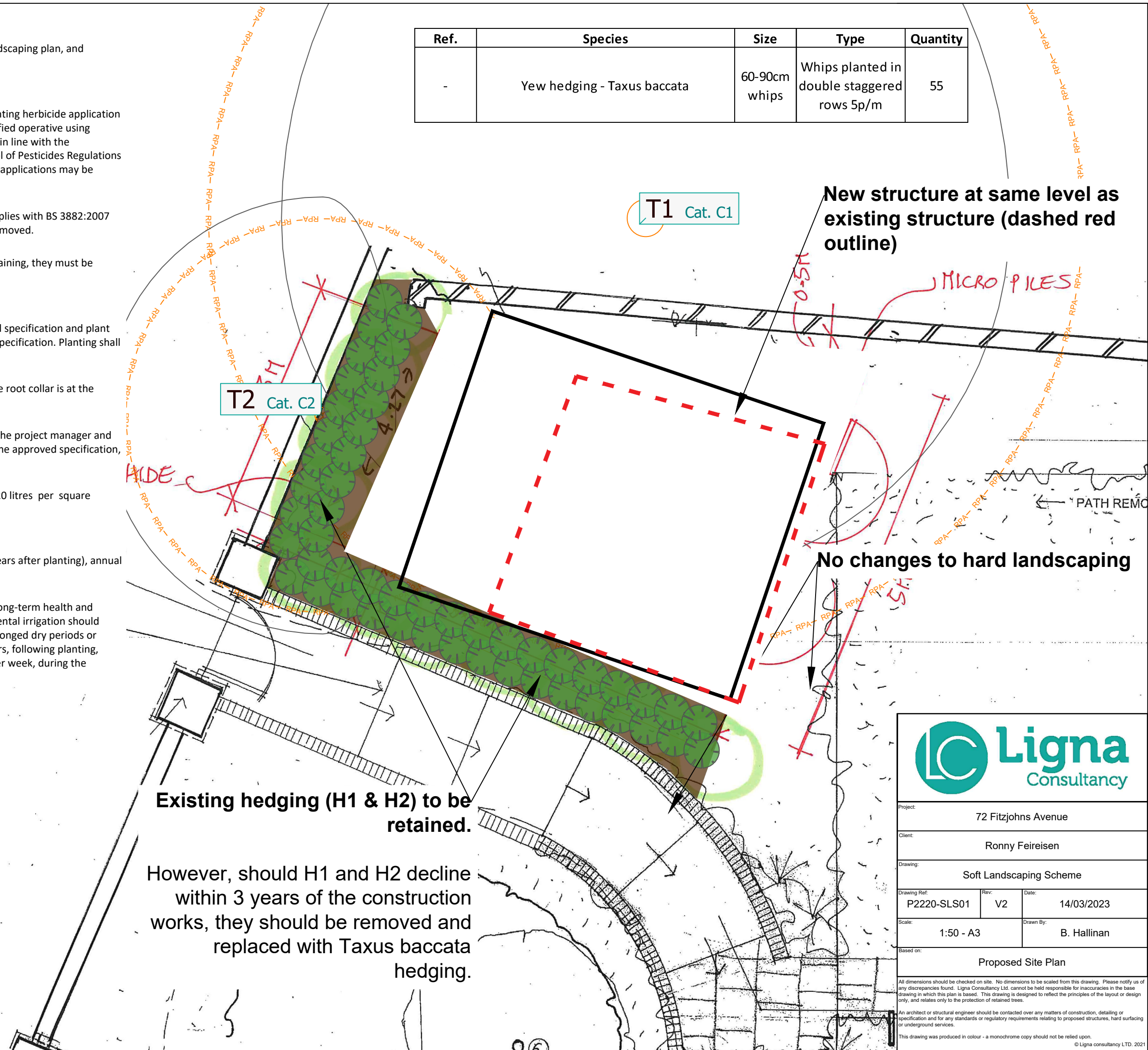

Ligna Consultancy

Project: 72 Fitzjohns Avenue
 Client: Ronny Feireisen
 Drawing: Soft Landscaping Scheme
 Drawing Ref: P2220-SLS01 | Rev: V2 | Date: 14/03/2023
 Scale: 1:50 - A3 | Drawn By: B. Hallinan
 Based on: Proposed Site Plan

All dimensions should be checked on site. No dimensions to be scaled from this drawing. Please notify us of any discrepancies found. Ligna Consultancy Ltd. cannot be held responsible for inaccuracies in the base drawing in which this plan is based. This drawing is designed to reflect the principles of the layout or design only, and relates only to the protection of retained trees.
 An architect or structural engineer should be contacted over any matters of construction, detailing or specification and for any standards or regulatory requirements relating to proposed structures, hard surfacing or underground services.
 This drawing was produced in colour - a monochrome copy should not be relied upon.
 © Ligna consultancy LTD. 2021