

Warner Bros. GIR Site Plan

Warner Bros, 200 Gray'S Inn Road, London, WC1X 8XZ

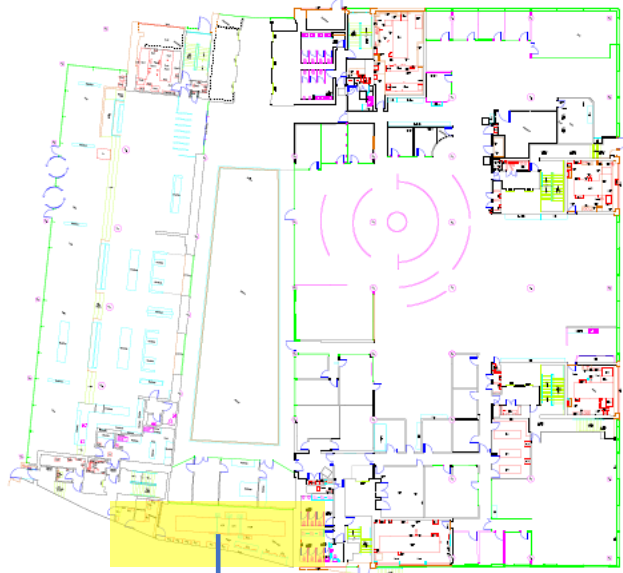

Warner Bros. Floor Plan



Existing Floor Plan

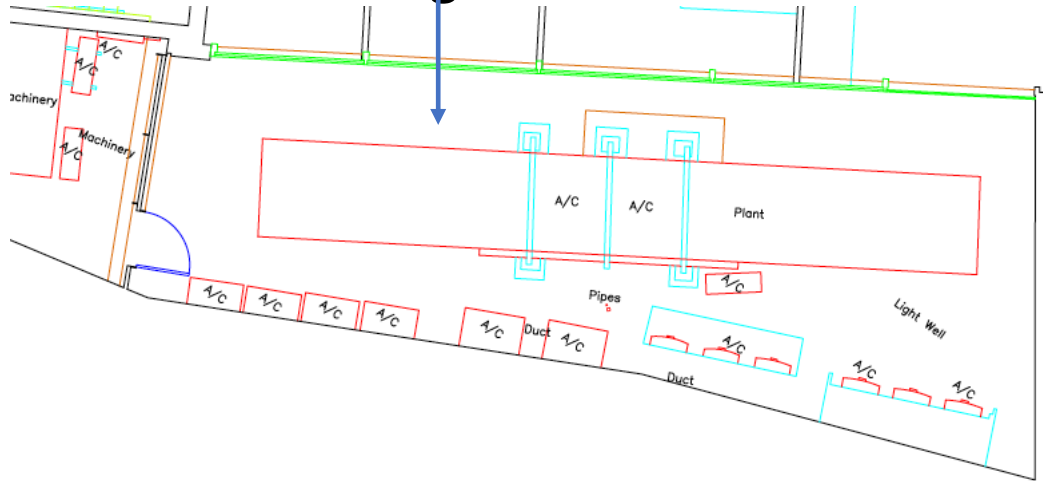

Proposed Floor Plan

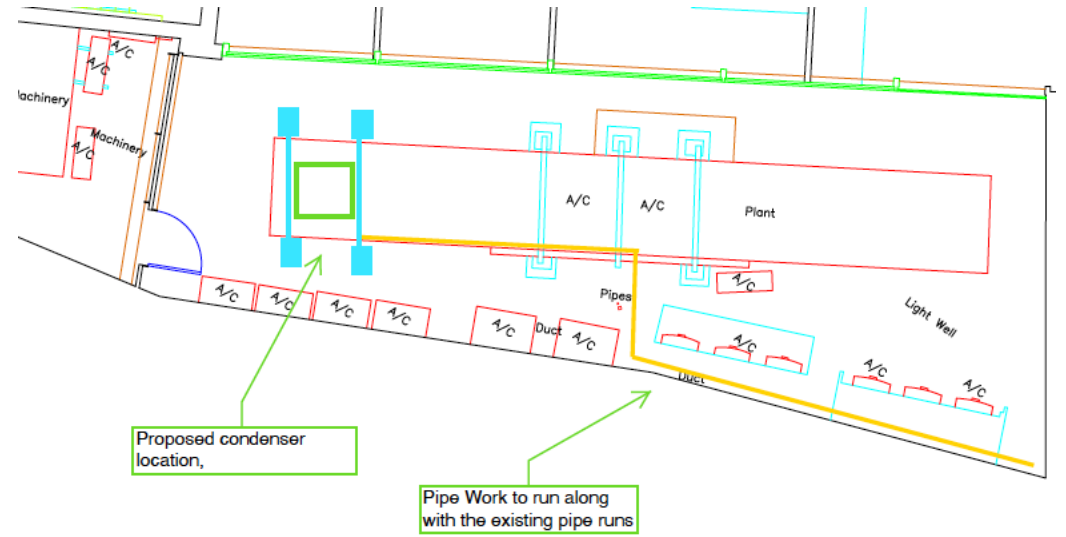

Warner Bros. Elevation

Existing Elevation

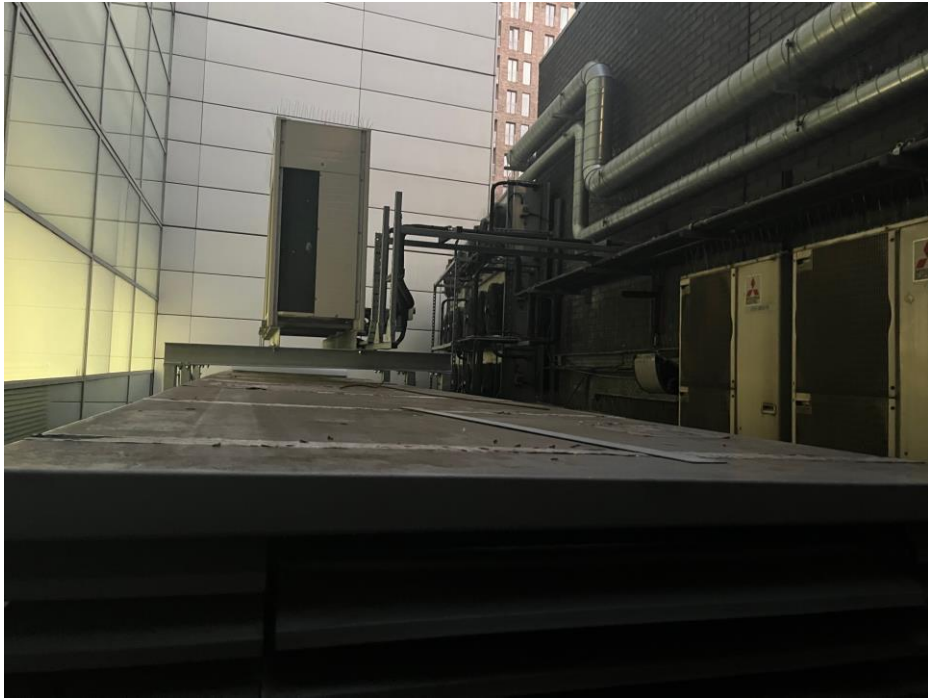

Proposed Floor Plan

New condenser unit and steel work support



Acoustic enclosure

External Unit

Steel supporting frame

Warner Bros. Acoustic Enclosure Specification

DIMENSIONS

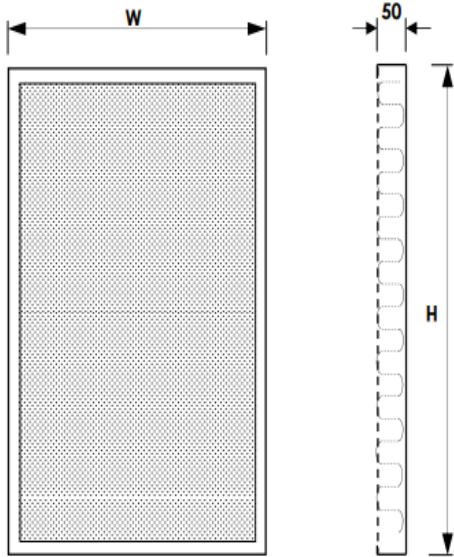

ACOUSTIC PERFORMANCE

SOUND REDUCTION INDEX BS EN ISO 10140/2 : 2010

63	125	250	500	1000	2000	4000	8000	Hz
17	19	26	33	38	42	45	44	dB

SOUND ABSORPTION BS EN ISO 354 : 2003

63	125	250	500	1000	2000	4000	8000	Hz
.10	.25	.45	1.00	1.00	1.00	.95	.90	-

NOTES

THIS DATA SHEET IS TO BE READ IN CONJUNCTION WITH THE EQUIPMENT SCHEDULE

PANELS WILL BE SUPPLIED WITHOUT SUPPORT STEELWORK, BRACKETS, FIXINGS OR MASTIC UNLESS OTHERWISE STATED.

PANELS MORE THAN 1800 WIDE OR 2500 HIGH MAY BE MANUFACTURED IN SECTIONS FOR ON SITE ASSEMBLY.

SPECIFICATION

THE ACOUSTIC ENCLOSURE PANEL COMPRISES A COMBINATION OF SOUND ABSORBENT MATERIALS AND HIGH MASS BARRIERS CONTAINED WITHIN A METAL CASING HAVING AN PLAIN OUTER AND PERFORATED INNER FACE, OFFERING EXCELLENT SOUND REDUCTION AND ABSORPTION PROPERTIES.

PANELS ARE CONSTRUCTED FROM PRE-GALVANISED SHEET STEEL AS STANDARD.

THE OUTER CASING IS FORMED FROM PLAIN SHEET METAL AND INSIDE FACE FROM PERFORATED METAL.

PANELS CONTAIN A FIBROUS SOUND ABSORBENT INFILL THAT IS NON-SHEDDING, NON-COMBUSTIBLE, NON-HYGROSCOPIC AND CHEMICALLY INERT. THE INFILL IS FACED WITH GLASS CLOTH TO PREVENT FIBRE MIGRATION.

THE CASING CAN BE SUPPLIED WITH A PERIMETER FLANGE FOR FIXING ADJACENT SECTIONS TOGETHER, FIXING THE PANELS INTO THE BUILDERSWORK OPENING OR FIXING INTO THE FRAMEWORK OF AN ACOUSTIC ENCLOSURE (OPTION F).

POLYESTER POWDER FINISH AVAILABLE (SUFFIX P)

SUFFIX

P - POLYESTER POWDER COAT

F - PERIPHERAL FIXING FRAME

X - SPECIAL CONSTRUCTION, REFER TO EQUIPMENT SCHEDULE FOR DETAILS.

BUILDERSWORK

THE W AND H DIMENSIONS GIVEN ON THE CERTIFIED EQUIPMENT SCHEDULE ARE AS MANUFACTURED.

ADEQUATE CLEARANCE MUST BE ALLOWED WHEN CONSTRUCTING THE BUILDERSWORK OPENING, MIN 10mm IS RECOMMENDED.

WEIGHT

ACTUAL WEIGHTS ARE GIVEN ON THE EQUIPMENT SCHEDULE.

APPROXIMATE WEIGHT: 18kg/M².

STANDARD SIZES

THERE ARE NO STANDARD SIZES. PANELS ARE MANUFACTURED TO ORDER

DIMENSIONS

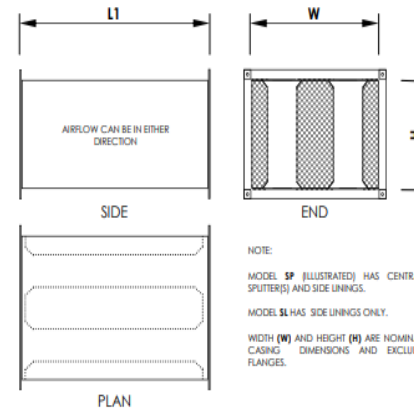

SPECIFICATION

ATTENUATORS ARE CONSTRUCTED IN ACCORDANCE WITH DW 144 SPECIFICATION FOR MEDIUM PRESSURE (CLASS B) DUCTWORK.

CASES ARE STIFFENED AND FITTED WITH PROPRIETARY FLANGES.

MODEL SP - HAS SOUND ABSORBENT SPLITTERS ARRANGED VERTICALLY WITHIN THE CASING TO FORM A SERIES OF CENTRAL ELEMENTS AND SIDE LININGS.

MODEL SL - HAS SOUND ABSORBENT SPLITTERS ARRANGED VERTICALLY WITHIN THE CASING TO FORM SIDE LININGS ONLY.

SPLITTERS AND SIDE LININGS CONTAIN A SOUND ABSORBENT INFILL THAT IS ENCAPSULATED WITH GLASS CLOTH AND PLAIN/PERFORATED STEEL.

SPLITTERS HAVE AERODYNAMIC FAIRINGS AT EACH END.

NOTES

THIS DATA SHEET IS TO BE READ IN CONJUNCTION WITH THE EQUIPMENT SCHEDULE.

LARGER ATTENUATORS WILL BE OF MODULAR CONSTRUCTION FOR EASE OF HANDLING AND MAY BE SPLIT ON THE LENGTH, WIDTH, HEIGHT OR COMBINATION THEREOF (SEE DATA SHEET A09 FOR DETAILS).

ATTENUATORS WILL BE SUPPLIED WITHOUT SUPPORT STEELWORK, BRACKETS, FIXINGS, GASKET, MASTIC OR OTHER SUCH ITEMS, UNLESS OTHERWISE STATED.

IT IS THE INSTALLERS RESPONSIBILITY TO PROVIDE THE FLANGE SEAL TO THE CONNECTING DUCT.

INSERTION LOSS, PRESSURE LOSS AND FLOW NOISE ARE DERIVED FROM TESTS CARRIED OUT IN ACCORDANCE WITH ISO 7235 AND MAY VARY DEPENDING ON INSTALLED CONDITIONS.

MANUFACTURING DIMENSIONAL TOLERANCE < 1.0 %.

SUFFIX

THE SUFFIX TO THE ATTENUATOR MODEL DEFINES THE MATERIAL OF FABRICATION AND ANY ADDITIONAL FEATURES OR SPECIAL CONSTRUCTIONAL DETAILS.

G - PRE-GALVANISED STEEL CONSTRUCTION.

S - GRADE 316 STAINLESS STEEL CONSTRUCTION.

H1 - HIGH TEMPERATURE APPLICATION (2 HOUR/300c).

D - DOUBLE SKIN CASING (CASING SIZE W+50 x H+50).

C - HIGH PRESSURE APPLICATION (DW 144, CLASS C).

X - PROTECTIVE PAINT FINISH TO VISIBLE INTERNAL METAL SURFACES.

J - SPLITTERS AND/OR SIDE LININGS ARRANGED HORIZONTALLY.

M - MELINEX ENCAPSULATED INFILL.

Z(***) - MODULAR CONSTRUCTION (SEE DATA SHEET A09 FOR DETAILS).

X - SPECIAL CONSTRUCTION, REFER TO EQUIPMENT SCHEDULE FOR DETAILS.

FLANGE DETAILS

ATTENUATORS ARE FITTED WITH 30 mm PROFILE FLANGES COMPLYING WITH DW144 AND DW/TM1.

STANDARD SIZES

LENGTH (L1) - 600, 900, 1200, 1500, 1800, 2100, 2400, 2700, & 3000 mm.

WIDTH (W) - ANY DIMENSION ABOVE 149 mm.

HEIGHT (H) - ANY DIMENSION ABOVE 99 mm.

ALL ATTENUATORS ARE MADE TO ORDER.

NON STANDARD ATTENUATORS ARE AVAILABLE.

WEIGHT

WEIGHTS ARE GIVEN ON THE EQUIPMENT SCHEDULE.

MODULAR CONSTRUCTION

ATTENUATORS MANUFACTURED IN ONE SECTION WILL HAVE NO "Z" SUFFIX IN THE CODE.

WHEN ATTENUATORS ARE SUPPLIED IN MODULAR FORM, THE ACTUAL NUMBER OF SECTIONS IN THE LENGTH, WIDTH AND HEIGHT DEFINED BY THE "Z" SUFFIX. REFER TO DATA SHEET A09 FOR DETAILS.

Z	#	#	#
A "Z" SUFFIX IN THE ATTENUATOR CODE DENOTES THAT THE ATTENUATOR WILL BE SUPPLIED IN MODULES.	NUMBER OF MODULES IN LENGTH.	NUMBER OF MODULES IN WIDTH.	NUMBER OF MODULES IN HEIGHT.

