

NOTE: THE PREVIOUS REVISION OF THIS DRAWING WAS PREPARED BY SMITH CARADOC HODGKINS ARCHITECTS HENCE CHANGE IN FORMAT AND TITLE BLOCK

- KEY
- 1

ZINC CLAD PLANT SCREEN - RED PIGMENTED ZINC TO MATCH THAT USED ON EXISTING CONSENTED ADJACENT CONSTRUCTION
- 2

ZINC CLAD SERVICE ACCESS GATE - RED PIGMENTED ZINC TO MATCH THAT USED ON EXISTING CONSENTED ADJACENT CONSTRUCTION
- 3

PLATFORM SUPPORTING NEW FAN AND ACCESS GANTRY
- 4

STAIR PRESSURISATION FAN
- 5

STAIR PRESSURISATION DUCTWORK
- 6

RED PIGMENTED ZINC CLAD GATE AND SCREEN - HEIGHT TO MATCH LIFT OVER-RUN
- 7

BLACK PAINTED METAL HANDRAIL
- 8

ACOUSTIC CABINET FAN MODEL S&P 5137835200-CVAT-12000/560N AND ATTENUATOR
- 9

ZINC CLAD LIFT OVER-RUN - RED PIGMENTED ZINC TO MATCH THAT USED ON EXISTING CONSENTED ADJACENT CONSTRUCTION

P.7

DRAWING STATUS PLANNING		
<p>NOTES:</p> <p>DO NOT SCALE FROM THIS DRAWING.</p> <p>ALL DIMENSIONS ARE TO BE VERIFIED ON SITE BY THE CONTRACTOR.</p> <p>ANY DISCREPANCY FOUND BETWEEN THIS DRAWING AND ANY OTHER DOCUMENTS MUST BE REPORTED IMMEDIATELY TO THE CONTRACT ADMINISTRATOR.</p> <p>REMOVE THIS DRAWING FROM CURRENCY WHEN A REVISED DRAWING IS ISSUED.</p> <p>COPYRIGHT OF THIS DRAWING REMAINS WITH HODGES ARCHITECTS.</p> <p>THIS DRAWING IS TO BE READ IN CONJUNCTION WITH THE EMPLOYER'S AND CONSULTANT'S PROJECT DOCUMENTS.</p>		
<div>A1</div>		
G	21.02.23	ADDITION PV PANEL ADDED AS CLOUDED TO IMPROVE CO2 REDUCTION THROUGH RENEWABLES
F	14.11.22	APPLICATION DRAWINGS A109 RevD AND A109 RevE COMBINED AND RESUBMITTED UNDER SINGLE APPLICATION 2024/154/P
E	22.09.22	WINDOWS SIZES REVISED TO ZINC CLADDING TO SUIT FIRE ENGINEERS REQUIREMENTS.
D	24.09.22	ROOF PLANT AND STAIR PRESSURISATION FAN ADDED
<div><div>HA</div><div>HODGES ARCHITECTS LTD</div><div>T: 07932 376 008</div><div>E: MAIL@HODGESARCHITECTS.CO.UK</div><div>W: WWW.HODGESARCHITECTS.CO.UK</div></div>		
CLIENT HATTON GARDEN PROPERTIES LTD		
PROJECT 72-80+82 LEATHER LANE LONDON, EC1N 7TR		
SCALE 1:50@A1 / 1:100@A3		DATE 11/05/22
DRAWN NH		CHKD SH
DRAWING TITLE PROPOSED PLAN SEVENTH FLOOR		
PROJECT NO. 011	DRAWING NO. A109	REV. G

- KEY
- EXISTING
- PROPOSED
- EXISTING NEIGHBOURING BUILDING
- TERRACE
- PLANTER
- BIODIVERSE ROOF

NOTE:
- THIS DRAWING IS BASED ON SURVEY INFORMATION PREPARED BY OTHERS.
- ALL AREAS ARE APPROXIMATE
- ALL EXISTING USES ARE ASSUMED.
- SEE A111-114 DETAILS OF PROPOSED RESIDENTIAL LAYOUTS

INDICATES EXISTING

INDICATES PROPOSED

- KEY
- PROPOSED PHOTOVOLTAIC CELL LOCATION. PLEASE REFER TO ENVIROLEC INFORMATION ACCOMPANYING THIS SUBMISSION FOR TECHNICAL DETAILS.

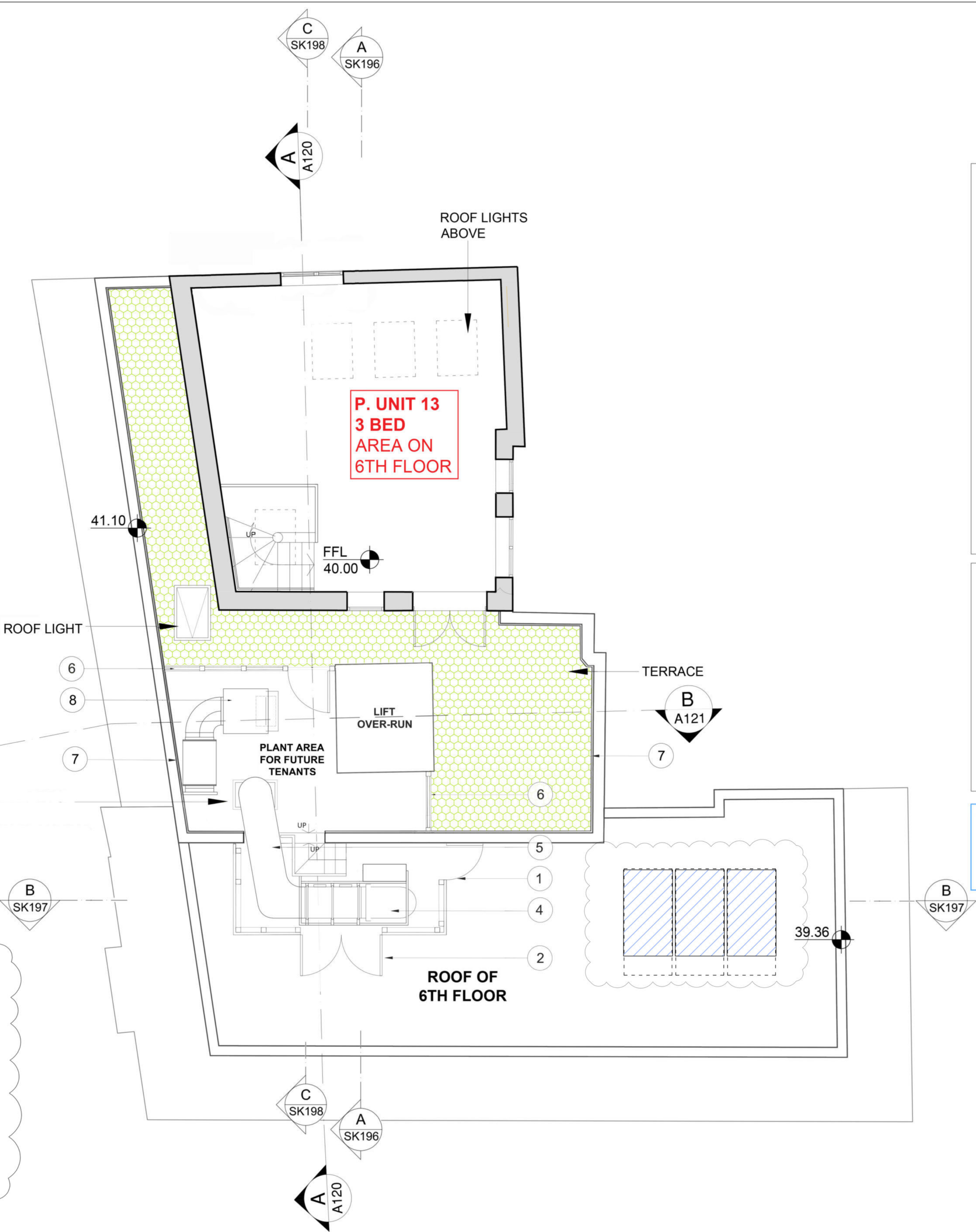

PROPOSED SEVENTH FLOOR PLAN
SCALE 1:50@A1 / 1:100@A3