

MAIN LOWER GROUND FLOOR PLAN
SHOWING FOUNDATIONS
Scale 1:50@A1

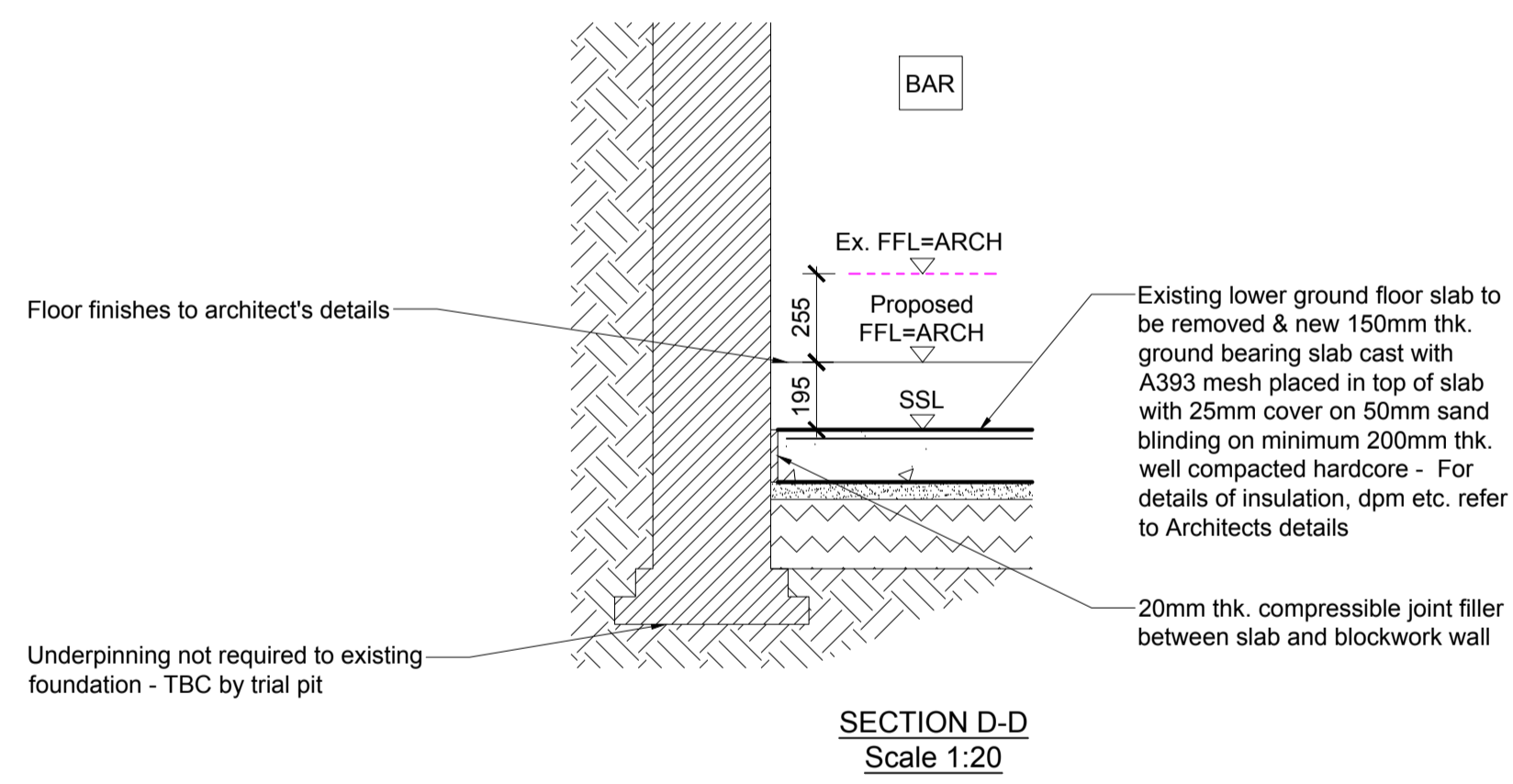

SECTION D-D
Scale 1:20

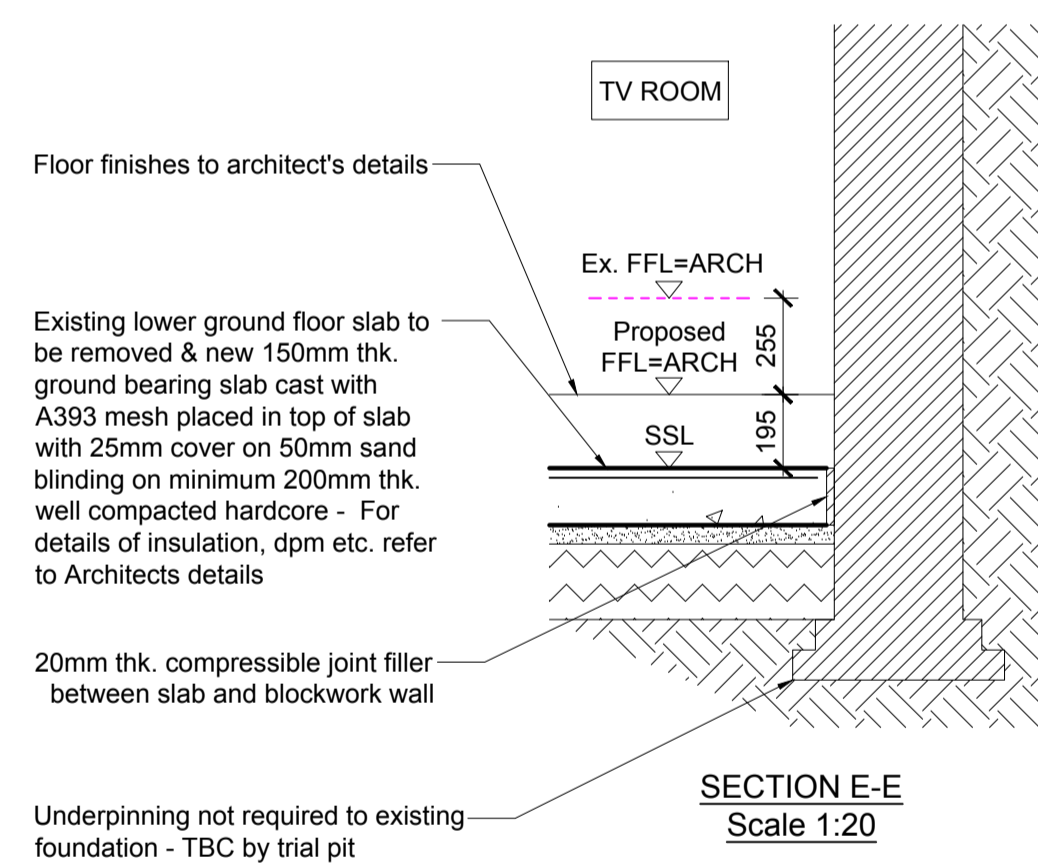

SECTION E-E
Scale 1:20

- NOTES:
1. If in doubt, please ask.
 2. Do not scale this drawing.
 3. This drawing is to be read in conjunction with all Engineer's, Architect's or other relevant drawings and specifications. Any discrepancy is to be reported to the engineer immediately.
 4. The contractor must ensure and will be held responsible for the overall stability of the building/structure/ excavation at all stages of the work.
 5. To be Read with General Notes S-0001

Please Note:
Electronic Design Information can be intentionally or unintentionally modified. It is a misconception that Electronic Design Information is by default accurate. Any modification or reuse of the Electronic Design Information issued herewith that results in erroneous setting-out and/or any other design, costing, measuring or construction inaccuracy are the responsibility of the recipient of this Electronic Design Information.

GENERAL KEY :	
	Existing walls
	New brick walls
	New masonry walls
	Demolition
	Mass concrete foundations FND2 Concrete.
	Load-bearing Ashlar wall studs C24 @ 400crs
	New timber stud partitions unless noted otherwise, double up joists / provide solid nogginns under
	EX. Span of existing floor
	Span of new timber/ concrete see notes
	New steel beams
	New timber beams
	Restraint straps as per spec and details
	Column under
	Furfix wall starter system with s/steel wall ties at 225 vertical crs
	Boundary lines

NOTE: EXISTING STRUCTURE & LAYOUT
SUBJECT TO EXPOSURE ON SITE

TEMPORARY WORKS TO CONTRACTORS
DESIGN AND DETAILS

IMPORTANT CDM/H&S NOTE

THE DESIGNERS HIGHLIGHT THE SIGNIFICANT RESIDUAL HEALTH AND SAFETY RISKS THAT HAVE NOT BEEN ELIMINATED FROM THE DESIGNS. THESE SIGNIFICANT RESIDUAL RISKS ARE IDENTIFIED BELOW.

	TEMPORARY PROPPING OF WALL DURING CONSTRUCTION OF NEW STAGGERED CONCRETE UNDERPINNING / SECTIONS
	TEMPORARY PROPPING OF EXISTING STRUCTURE DURING DEMOLITION OF EXISTING LOAD BEARING ELEMENTS & INSTALLATION OF NEW SUPPORTING STEELWORK

THIS NOTE REFERS TO SIGNIFICANT RESIDUAL RISKS AS DEFINED IN CDM LEGISLATION. OTHER HEALTH AND SAFETY RISKS ASSOCIATED WITH CONSTRUCTION ACTIVITIES MAY BE PRESENT.

P1	23.01.23	Preliminary Issue	DJ	AB
Rev	Date	Amendments	By	Chk'd
PRELIMINARY				
AXIOM STRUCTURES				
+44 (0)20 3637 2751 office@axiom-structures.co.uk				
Project: 25 CHESTER TERRACE LONDON, NW1 4ND				
Drawing title: STRUCTURAL PLANS SHEET 2 OF 2				
Date: 01/2023	Scale at A1: 1:50	Scale at A3: 1:100		
Drawn by: DJ	Designed by: AB	Chk'd by: AB		
Drawing No: 22103-ASL-DR-S-0101				Revision: P1