

Accessible front door cill detail - Section BB

2
700

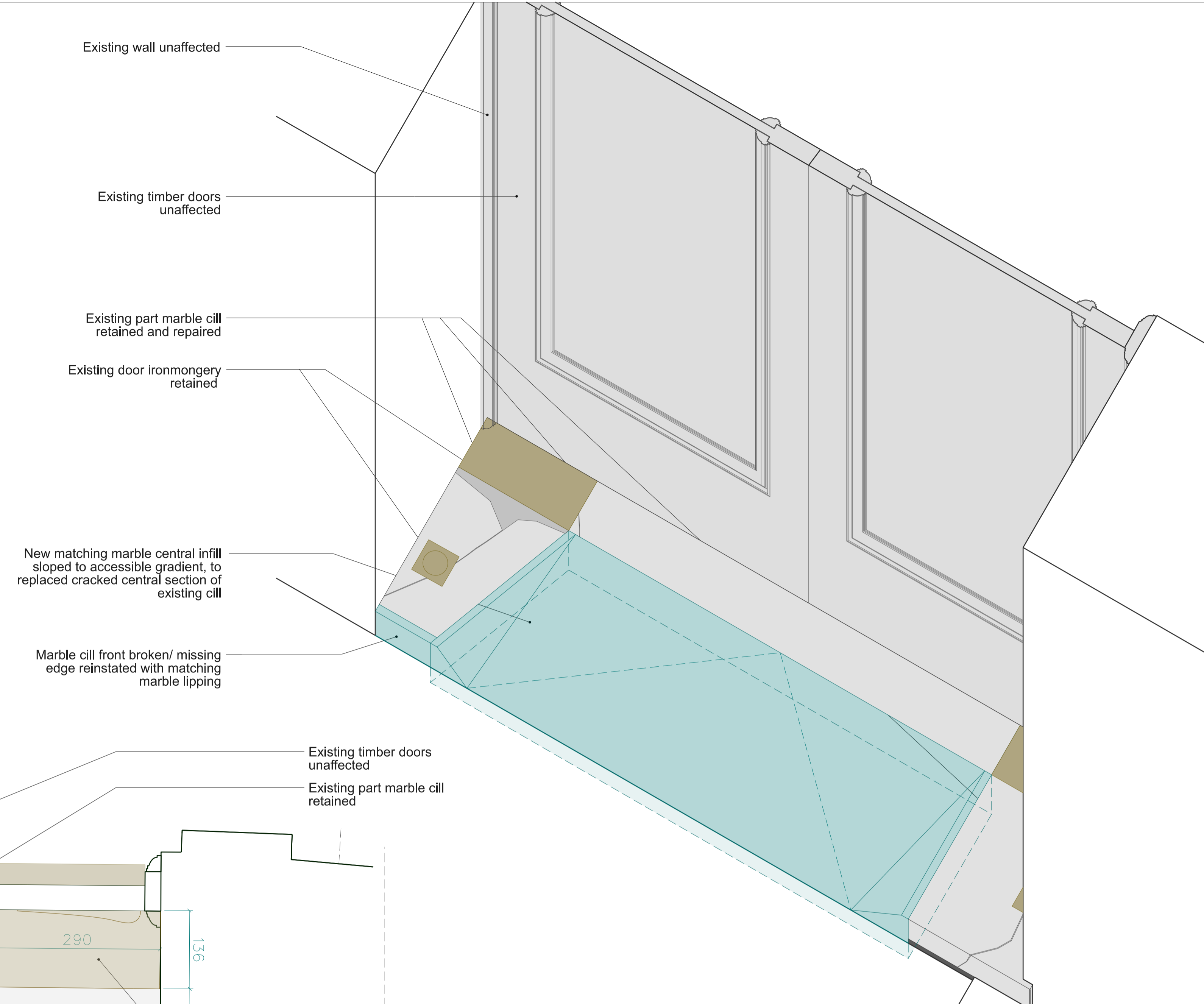

Accessible front door cill detail - Axonometric View

3
700

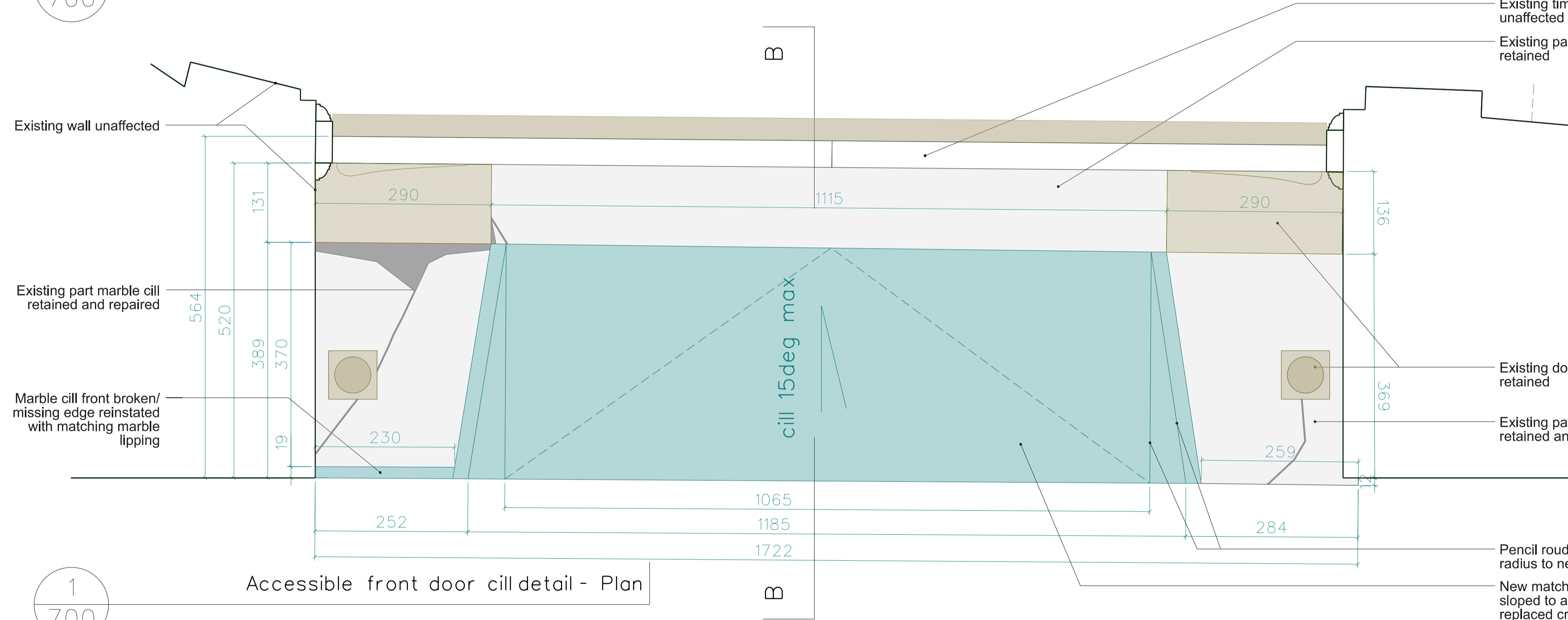

Accessible front door cill detail - Plan

1
700

- Key
- Existing retained and repaired
 - New matching marble installed
Note: matching sample to be submitted to Planning Officer/ Conservation Officer for approval

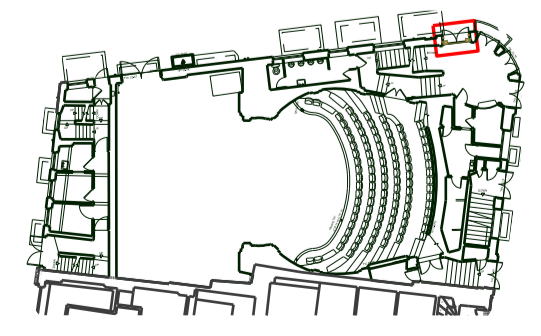

THE CONTRACTOR IS TO CHECK AND VERIFY ALL BUILDING AND SITE DIMENSIONS, LEVELS AND SEWER INVERT LEVELS AT CONNECTION POINTS BEFORE WORK STARTS

THIS DRAWING IS TO BE READ AND CHECKED IN CONJUNCTION WITH ENGINEERS AND OTHER SPECIALIST DRAWINGS

THE DRAWING AND THE WORKS DEPICTED ARE THE COPYRIGHT OF THIS PRACTICE AND MAY NOT BE REPRODUCED EXCEPT BY WRITTEN PERMISSION

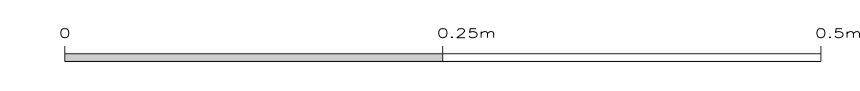

Rev:	Date:	Description
D	07/12/22	Stage 5 Provisional Issue
C	21/11/22	Stage 5 Provisional Issue
B	20/09/22	Stage 5 Provisional Issue
A	02/09/22	Planning
/	01/08/22	Fo BC Approval

Job: 2201 Ambassadors Theatre
Client: Ambassador Theatre Group

Drawing: Front Door G-ED01
Drawing no: 2201-5-700
Rev: D
Status: Stage 5
Scale: 1:10@A3, 1:5@A1
Date: 01/08/22

citizensdesignbureau
Ground Floor Units 01 & 03, 6 Westgate Street, London, E8 3RN
t : 02030959732
e : everyone@citizensdesignbureau.net