

NOTE: Drawing amended following comments received from Cameron Banks-Murray, Planning Case Officer

Do not scale this drawing. Contractor to confirm all dimensions on site. Notify architect immediately of any discrepancies.

Revisions:  
00 CH 26.05.22 Issued for Planning  
01 DH ##.10.22 Issued for Planning

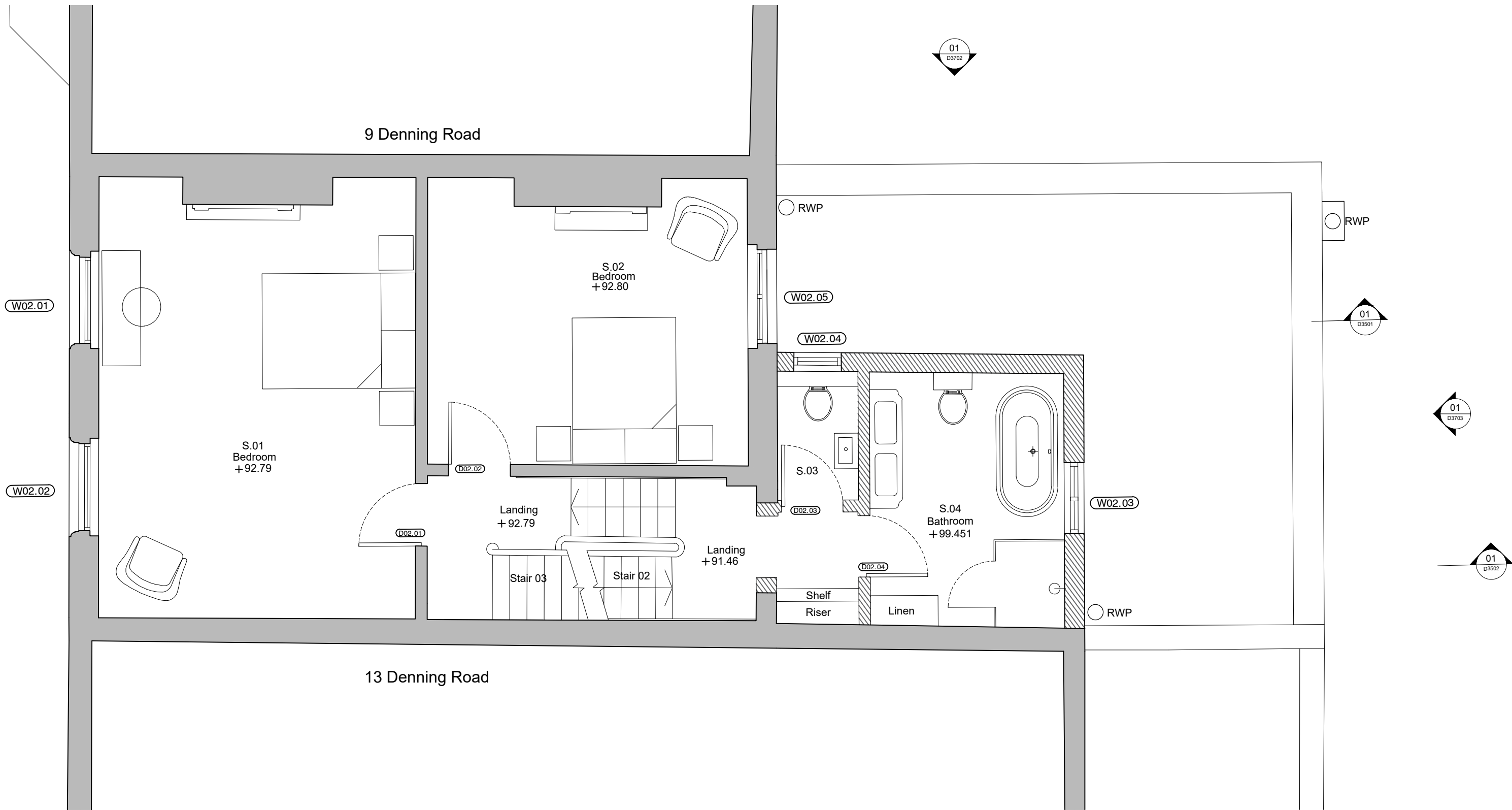

KEY:

- Existing building fabric
- Proposed building fabric
- Boundary line

Key Plan

FORMATION  
ARCHITECTS

Winchester House 1-3 Brixton Road London SW9 6DE  
T 020 7251 0781 W formationarchitects.co.uk

Project

11 Denning Road  
Hampstead  
Camden Town, London  
NW3 1ST

Client

Maja

Drawing Title

Proposed Plans  
Second Floor



0 0.5 1 1.5  
m

Drawn by

SK

Checked by

CH

Scale

1:50@A2

Status

For Planning

Job number

6922

Drawing number

D3102

Revision

01

01 Proposed Plan - Second Floor  
D3102 SCALE: 1:50