

REAR GARDEN

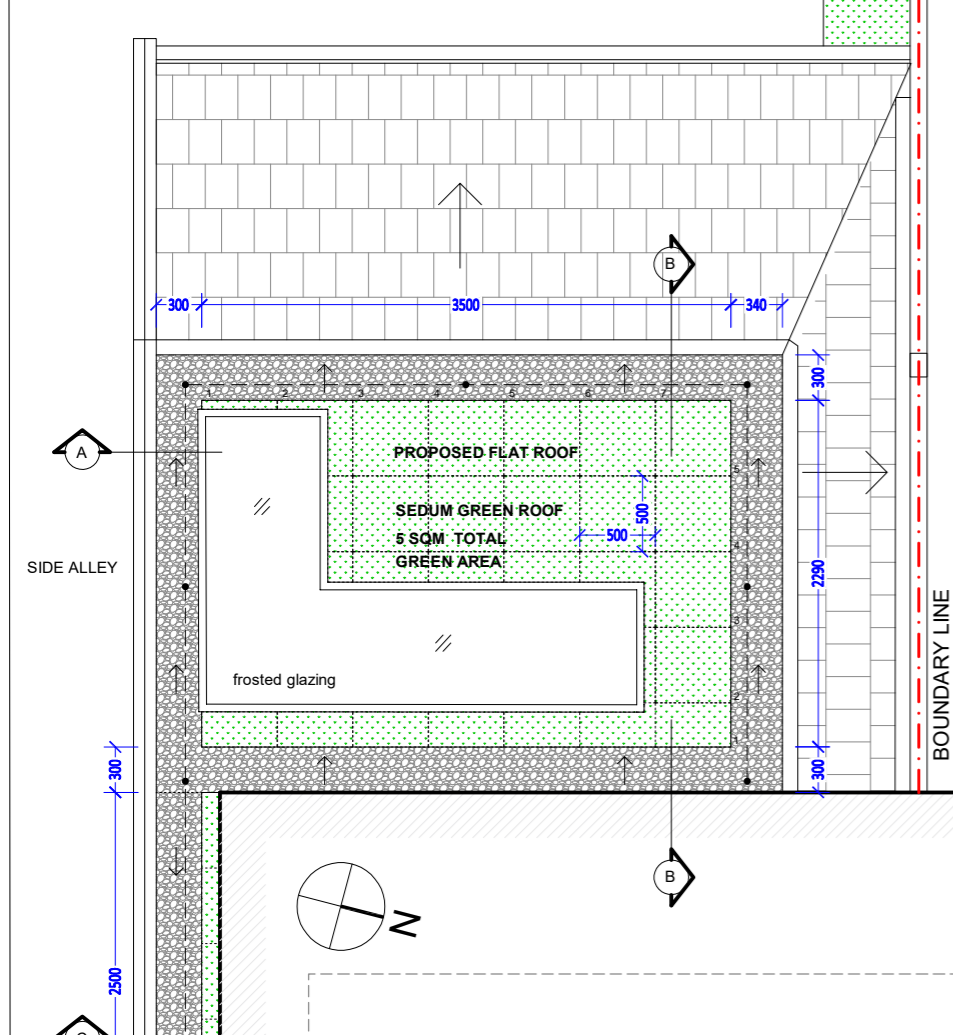

SEDUM EXTENSIVE GREEN ROOF BLANKET
 ENVIROMAT® SEDUM BLANKET
 REF: <https://www.turfonline.co.uk/product/SEDUM-EXTENSIVE-GREEN-ROOF-BLANKET/>
 ENVIROMAT® SEDUM BLANKET IS SEEDED WITH UP TO 18 DIFFERENT TYPES OF SEDUM.
 THE MATS ARE GROWN OUTDOORS IN A NORFOLK BASED NURSERY FOR 9-12 MONTHS ENSURING AT LEAST 95% COVERAGE.
 BLANKET IS PRE-POPULATED ENSURING INSTANT COVERAGE.
 THE PLANT SPECIES CHOSEN HAVE GREAT DISEASE RESISTANCE, DROUGHT TOLERANCE AND LONG FLOWERING PERIODS FROM EARLY APRIL UNTIL THE END OF OCTOBER. WHEN NOT IN FLOWER, THE FOLIAGE OF THE SEDUM PLANTS ARE EVERGREEN PROVIDING INTEREST ALL YEAR ROUND. THE MATTING IS MADE FROM RECYCLED PRODUCTS. THE SEDUM BLANKETS ARE ONLY DISPATCHED ONCE MATURE TO REDUCE LOSS OF SUBSTRATE DUE TO HANDLING. TRANSPORTATION OR HEAVY RAIN AFTER INSTALLATION THE GREEN ROOF INSTALLATION REQUIRES THE FOLLOWING: LIGHTWEIGHT GREEN ROOF SUBSTRATE - THE GROWING MEDIUM TO SUSTAIN PLANT LIFE. DRAINAGE BOARD - A LAYER TO CONTROL WATER BY ALLOWING JUST THE RIGHT AMOUNT TO BE STORED TO SUSTAIN THE SEDUM PLANTS AND ALLOWING THE EXCESS TO SAFELY DRAIN AWAY.
 SUITABLE EDGING - AN EDGING NOT ONLY IMPROVES THE LOOKS OF THE INSTALLATION BUT ENSURES ADEQUATE DRAINAGE.
 FLOWERING TIME: APRIL - SEPTEMBER (DEPENDING ON LOCAL WEATHER CONDITIONS).
 HEIGHT WHEN FULLY GROWN IS AROUND 150MM BUT CAN VARY DURING THE GROWING SEASON.
 SEDUM PLANTS ARE PERENNIAL AND FROST HARDY. CAN BE INSTALLED AT ANY TIME OF YEAR.
 STANDARD ROLL OF SEDUM EXTENSIVE GREEN ROOF BLANKET IS 500MM X 2000MM WHICH COVERS 1 SQUARE METRE. SATURATED WEIGHT: UP TO 25KG.
 PLANT SPECIES IN SEDUM EXTENSIVE GREEN ROOF BLANKET:
 NOTE: SPECIES AND PROPORTIONS MAY VARY DEPENDING ON AVAILABILITY OF SEED THROUGH THE SEASONS. NOT ALL SPECIES LISTED WILL APPEAR IN EVERY PIECE OF SEDUM GROUND MATTING.
 WIDOW'S CROSS (SEDUM PULCHELLUM)
 PURPLE CARPET (SEDUM SPURILUM COCCINEUM)
 SUMMER GLORY (SEDUM SPURILUM)
 SPANISH STONECROP (SEDUM HISPANICUM)
 MONTANUM ORIENTALE (SEDUM MONTANUM)
 OREGON STONECROP (SEDUM OREGANUM)
 WHITE STONECROP (SEDUM ALBUM)
 ORANGE STONECROP (SEDUM FLORIFERUM)
 CZAR'S GOLD (SEDUM HYBRIDUM)
 GOLD SEDUM (SEDUM KAMTCHATICUM)
 ELLACOMBANUM (SEDUM ELLACOMBANUM)
 ANGELINA (SEDUM RUPESTRE)
 CROOKED YELLOW STONECROP (SEDUM REFLEXUM)
 WORMLEAF STONECROP (SEDUM STENOPETALUM)
 TASTELESS STONECROP (SEDUM SEXANGULARE)
 STOLON STONECROP (SEDUM STOLONIFERUM)
 GOLDMOSS STONECROP (SEDUM ACRE)
 MEADOW SAXIFRAGE (SAXIFRAGA GRANULATA)
 PERISHABLE LIVING PRODUCTS
 SHOULD BE INSTALLED ON THE DAY OF DELIVERY

SEDUM ROOF: INSTALLTION AND WATERING
KEY POINTS FOR INSTALLATION:
 ENSURE ALL OTHER ROOF WORKS ARE COMPLETED BEFORE THE GREEN ROOF IS INSTALLED.
 TEST THE WATERING SYSTEM PRIOR TO THE DELIVERY OF THE VEGETATION. ENSURE THERE IS A WORKING WATER SOURCE AT ROOF LEVEL WITH SUFFICIENT PRESSURE AT THE POINT OF WATERING.
 DO NOT TRY TO INSTALL LIVING VEGETATION IN HOT, SUNNY WEATHER.
 ALL GREEN ROOFS REQUIRE WATER AT INSTALLATION AND IN HOT, DRY WEATHER. INSTALL ANY VEGETATION ON THE DAY IT IS DELIVERED.
 ENSURE THE VEGETATION BLANKETS ARE LAID CAREFULLY AND ADDITIONAL SUBSTRATE IS USED TO PATCH ANY OPEN JOINTS.
ESTABLISHMENT WATERING:
 ALL GREEN ROOFS REQUIRE SOME FORM OF ESTABLISHMENT WATERING WHICH SHOULD CONTINUE UNTIL THE PLANTS HAVE DEVELOPED A SOUND ROOT SYSTEM.
ESTABLISHMENT WATERING:
 CRITICALLY NEEDS A FULLY OPERATIONAL ROOFTOP WATER SUPPLY WITH ADEQUATE PRESSURE AND FLOW RATE AT THE POINT WHERE WATERING IS DELIVERED. THIS WATERING SHOULD BE VIA SURFACE SPRINKLERS OR ON SMALL ROOFS A HOSE WITH A FINE ROSE. THIS MUST BE CARRIED OUT EVEN WHEN AN IRRIGATION SYSTEM HAS BEEN FITTED THAT WILL COME INTO OPERATION AT A LATER STAGE. WATERING SHOULD TAKE PLACE IN THE EARLY MORNING OR EVENING TO REDUCE EVAPORATION. AVOID ANY TRAFFICKING OF THE ROOF. AVOID ANY STORAGE OF MATERIALS ON THE ROOF. CONTINUE TO WATER THE ROOF AS REQUIRED FOR THE WHOLE ESTABLISHMENT PERIOD.
WATERING GUIDELINES FOR DROUGHT:
 SEDUM IS A VERY DROUGHT RESISTANT PLANT AND WILL SURVIVE EVEN QUITE LONG PERIODS OF DROUGHT, HOWEVER IT WILL BENEFIT FROM THE OCCASIONAL SOAKING I.E. IN PROLONGED HOT, DRY WEATHER (2-3 WEEKS WITHOUT RAIN IN THE SUMMER MONTHS).
 ADVISE: WATER HEAVILY ONCE EVERY WEEK. WATER THE SEDUM UNTIL THE VEGETATION AND SUBSTRATE ARE TOTAL SOAKED.
 NOTE: SEDUM TURNS RED WHEN STRESSED THROUGH LACK OF WATER. OVERWATERING WILL ENCOURAGE GRASS AND WEED SPECIES TO ESTABLISH. UNDERWATERING WILL SHRINK THE SEDUM PLANTS ENABLING EROSION OF THE EXPOSED SUBSTRATE.

ANNUAL MAINTENANCE SCHEME OF SEDUM ROOF:

- ROOF INSPECTION**
 INSPECT THE SEDUM ROOF AT LEAST TWICE A YEAR FOR WEEDS AND SEEDS (CARRIED BY THE WIND) AND REMOVE THIS UNWANTED VEGETATION MANUALLY. DO THIS PREFERABLY IN SPRING AND AUTUMN. TO ENCOURAGE BIODIVERSITY, THE USE OF CHEMICAL PESTICIDES IS NOT RECOMMENDED. IN ADDITION, CHECK WHETHER THE DRAINAGE SYSTEM IS STILL FUNCTIONING PROPERLY. REMOVE ANY LEAVES BLOWN INTO THE GUTTERS AND DRAINS. THE NUMBER OF INSPECTIONS WILL DEPEND ON THE GREENERY IN THE VICINITY OF THE ROOF.
- FERTILIZATION**
 AN EXTENSIVE GREEN ROOF MUST BE FERTILIZED TWICE A YEAR. THE BEST PERIOD FOR FERTILIZING THE SEDUM ROOF IS LATE APRIL AND EARLY SEPTEMBER. THE FERTILIZATION ENSURES AN EVEN SUPPLY OF NUTRIENTS, WHICH RESULTS IN HEALTHY AND STRONG PLANTING.
- IRRIGATION**
 A WELL-ROOTED SEDUM ROOF REQUIRES NO ADDITIONAL WATER. ONLY UNDER VERY DRY CONDITIONS IS IT NECESSARY TO PROVIDE THE GREEN ROOF WITH WATER. AN IRRIGATION SYSTEM MAY BE REQUIRED DEPENDING ON THE CLIMATE ZONE IN WHICH THE GREEN ROOF IS LOCATED.



KM ARCHITECTURE
 telephone +44 (0)7533993131
 kristijanmitrovski@gmail.com

WALLBARN M-TRAY GREEN ROOF INSTALLATION



WALLBARN M-TRAY GREEN ROOF EXAMPLE GREEN ROOF



1 PROPOSED GREEN ROOF PLAN
 Scale 1:50@ A3

2 DETAIL A - SECTION WITH GABLE WALL
 Scale 1:20@ A3

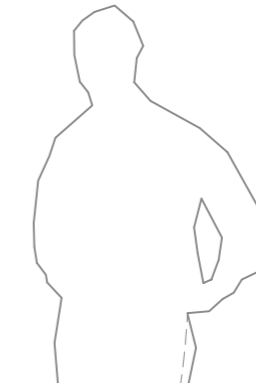
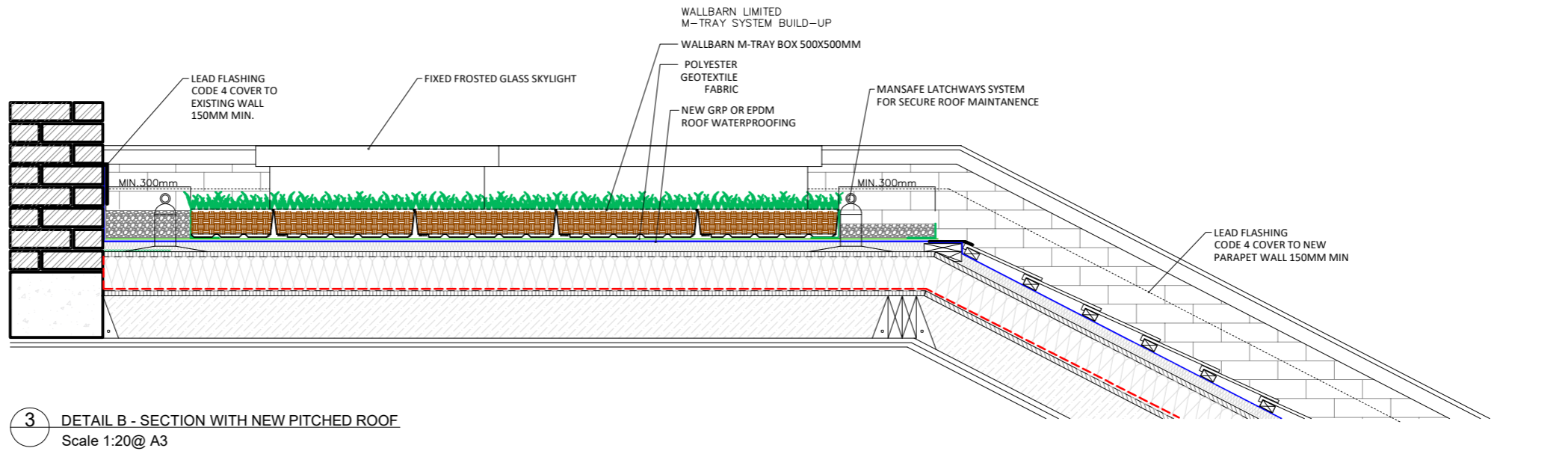
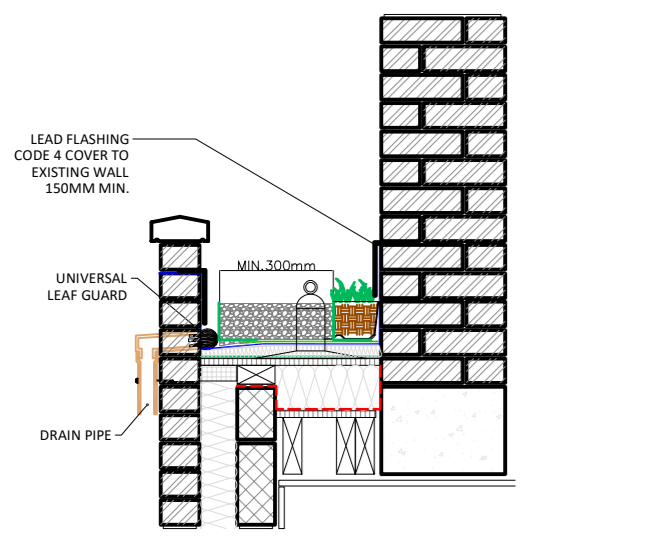

PLANNING
 PLANNING CONDITION 4
 APPLICATION REF: 2022/3308/P

NO.	DATE	ISSUE

CLIENT
 Private Client
 4 Strathray Gardens,
 London, England
 NW3 4NY

PROJECT
 220212- 4 Strathray Gardens
 Camden
 NW3 4NY

DRAWING TITLE
 GREEN FLAT SEDUM ROOF
 PLAN AND DETAILS

DATE
 23/03/2023

DRAWING NO.
 A110

REVISION
 /

SCALE
 1:20 & 1:50@A3
 1:40 & 1:100@A4

JOB REF.
 220212

DRAWN BY
 Kristijan Mitrovski