

- NOTES:**
1. THIS DRAWING SHALL BE READ IN CONJUNCTION WITH ALL MNRP CONSULTANTS LTD DRAWINGS AND ALL OTHER RELEVANT ARCHITECT'S, ENGINEER'S AND LANDSCAPE ARCHITECT'S DRAWINGS AND SPECIFICATIONS.
 2. ALL DIMENSIONS AND LEVELS SHOWN ARE IN METERS UNLESS OTHERWISE STATED.
 3. LAYOUTS ARE A COMBINATION OF BOTH TOPOGRAPHICAL SURVEY AND ORDNANCE SURVEY. TOPOGRAPHICAL SURVEY INFORMATION SUPPLIED BY CD SURVEYS LTD (08/07/2022) DRAWING REF LBC/22040541/1. CLARIFICATION AND DISCREPANCIES TO BE BROUGHT TO THE ATTENTION OF THE SITE ENGINEER.
 4. ALL ROAD MARKINGS SHALL COMPLY WITH THE TRAFFIC SIGNS REGULATIONS AND GENERAL DIRECTIONS 2016.
 5. EXTRA CARE SHALL BE TAKEN WHEN WORKING WITHIN BS 5837 TREE ROOT PROTECTION AREAS.

- LEGEND:**
- PROPOSED ROAD MARKING:
 - WHITE
 - YELLOW
 - PROPOSED KERBS:
 - 150x300mm GRANITE EDGE
 - 300x200mm GRANITE EDGE
 - 300x150mm GRANITE DROPPED KERB
 - 300x200x914mm GRANITE TRANSITION (DROPPER) KERB
 - 60/80 CONCRETE DEMARCATION BLOCKS
 - BY THIRD PARTY:
 - EXISTING BUS SHELTER TO BE RELOCATED
 - PROPOSED BUS SHELTER
 - BS PROPOSED BUS FLAG
 - PROPOSED GREENING AREAS

REV	DATE	DRAWN	T. CHECKED	T. APPROVED	P. APPROVED	AUTHORISED
P02	14/02/2023					
FOR INFORMATION						
P01	10/02/2023					
FOR INFORMATION						
PURPOSE/DESCRIPTION						

RESTRICTED

Project
HIGH HOLBORN CYCLE SAFETY

Originator
METIS CONSULTANTS LTD

Location
LONDON BOROUGH OF CAMDEN

Asset Classification
PRELIMINARIES

Lifecycle
CONCEPT DESIGN

Suitability
S2 | FOR INFORMATION

Title
**BUS STOP RELOCATION
RED LION SQUARE (STOP J) - CAM0026AB
SHEET 1 OF 3**

Prepared by:
METIS
metisconsultants.co.uk

Prepared for:
Camden

Drawing Number
22271-METCS-011-02_01-DRG-CE-001

Rev.
P02

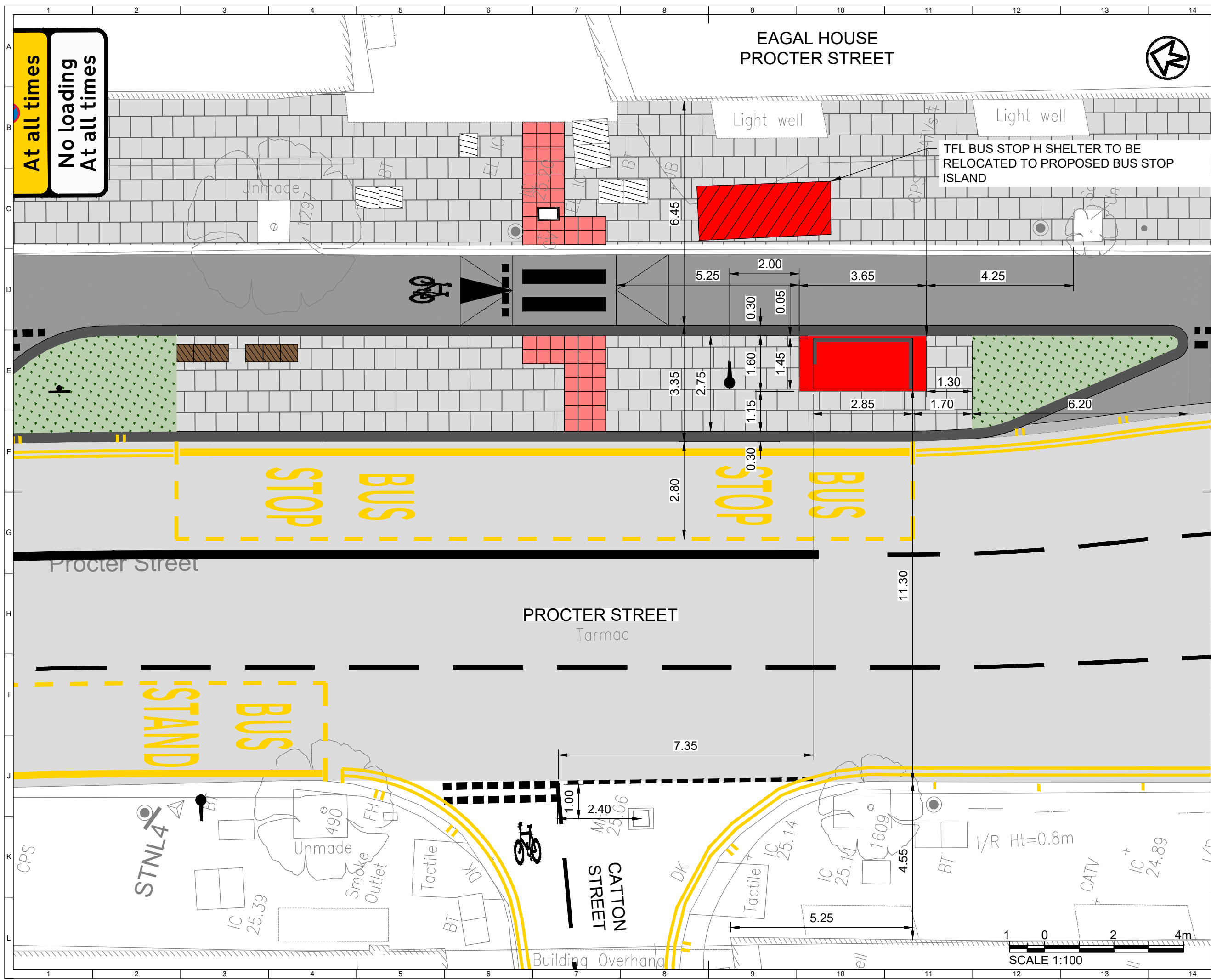

At all times
No loading
At all times

**EAGAL HOUSE
PROCTER STREET**



**TFL BUS STOP H SHELTER TO BE
RELOCATED TO PROPOSED BUS STOP
ISLAND**

- NOTES:**
1. THIS DRAWING SHALL BE READ IN CONJUNCTION WITH ALL MNRP CONSULTANTS LTD DRAWINGS AND ALL OTHER RELEVANT ARCHITECT'S, ENGINEER'S AND LANDSCAPE ARCHITECT'S DRAWINGS AND SPECIFICATIONS.
 2. ALL DIMENSIONS AND LEVELS SHOWN ARE IN METERS UNLESS OTHERWISE STATED.
 3. LAYOUTS ARE A COMBINATION OF BOTH TOPOGRAPHICAL SURVEY AND ORDNANCE SURVEY. TOPOGRAPHICAL SURVEY INFORMATION SUPPLIED BY CD SURVEYS LTD (08/07/2022) DRAWING REF LBC/22040541/1. CLARIFICATION AND DISCREPANCIES TO BE BROUGHT TO THE ATTENTION OF THE SITE ENGINEER.
 4. ALL ROAD MARKINGS SHALL COMPLY WITH THE TRAFFIC SIGNS REGULATIONS AND GENERAL DIRECTIONS 2016.
 5. EXTRA CARE SHALL BE TAKEN WHEN WORKING WITHIN BS 5837 TREE ROOT PROTECTION AREAS.

- LEGEND:**
- PROPOSED ROAD MARKING:**
 - WHITE
 - YELLOW
 - PROPOSED KERBS:**
 - 150x300mm GRANITE EDGE
 - 300x200mm GRANITE EDGE
 - 300x150mm GRANITE DROPPED KERB
 - 300x200x914mm GRANITE TRANSITION (DROPPER) KERB
 - 60/80 CONCRETE DEMARCATION BLOCKS
 - BY THIRD PARTY:**
 - EXISTING BUS SHELTER TO BE RELOCATED
 - PROPOSED BUS SHELTER
 - BS PROPOSED BUS FLAG
 - PROPOSED GREENING AREAS

AMENDED BUS SHELTER DIMENSIONS					
PO2	14/02/2023	D. BULL	D. DVORNIK	T. DE JAGER	M. ELLMAN
PO1	10/02/2023	D. BULL	D. DVORNIK	T. DE JAGER	M. ELLMAN
REV	DATE	PURPOSE/DESCRIPTION	T. CHECKED	T. APPROVED	P. APPROVED

RESTRICTED

Project
HIGH HOLBORN CYCLE SAFETY

Originator
METIS CONSULTANTS LTD

Location
LONDON BOROUGH OF CAMDEN

Asset Classification
PRELIMINARIES

Lifecycle
CONCEPT DESIGN

Suitability
S2 | FOR INFORMATION

Title
**BUS STOP RELOCATION
PROCTER STREET (STOP J) - CAM0076AB
SHEET 2 OF 3**

Prepared by:
METIS
metisconsultants.co.uk

Prepared for:
Camden

Drawing Number
22271-METCS-011-02_01-DRG-CE-002

Rev.
P02

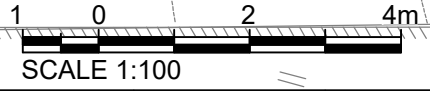

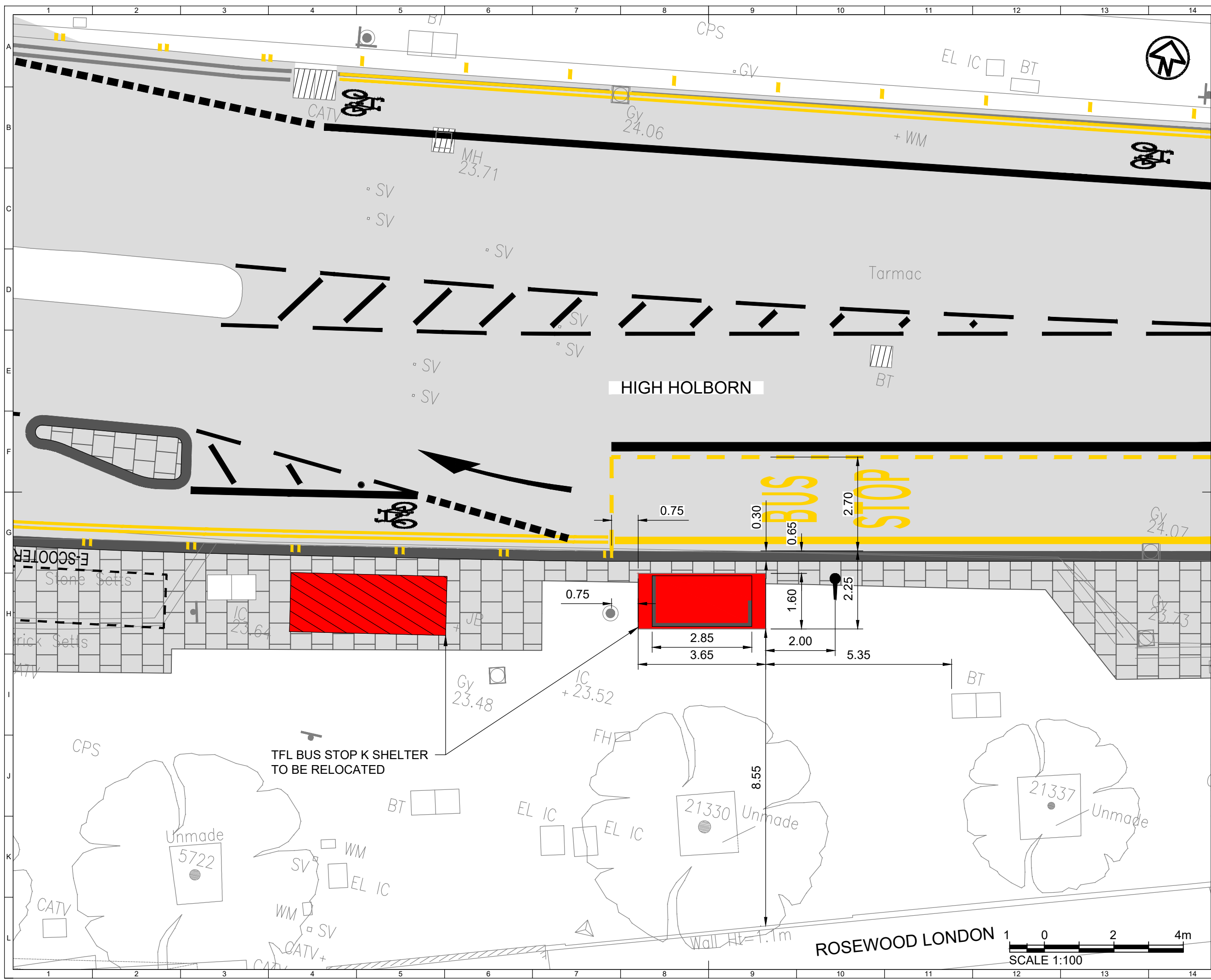

- NOTES:
1. THIS DRAWING SHALL BE READ IN CONJUNCTION WITH ALL MNRP CONSULTANTS LTD DRAWINGS AND ALL OTHER RELEVANT ARCHITECT'S, ENGINEER'S AND LANDSCAPE ARCHITECT'S DRAWINGS AND SPECIFICATIONS.
 2. ALL DIMENSIONS AND LEVELS SHOWN ARE IN METERS UNLESS OTHERWISE STATED.
 3. LAYOUTS ARE A COMBINATION OF BOTH TOPOGRAPHICAL SURVEY AND ORDNANCE SURVEY. TOPOGRAPHICAL SURVEY INFORMATION SUPPLIED BY CD SURVEYS LTD (08/07/2022) DRAWING REF LBC/22040541/1. CLARIFICATION AND DISCREPANCIES TO BE BROUGHT TO THE ATTENTION OF THE SITE ENGINEER.
 4. ALL ROAD MARKINGS SHALL COMPLY WITH THE TRAFFIC SIGNS REGULATIONS AND GENERAL DIRECTIONS 2016.
 5. EXTRA CARE SHALL BE TAKEN WHEN WORKING WITHIN BS 5837 TREE ROOT PROTECTION AREAS.

- LEGEND:
- PROPOSED ROAD MARKING:
 - WHITE
 - YELLOW
 - PROPOSED KERBS:
 - 150x300mm GRANITE EDGE
 - 300x200mm GRANITE EDGE
 - 300x150mm GRANITE DROPPED KERB
 - 300x200x914mm GRANITE TRANSITION (DROPPER) KERB
 - 60/80 CONCRETE DEMARCATION BLOCKS
 - BY THIRD PARTY:
 - EXISTING BUS SHELTER TO BE RELOCATED
 - PROPOSED BUS SHELTER
 - BS PROPOSED BUS FLAG
 - PROPOSED GREENING AREAS

REV	DATE	PURPOSE/DESCRIPTION	T. CHECKED	T. APPROVED	P. APPROVED	AUTHORISED
P02	14/02/2023	AMENDED BUS SHELTER DIMENSIONS FOR INFORMATION	D. DVORNIK	T. DE JAGER	T. DE JAGER	M. ELLMAN
P01	10/02/2023	FOR INFORMATION	D. DVORNIK	T. DE JAGER	T. DE JAGER	M. ELLMAN

RESTRICTED

Project	HIGH HOLBORN CYCLE SAFETY
Originator	METIS CONSULTANTS LTD
Location	LONDON BOROUGH OF CAMDEN
Asset Classification	PRELIMINARIES
Lifecycle	CONCEPT DESIGN
Suitability	S2 FOR INFORMATION
Title	BUS STOP RELOCATION HOLBORN STATION (STOP K) - CAM0154AB SHEET 3 OF 3

Prepared by:	metisconsultants.co.uk
Prepared for:	
Drawing Number	22271-METCS-011-02_01-DRG-CE-003
Rev.	P02

