

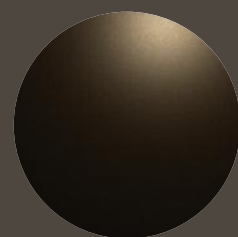

N. Foster design passenger shelter

Overview

Colours



Green
RAL 6014



Chain metal grey
JCD 7002

Other colours from our range
by customer choice

Designed by N.Foster and
developed by JCDecaux

12 people sheltered

5/6 seat capacity

6.8 m² covered area

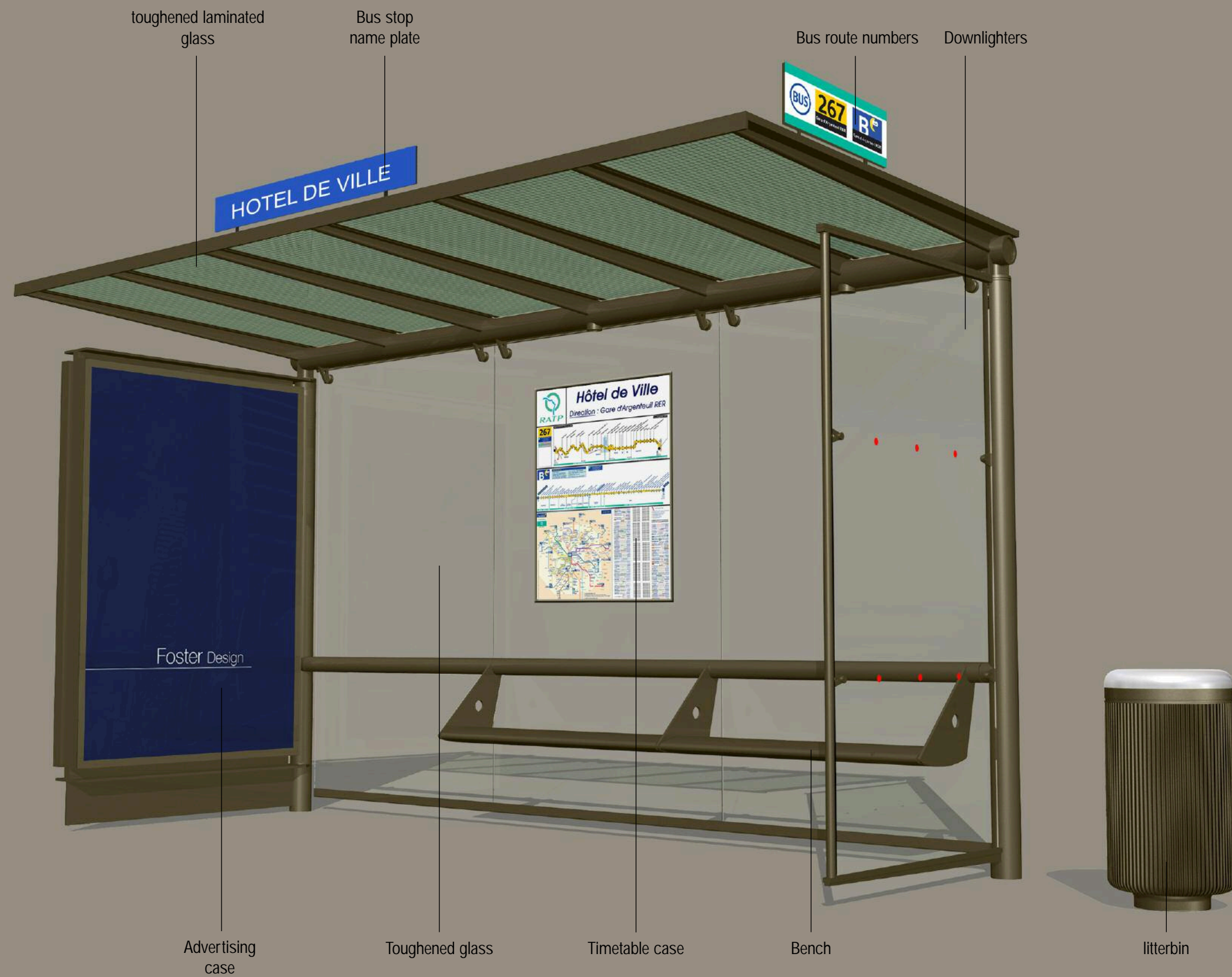

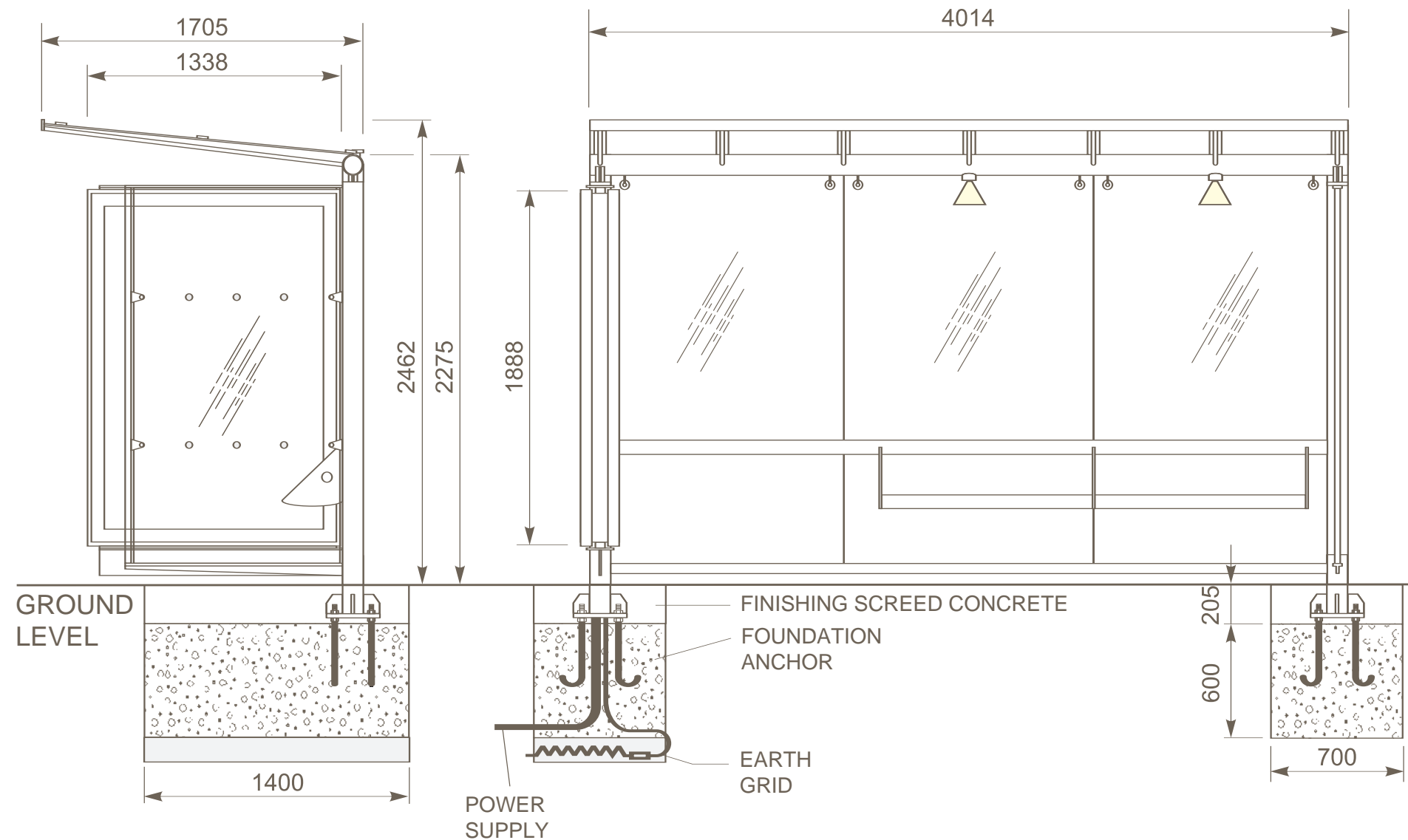

Option, if contracted :
Litterbin

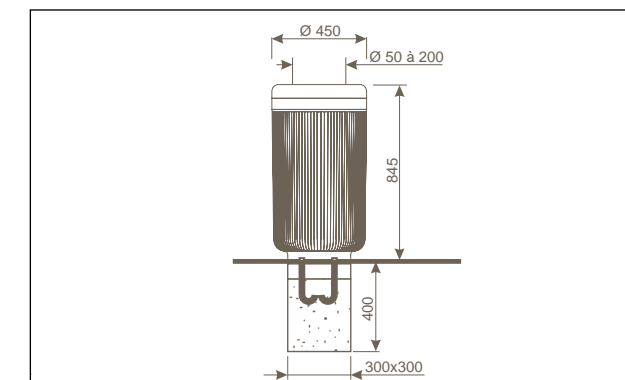

Capacity 60 litres
Basket and body in rotomoulded, mass pigmented high density black polyethylene
Lid in pressed aluminium
Unlocked via special security key to remove the basket
Sealing kit available in the event of anti-terrorism measures

Option, if contracted :
Stop name

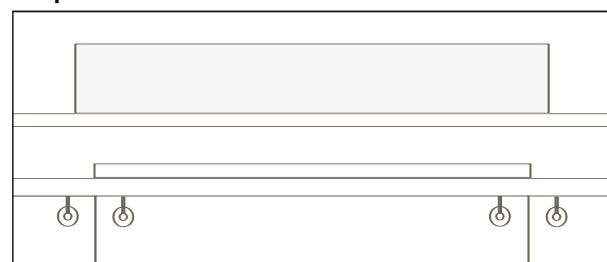

Painted aluminium plate fixed to the roof
Self-adhesive vinyl lettering
Dimensions to suit requirements

Option, if contracted :
Bus route numbers and directions

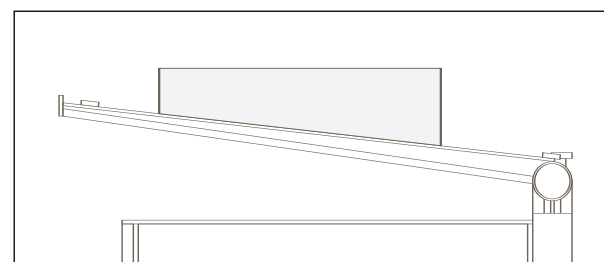

Painted aluminium plate
Self-adhesive vinyl lettering
Dimensions to suit requirements

Bench

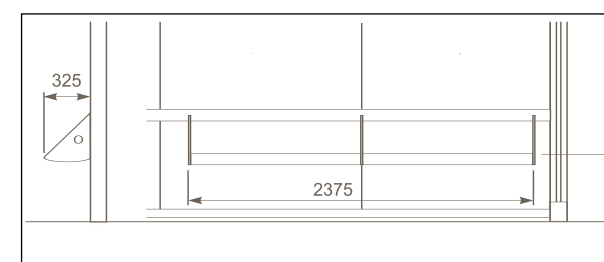

Moulded structural foam and glass reinforced polyester sandwich
Requires no separate foundations

Timetable case

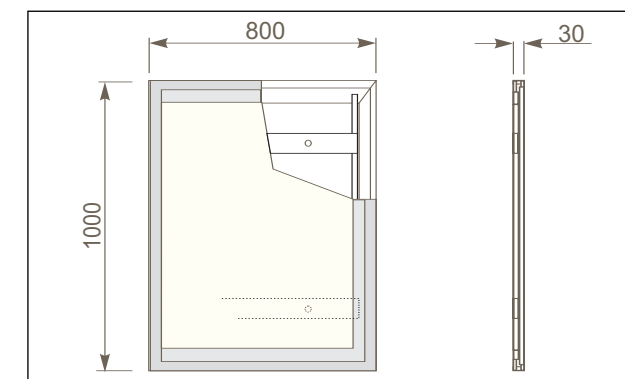

Secured to one of the rear glasses
Assembled from extrusions
Fixings to NF E25/27
3 mm thick polycarbonate glazing
Anti mist system
Dimensions to suit requirements

Technical description

Structure

FRAME

Comprised of two tubular uprights connected by the bench cross-member and topped by the roof

One of the posts is fitted with a door to access the electrical supply. Serves for cable routing

WALLS

An assembly comprised of three rear and one return glass, secured to the frame by glass cleats. Toughened glass used throughout (this type of glass forms small cube-shaped pieces in the event of breakage, avoiding the risk of injury)

Glass terminated a few centimetres above ground level to accumulation of litter inside the shelter

ROOF

A welded steel construction, supporting 6 panels of toughened laminated glass, which cannot fall in the event of breakage

The glass is specially treated to reduce the heat of the sun rays by more than 50%

Waterproofing is ensured by seals fitted in the glazing bars

Maximum load bearing capacity 250kg/m²

Sloped to drain rainwater behind rear glass

Advertising case

Of aluminium extrusion construction, borne by top and bottom arms welded to a frame upright. Fitted with two top hung doors

Dust and water ingress protection index: IP34

Houses the mains connection board.

Lit with 4 fluorescent tubes

Excellent backlight quality provided by internal diffusers

Posters may be suspended by clips or a fold and rail system

Contributes to the internal illumination of the shelter

Foundations

Comprised of concrete slabs incorporating foundation anchors and providing services inlets

Calculated for extreme weather conditions

Fitted with an earth grid with copper connection for earthing of the structure

The slab dimensions are optimised to minimise surface area occupied. A high quality finish is ensured around the posts

Gradients up to 6% are catered for as standard

The shelter can be mounted on a steel frame if required

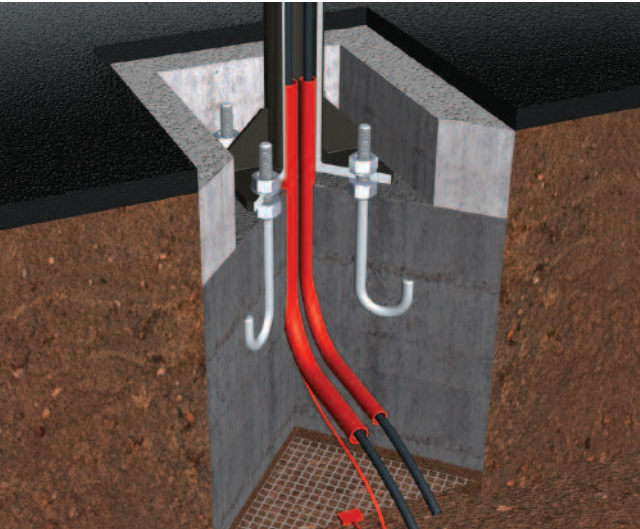

Bench

Comprised of a 5/6 person seat secured to the shelter frame

Central separation prevent misuse of the bench

An ergonomically designed seat

Fitted with a backrest

Requires no separate foundations

Materials

MATERIALS	ANTI-CORROSION TREATMENT	FINISH	MAIN ITEMS
steel	hot dip galvanizing spun galvanizing	80 micron powder coating	posts bench arms roof glasslegs foundation anchors
stainless steel	passivation	beadblasting and electropolishing	bench seats fixings
aluminium	anodisation	80 micron powder coating	adcase ; timetable case name and line number plates
toughened glass		silk screen printed enamel	vertical glass
toughened laminated glass		anti-heat treatment	roof glass
synthetic rubber		mass pigmented	seals
B25 concrete			foundations

Electrics

Connected to public lighting or mains supply

Factory tested for electrical insulation and earth continuity

Supply 220/240V- 50 Hz

Protected by residual current circuit protection device (RCCD) 25A-30mA

Mains isolator 6A

POWER RATING

shelter 45 VA

advertising case 216 VA

CONSUMPTION

Shelter 0.36 kWh/day

advertising case 2,5 kWh/day

based on 4200 hours per year lighting

Lighting

Provided by two halogen spotlights located in the roof beam

Secured with tamper-proof fixings to prevent vandalism

Blends elegantly with the design

Illuminates the timetable case

Fed from the advertising case

Standards

Design and manufacture processes to ISO 9001 (version 2000)

MECHANICAL
- mechanical construction rules
- aluminium construction rules DTU 13.12
- foundation calculations
mechanical CM66
eurocode 2 and 3
BAEL 91 for reinforced concrete
DTU 39 glass parts
NFE 25/27 for fixings

ÉLECTRICAL
NFC 15-100
NFC 17-200
CE

Safety

- Unobstructed view
- Hidden frame fixings preventing vandalism
- Glass changed from outside to avoid inconvenience to users
- Visible warning during all maintenance and repair operations
- Modular glass concept eases individual handling of glazing panels

Resistance to vandalism

- Impact resistance index : IK 07
- Locking of doors via a special security key
- No visible fixings
- No visible wires
- Toughened glass walls
- Toughened laminated glassroof
- Made from materials unaffected by outdoor exposure



A protected space to all relevant standards

Treatments applied to ensure longevity of the shelter

A roof that withstands the weight of 21 persons

Glazed roof

A shelter that will resist wind speeds up to 180 km/h

Rainwater effectively channelled away

Perfect integration into the walkway surface

Designed for ease of maintenance

Any risk of injury avoided through use of toughened glass throughout

N. Foster design passenger shelter
Technical description

Modularity

Different configurations in accordance with passenger volumes, urban planning and local installation constraints.

The shelter is available with either 3 or 6 rear glasses

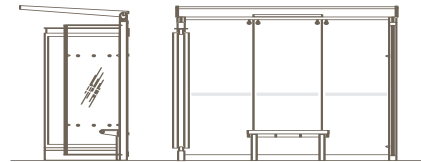

Passenger shelter

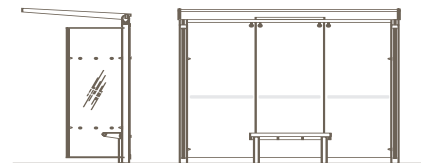

Non-advertising passenger shelter

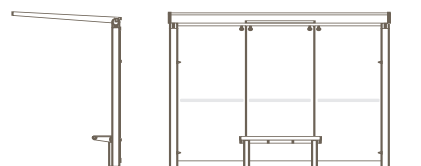

Non-advertising passenger shelter
without return glasses

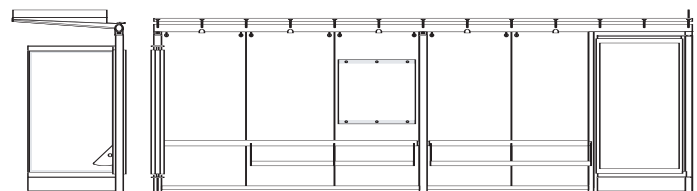

Double shelter

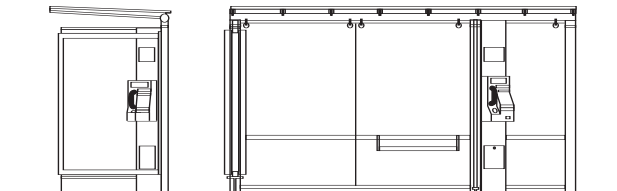

Bus shelter with phone booth



Bus shelter with automatic public toilet