

RED LION SQUARE GARDENS

Brick Wall
Ht: 0.20m

TFL BUS STOP J SHELTER TO BE RELOCATED TO PROPOSED BUS STOP ISLAND

RED LION SQUARE

PROCTER STREET

FISHER STREET

- NOTES:
1. THIS DRAWING SHALL BE READ IN CONJUNCTION WITH ALL MNRP CONSULTANTS LTD DRAWINGS AND ALL OTHER RELEVANT ARCHITECT'S, ENGINEER'S AND LANDSCAPE ARCHITECT'S DRAWINGS AND SPECIFICATIONS.
 2. ALL DIMENSIONS AND LEVELS SHOWN ARE IN METERS UNLESS OTHERWISE STATED.
 3. LAYOUTS ARE A COMBINATION OF BOTH TOPOGRAPHICAL SURVEY AND ORDNANCE SURVEY. TOPOGRAPHICAL SURVEY INFORMATION SUPPLIED BY CD SURVEYS LTD (08/07/2022) DRAWING REF LBC/22040541/1. CLARIFICATION AND DISCREPANCIES TO BE BROUGHT TO THE ATTENTION OF THE SITE ENGINEER.
 4. ALL ROAD MARKINGS SHALL COMPLY WITH THE TRAFFIC SIGNS REGULATIONS AND GENERAL DIRECTIONS 2016.
 5. EXTRA CARE SHALL BE TAKEN WHEN WORKING WITHIN BS 5837 TREE ROOT PROTECTION AREAS.

- LEGEND:
- PROPOSED ROAD MARKING:
 - WHITE
 - YELLOW
 - PROPOSED KERBS:
 - 150x300mm GRANITE EDGE
 - 300x200mm GRANITE EDGE
 - 300x150mm GRANITE DROPPED KERB
 - 300x200x914mm GRANITE TRANSITION (DROPPER) KERB
 - 60/80 CONCRETE DEMARCATION BLOCKS
 - BY THIRD PARTY:
 - EXISTING BUS SHELTER TO BE RELOCATED
 - PROPOSED BUS SHELTER
 - BS PROPOSED BUS FLAG
 - PROPOSED GREENING AREAS

REV	DATE	DRAWN	T. CHECKED	T. APPROVED	P. APPROVED	AUTHORISED
P01	03/03/2023	D. BULL	D. DVORNIK	T. DE JAGER	T. DE JAGER	M. ELLMAN

RESTRICTED

Project
HIGH HOLBORN CYCLE SAFETY

Originator
METIS CONSULTANTS LTD

Location
LONDON BOROUGH OF CAMDEN

Asset Classification
PRELIMINARIES

Lifecycle
CONCEPT DESIGN

Suitability
S2 | FOR INFORMATION

Title
BUS STOP RELOCATION
RED LION SQUARE (STOP J) - CAM0026AB
SHEET 1 OF 3

Prepared by: **METIS**
metisconsultants.co.uk

Prepared for: **Camden**

Drawing Number
22271-METCS-011-02_01-DRG-CE-001

Rev.
P01

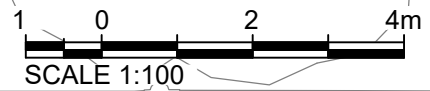

EAGAL HOUSE
PROCTER STREET



NOTES:

1. THIS DRAWING SHALL BE READ IN CONJUNCTION WITH ALL MNRP CONSULTANTS LTD DRAWINGS AND ALL OTHER RELEVANT ARCHITECT'S, ENGINEER'S AND LANDSCAPE ARCHITECT'S DRAWINGS AND SPECIFICATIONS.
2. ALL DIMENSIONS AND LEVELS SHOWN ARE IN METERS UNLESS OTHERWISE STATED.
3. LAYOUTS ARE A COMBINATION OF BOTH TOPOGRAPHICAL SURVEY AND ORDNANCE SURVEY. TOPOGRAPHICAL SURVEY INFORMATION SUPPLIED BY CD SURVEYS LTD (08/07/2022) DRAWING REF LBC/22040541/1. CLARIFICATION AND DISCREPANCIES TO BE BROUGHT TO THE ATTENTION OF THE SITE ENGINEER.
4. ALL ROAD MARKINGS SHALL COMPLY WITH THE TRAFFIC SIGNS REGULATIONS AND GENERAL DIRECTIONS 2016.
5. EXTRA CARE SHALL BE TAKEN WHEN WORKING WITHIN BS 5837 TREE ROOT PROTECTION AREAS.

LEGEND:

- PROPOSED ROAD MARKING:
 — WHITE
 — YELLOW
- PROPOSED KERBS:
 — 150x300mm GRANITE EDGE
 — 300x200mm GRANITE EDGE
 — 300x150mm GRANITE DROPPED KERB
 — 300x200x914mm GRANITE TRANSITION (DROPPER) KERB
 — 60/80 CONCRETE DEMARCATION BLOCKS
- BY THIRD PARTY:
 ■ EXISTING BUS SHELTER TO BE RELOCATED
 ■ PROPOSED BUS SHELTER
- BS PROPOSED BUS FLAG
- PROPOSED GREENING AREAS

FOR INFORMATION					
REV	DATE	DRAWN	T. CHECKED	T. APPROVED	P. APPROVED / AUTHORISED
P01	03/03/2023	D. BULL	D. DVORNIK	T. DE JAGER	T. DE JAGER / M. ELLMAN

RESTRICTED

Project	HIGH HOLBORN CYCLE SAFETY
Originator	METIS CONSULTANTS LTD
Location	LONDON BOROUGH OF CAMDEN
Asset Classification	PRELIMINARIES
Lifecycle	CONCEPT DESIGN
Suitability	S2 FOR INFORMATION

Title
 BUS STOP RELOCATION
 PROCTER STREET (STOP H) - CAM0076AB
 SHEET 2 OF 3

Prepared by: **METIS**
 metisconsultants.co.uk

Prepared for: **Camden**

Drawing Number
 22271-METCS-011-02_01-DRG-CE-002

Rev.
 P01

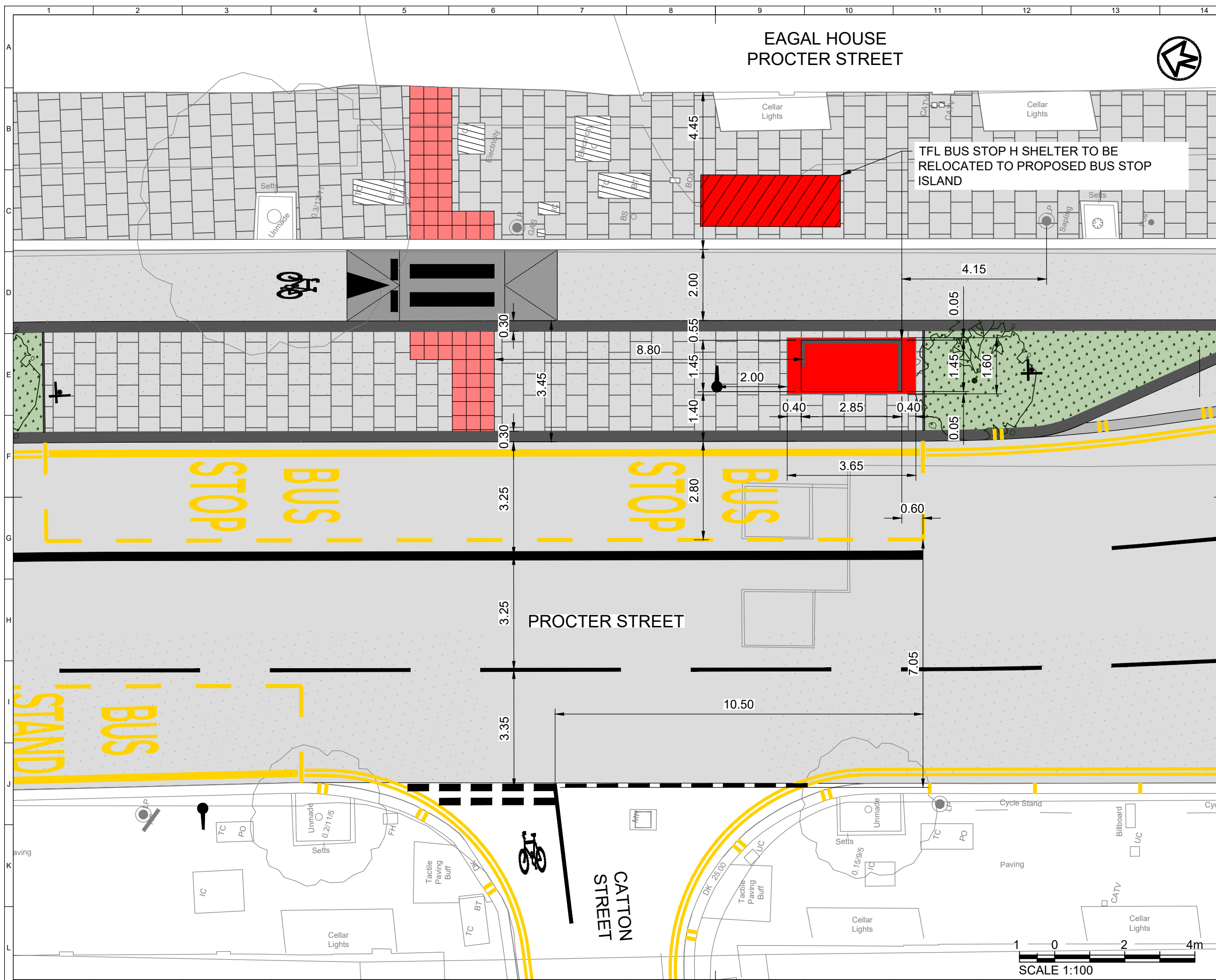

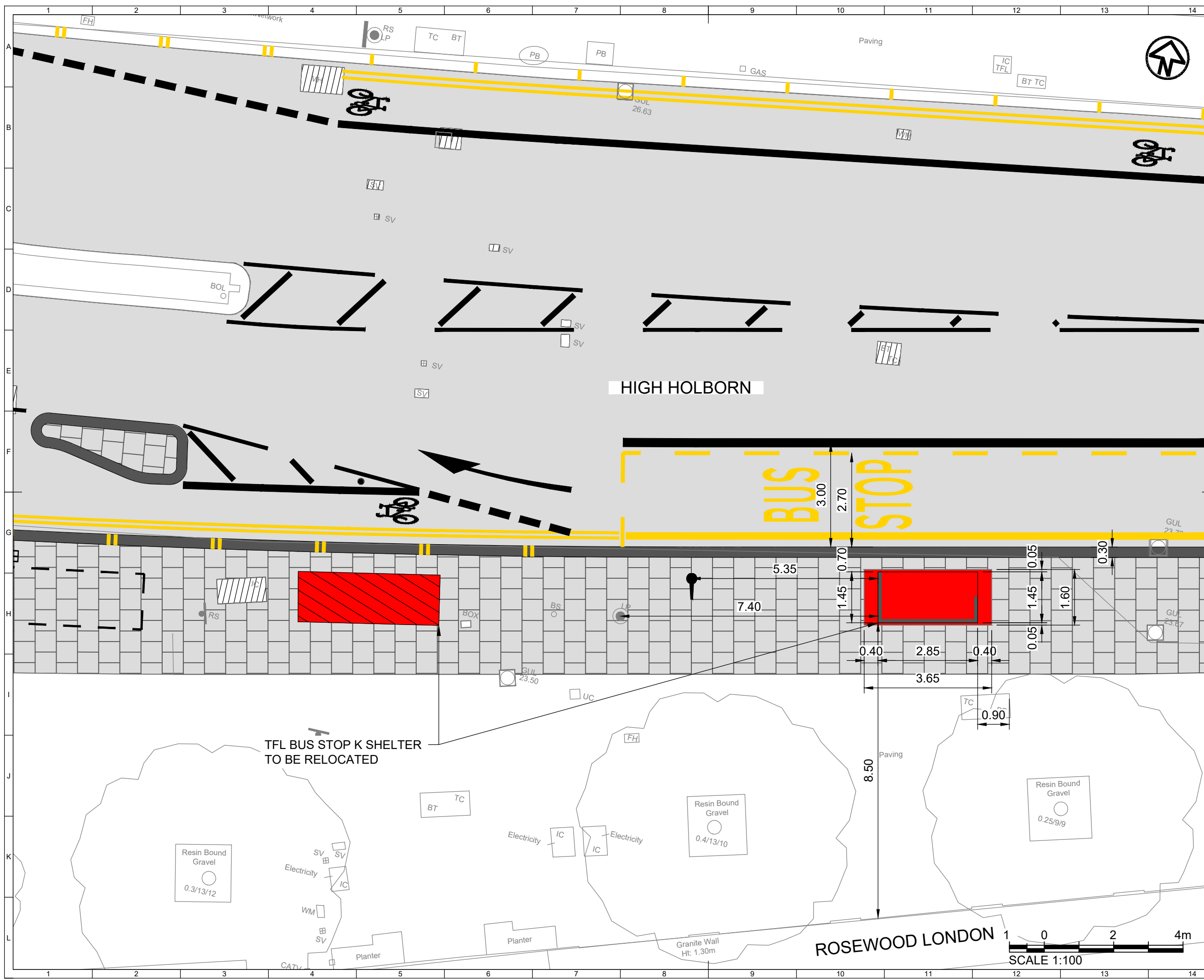

- NOTES:
1. THIS DRAWING SHALL BE READ IN CONJUNCTION WITH ALL MNRP CONSULTANTS LTD DRAWINGS AND ALL OTHER RELEVANT ARCHITECT'S, ENGINEER'S AND LANDSCAPE ARCHITECT'S DRAWINGS AND SPECIFICATIONS.
 2. ALL DIMENSIONS AND LEVELS SHOWN ARE IN METERS UNLESS OTHERWISE STATED.
 3. LAYOUTS ARE A COMBINATION OF BOTH TOPOGRAPHICAL SURVEY AND ORDNANCE SURVEY. TOPOGRAPHICAL SURVEY INFORMATION SUPPLIED BY CD SURVEYS LTD (08/07/2022) DRAWING REF LBC/22040541/1. CLARIFICATION AND DISCREPANCIES TO BE BROUGHT TO THE ATTENTION OF THE SITE ENGINEER.
 4. ALL ROAD MARKINGS SHALL COMPLY WITH THE TRAFFIC SIGNS REGULATIONS AND GENERAL DIRECTIONS 2016.
 5. EXTRA CARE SHALL BE TAKEN WHEN WORKING WITHIN BS 5837 TREE ROOT PROTECTION AREAS.

- LEGEND:
- PROPOSED ROAD MARKING:
 - WHITE
 - YELLOW
 - PROPOSED KERBS:
 - 150x300mm GRANITE EDGE
 - 300x200mm GRANITE EDGE
 - 300x150mm GRANITE DROPPED KERB
 - 300x200x914mm GRANITE TRANSITION (DROPPER) KERB
 - 60/80 CONCRETE DEMARCATION BLOCKS
 - BY THIRD PARTY:
 - EXISTING BUS SHELTER TO BE RELOCATED
 - PROPOSED BUS SHELTER
 - BS PROPOSED BUS FLAG
 - PROPOSED GREENING AREAS

FOR INFORMATION				
D. BULL	D. DVORNIK	T. DE JAGER	T. DE JAGER	M. ELLMAN
REV	DATE	DRAWN	CHECKED	APPROVED

RESTRICTED

Project	HIGH HOLBORN CYCLE SAFETY
Originator	METIS CONSULTANTS LTD
Location	LONDON BOROUGH OF CAMDEN
Asset Classification	PRELIMINARIES
Lifecycle	CONCEPT DESIGN
Suitability	S2 FOR INFORMATION
Title	BUS STOP RELOCATION HOLBORN STATION (STOP K) - CAM0154AB SHEET 3 OF 3

Prepared by:	metisconsultants.co.uk
Prepared for:	
Drawing Number	22271-METCS-011-02_01-DRG-CE-003
Rev.	P01