

- Key:**
- Biodiverse roof areas
 - Habitat piles (logs, rocks, sand, manila rope & deadwood)
 - Intensive planting areas on commercial building roof terraces, levels 04 & 05
 - Perimeter planting on commercial building roof terraces, levels 04, 05 & 06

HB1: Schwegler Sparrow Terrace bird box
 - Target species: Sparrows
 External dimensions:
 W 43 x H 24.5 x D 20 cm.
 Weight: approx. 15 kg.
 - Material: Woodcrete
 - Fixing detail: Affixed to metal mesh facade using ISP (screws and plugs), refer to detail provided.

Product image:



Facade fixing detail:

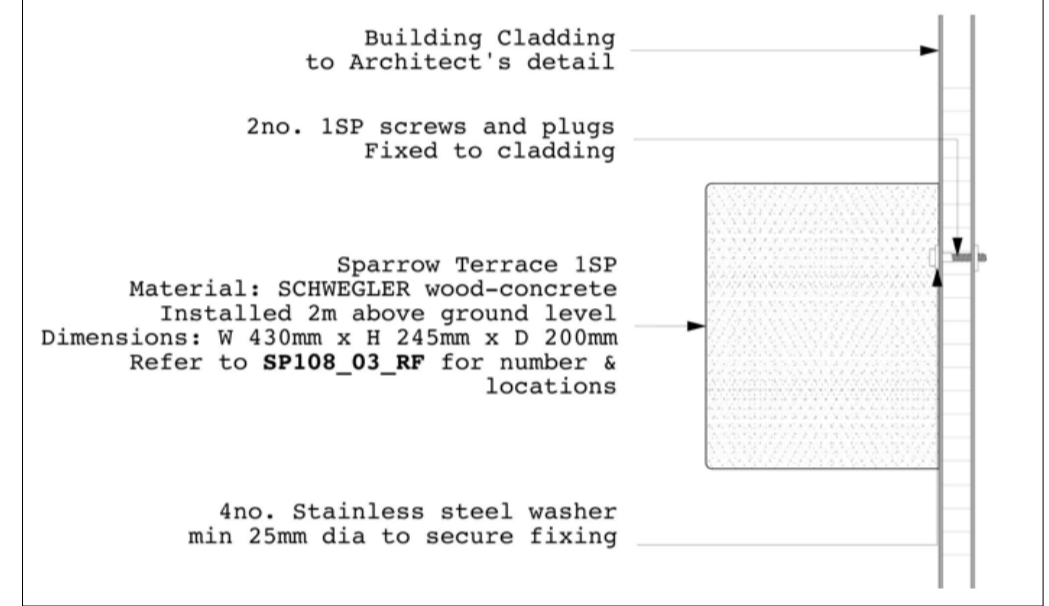

HB2: Schwegler Nest box 1B woodcrete
 - Target species: Great, Blue, Marsh, Coal and Crested Tits, Redstarts, Nuthatches, Collard and Pied Flycatchers, Tree and House Sparrows
 - Opening: 32mm diameter hole
 External Dimensions: W17 x H26xD18 cm.
 Internal Diameter: 12 cm.
 Weight: approx. 3.6 kg.
 - Material: Woodcrete
 - Fixing detail: Affixed to large new semi-mature trees in central landscape spaces using adjustable, tree-friendly ties.

Product image:



HB3: Insect habitat - Bee block
 - Target species: Solitary bees
 - External dimensions:
 - Material: Concrete with granite aggregates
 - Located in quiet corners of planting areas on terraces at levels 4/5
 - Placed directly on to soft landscape and nestled within planting areas.

Product image:

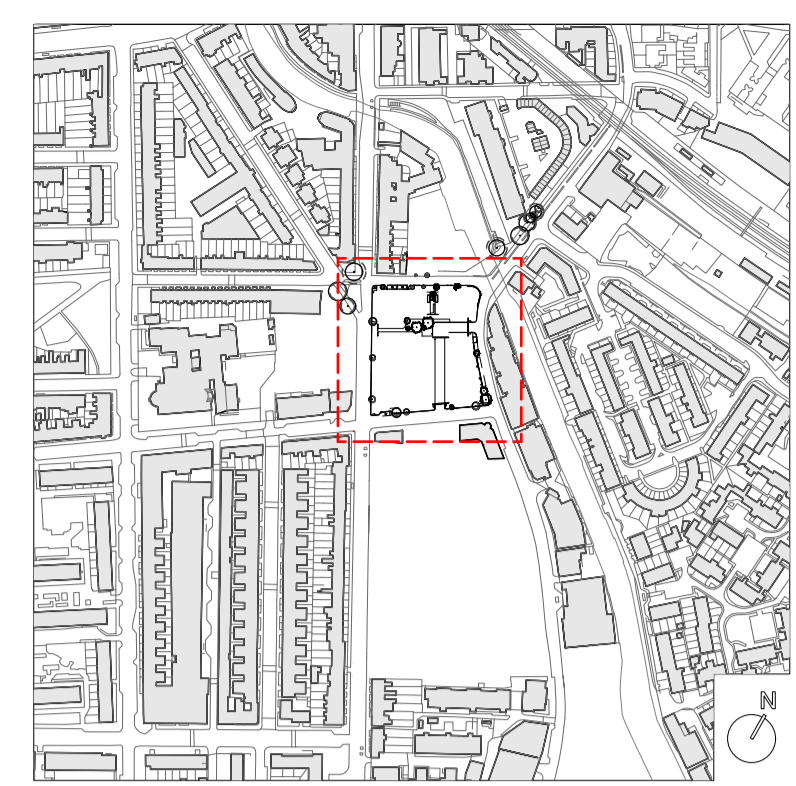

© JCLA
 Do not scale from this drawing. Any discrepancies or queries should be brought to the attention of the authors. Dimensions are to be verified on site prior to construction.
 To be read in conjunction with all relevant Architects', Services and Structural Engineers' drawings.
 All existing site, tree and building information has been compiled from different sources.
 Refer to current revisions of all referenced files.

Notes:
 - This drawing contains information relevant to discharge planning condition 20 only
 - Refer to other consented drawings where relevant

Rev	Date	Description
P1	16.03.23	Issued for planning condition discharge

JCLA
 Jonathan Cook Landscape Architects Ltd
 3A Iliffe Yard
 LONDON SE17 3QA
 Tel +44 (0)207 703 3270
 www.jcla.co.uk

Client W.RE	
Project SP108: St Pancras Commercial centre	
Drawing Title Proposed plan: Habitat boxes (Condition 20)	
Drawing Number SP108-100-HB	
Date 16.03.23	Revision P1
Scale (0 A1) 1:200	Drawing Status For information