

Existing Drawings

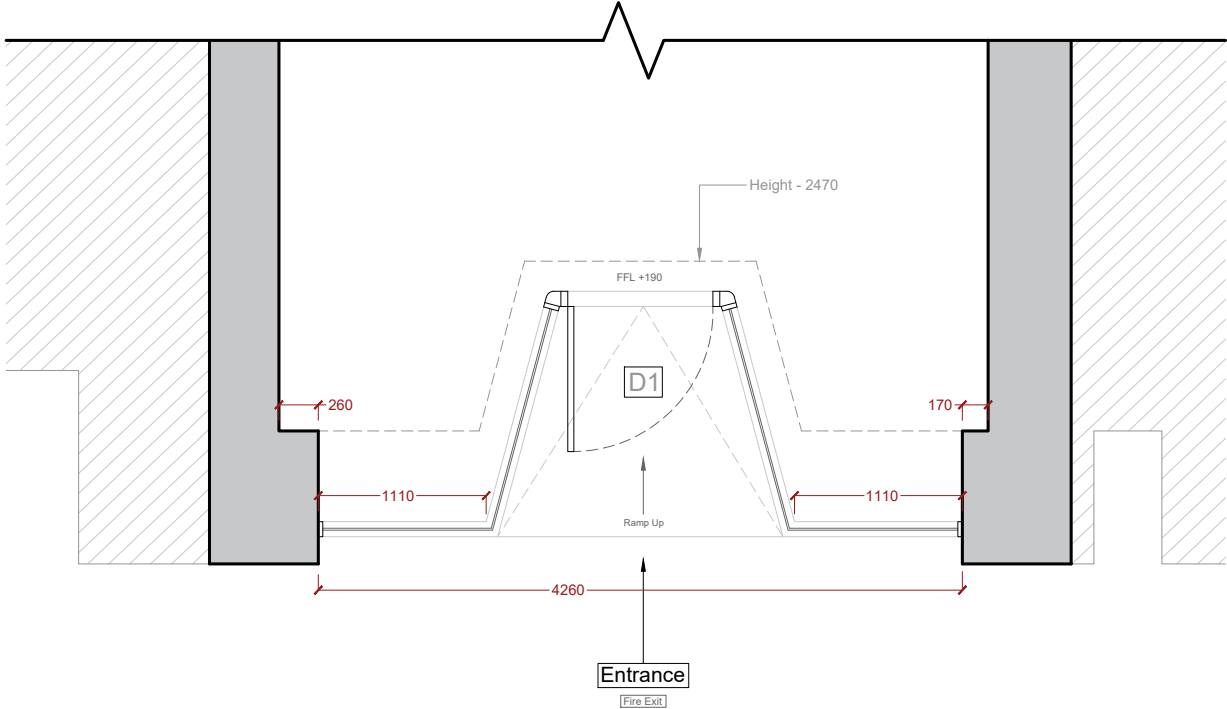

Proposed Drawings

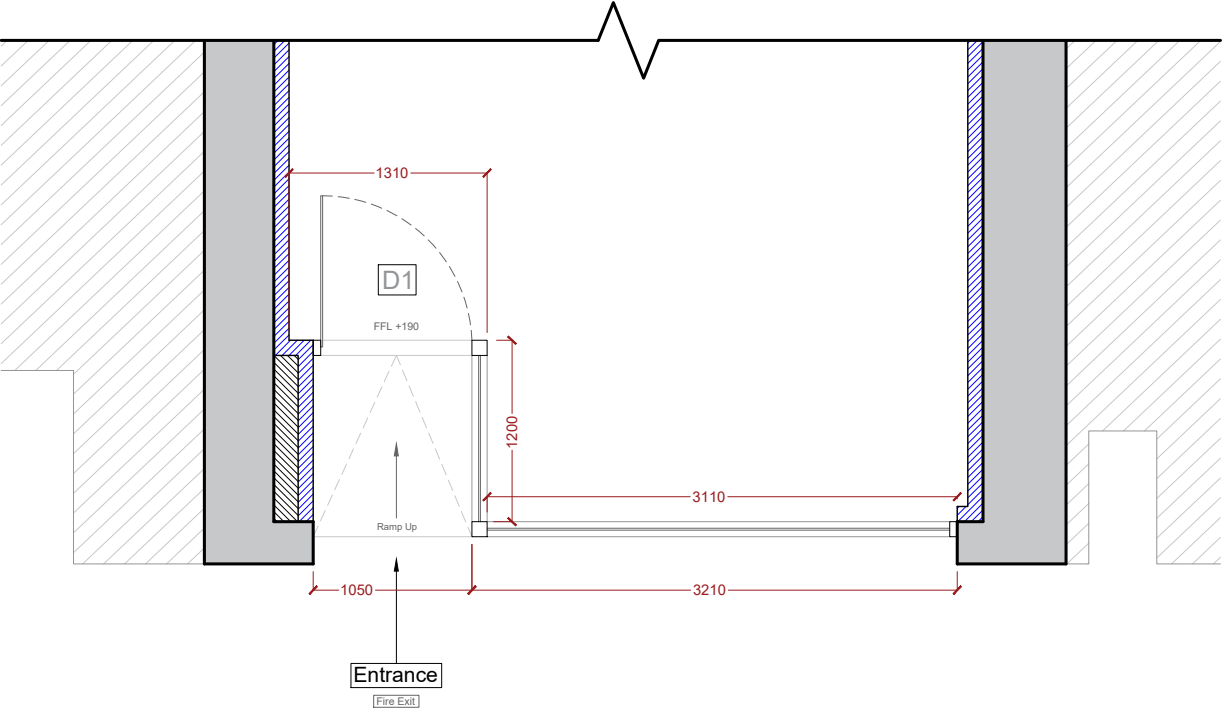

'Chaiiwala' Fascia Sign  
Folded 3mm Aluminium Panel, 70mm Deep, Coated in RAL 9005 Black Satin.  
Folded 3mm Aluminium Backtray to Suit Coated RAL 9005 Black Satin Externally, 60mm x 160mm (70mm Deep Overall)  
Panel Mounted Built Up Rimless Letters to Read "Chaiiwala". Coated RAL 9005 Black Satin, 5mm Opal 050 Acrylic Faces and 10mm White Formex Backtrays  
LED's do not Exceed 400cd/m² (Static Illumination)



Fascia Board Sign Light

'Chaiiwala' Projection Sign  
Fabricated Projection Sign Consisting of Fabricated 2mm Shaped Rim/Return Aluminium Panels - 1200mm x 400mm (70mm Deep Overall)  
Coated RAL 9005 Black Satin, 5mm Opal Acrylic Faces with Vinyl Decorations Applied (Black Background with White Vinyl Graphics to be Lit Internally)  
LED's do not Exceed 400cd/m² (Static Illumination)  
Completed with Brackets Coated RAL 9005 Black Satin

Black Fascia Cladding to Match Signage Board

Fascia Section

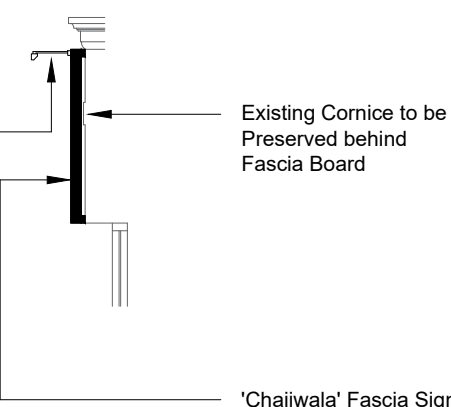

Proposed Signage  
Scale 1:50 @ A2

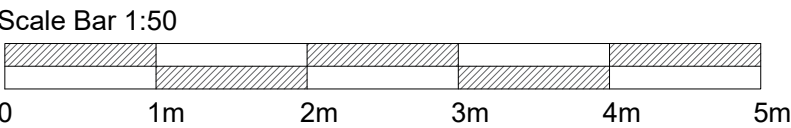

Drawn	SP
Date	03/2023
Client	Chaiiwala
Project	Design and Fit Out
Site Address	
72 Southampton Row Bloomsbury, London WC1B 4AR	
Ref	P-E-01
Sheet	A2-01
Scale	1:50 @ A2



