

Copyright: All rights reserved. This drawing must not be reproduced without permission.

Only the original drawing should be relied upon. Contractors, sub-contractors and suppliers must verify all dimensions on site before commencing any work or making any shop drawings.

All shop drawings to be submitted to the architect / interior designer for comment prior to fabrication.

This drawing is to be read in conjunction with the architect's / interior designer's specification, bills of quantities / schedules, structural, mechanical & electrical drawings and all discrepancies are to be reported to the architect / interior designer.

Do not scale from this drawing. Dimensions are in millimetres unless otherwise stated.

NOTES

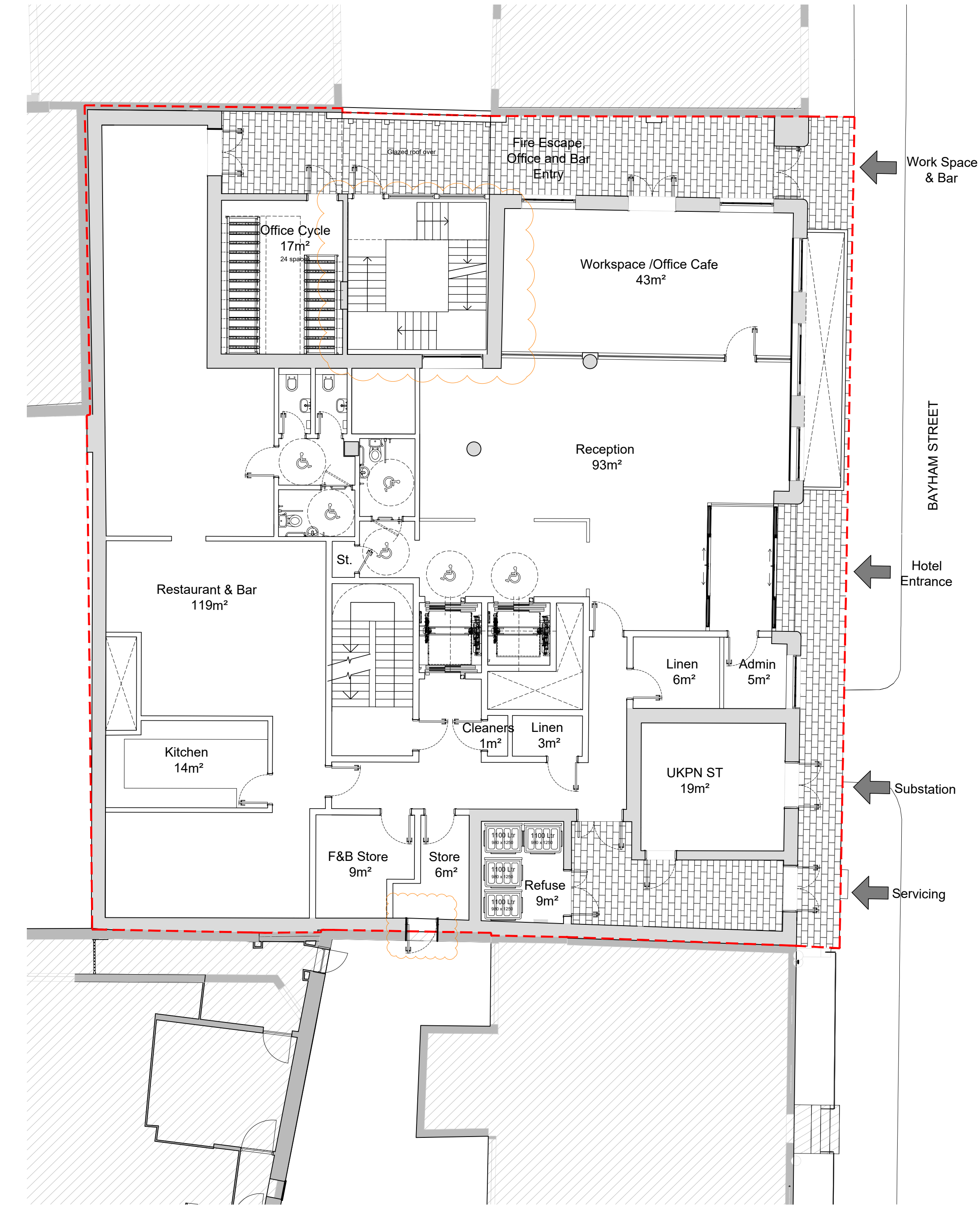

Proposed Ground Floor
1:100

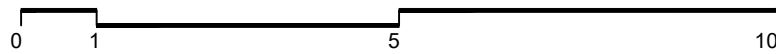

P4	SIGA, Party Walls and External Stairs amended	17.05.22	JC3	PW
P3	BCR areas reconfigured, updates to glazing	12.05.21	PW	FJ
P2	Canopy added and stair reconfigured, access to cafe updated	15.04.21	FJ	PW
P1	Updated following objections to substation location	15.03.21	PW	FJ
P0	ISSUED FOR PLANNING	20.11.20	FJ	PW

rev	amendments	date	by	chk
-----	------------	------	----	-----

**dexter
moren
associates**

architecture urban design
interior design creative media
www.dextermoren.com
dmaj@dextermoren.com

57d
jamestown road
london nw1 7db
UK

t: 020 7267 4440

architecture

project
Bayham Street
London, NW1 0EY

client
Camden Lifestyle (UK) Ltd

drawing title
Proposed Ground Floor

drawing status
PLANNING

scale	date	drawn by
1:100 @ A1	20.11.20	FJ
1:200 @ A3		
job no.	drawing no.	revision
1783	A-100-100	P4